

Oakland Bicycle and Advisory Committee, Monthly Meeting
Minutes of February 16, 2012

Meeting attendees: Adrian Leung, Aksel Olsen, Brian Toy, Carol Levine, Chris Hwang, Daniel Schulman, Darian Avelino, Dave Campbell, Eric Uddenberg, Iris Starr, Jason Patton, Jennifer Stanley, Kelly Cha, Liza Pratt, Midori Tabata, Nathan Landau, Rebecca Saltzman, Robert Prinz, Ryan Chan

Item	Discussion/Decisions/Action Items
1. Introductions, appointment of note taker	Chair, Chris Hwang, called the meeting to order at 5:35 p.m. Midori Tabata agreed to take notes.
2. Approval of meeting minutes	Minutes of January 2012 meeting were approved by consensus.
3. AC Transit Network Structure	Nathan Landau, AC Transit planner discussed the AC Transit network in Oakland and how it is structured. He shared a detailed map of all day routes. He noted that the cities of Alameda and Emeryville have a transit plan and that it would be ideal if Oakland had one as well. He said it would be ideal if that transit plan could be integrated with the bicycle plan. He stressed that the City's area plans should treat bus/surface transit--both as it exists today and as it could develop in the future-- as a key element of mobility for residents and workers in the area. He said that during budget cuts, they tried to protect the trunk lines, which is where 45% of all boardings occur. He also said that with transit planning, the mode of transit, such as shuttles, would be the end result, not the goal. It was suggested that we have another discussion about buses and bicycles coexisting. Nathan agreed that would be useful. Staff will schedule this discussion on a future agenda.
4. BPAC Chair and Vice-Chair nominations	Chris Hwang was nominated for another term as chair. Rebecca Saltzman was nominated for another term as vice-chair. Nominations are open until March 8. Please submit them to Jennifer Stanley at jstanley@oaklandnet.com . Elections will be held on March 15, 2012.
5. Refined list of projects for FY 2012-13 TDA Article 3 Bike/Ped funding	Jason Patton presented the committee with a refined list of projects for the Transportation Development Act (TDA) Article 3 Bike/Ped funding for FY 2012-13. This is a continuation of the discussion from our meeting in January. The current staff recommendations (as detailed in minutes attachment) are: (1) continue to fund the CityRacks program; (2) purchase new drainage grates (~\$500/ea) and replace bike-unsafe grates during routine maintenance. Crews will bring the unsafe grates back to the shop for retrofit after which they can be redeployed during routine maintenance; this is much more efficient than the current practice of retrofitting grates in the field. (3) fund high-priority stairways. Eric Uddenberg from the Department of Engineering and Construction, stated that all retrofitted stairway projects will include signage.

	<p>(4) fund a shortfall in the Measure DD Snow Park project. This may add 1800 sq ft to the park and present the City an opportunity create a gateway to the park.</p> <p>The committee was in agreement with the refined list. Jason will present the final list to the committee at our March meeting. Then it will go to the Council for approval in May.</p>
6. In-street bike parking draft designs	<p>Jennifer Stanley presented draft designs for in-street bike parking. The Bicycle and Pedestrian Facilities staff strategy is to make this work well with as little controversy as possible. Make it wildly successful so that people will be breaking down the doors for more. To that end, the initial parking pilot will be placed in areas with demand and red curb zones. No existing auto parking will be eliminated. Safety for all is important. Intervention such as wheel stops will be introduced as necessary for safety. Jennifer presented 3 locations for the initial trial: 3250 Lakeshore Ave in the Grand/Lake Commercial District , 4721 Telegraph Ave. In the Temescal Business District, and 468 3rd St. in the JLS area. These locations are tentative subject to discussions with the business owner(s)/relevant business improvement districts. Staff is open to further location suggestions.</p>
7. Broadway Bikeway, 38 th St. to Broadway Terrace draft design review	<p>Darian Avelino of Transportation Services Division was on hand to discuss this project, part of the Broadway repaving project. Jason noted that this is being coordinated with the Safeway project at Pleasant Valley and will be a significant improvement for cyclists.</p>
8. Announcements, suggestions for next meeting topics	<p>Darian stated that community outreach meeting notices for 35th Ave. project have gone out. He will inform the BPAC of the details. Iris Starr noted the excellent work by the Bicycle/Pedestrian Facilities staff. Jason has been working with the Public Works staff to develop criteria for prioritizing pothole repairs that are especially dangerous to cyclists.</p>
9. Adjournment	<p>The meeting was adjourned at 7:26 p.m.</p>

Attachments (hand outs)

- AC Transit Map: All Day Routes Serving Oakland
- Pedestrian Paths and Stairways Survey maps
- Bike parking corral diagrams and details for pilot locations
- Draft Broadway striping plans

AC Transit All Day Routes Serving Oakland - Mid-Day Frequency

(December, 2011 Route System)

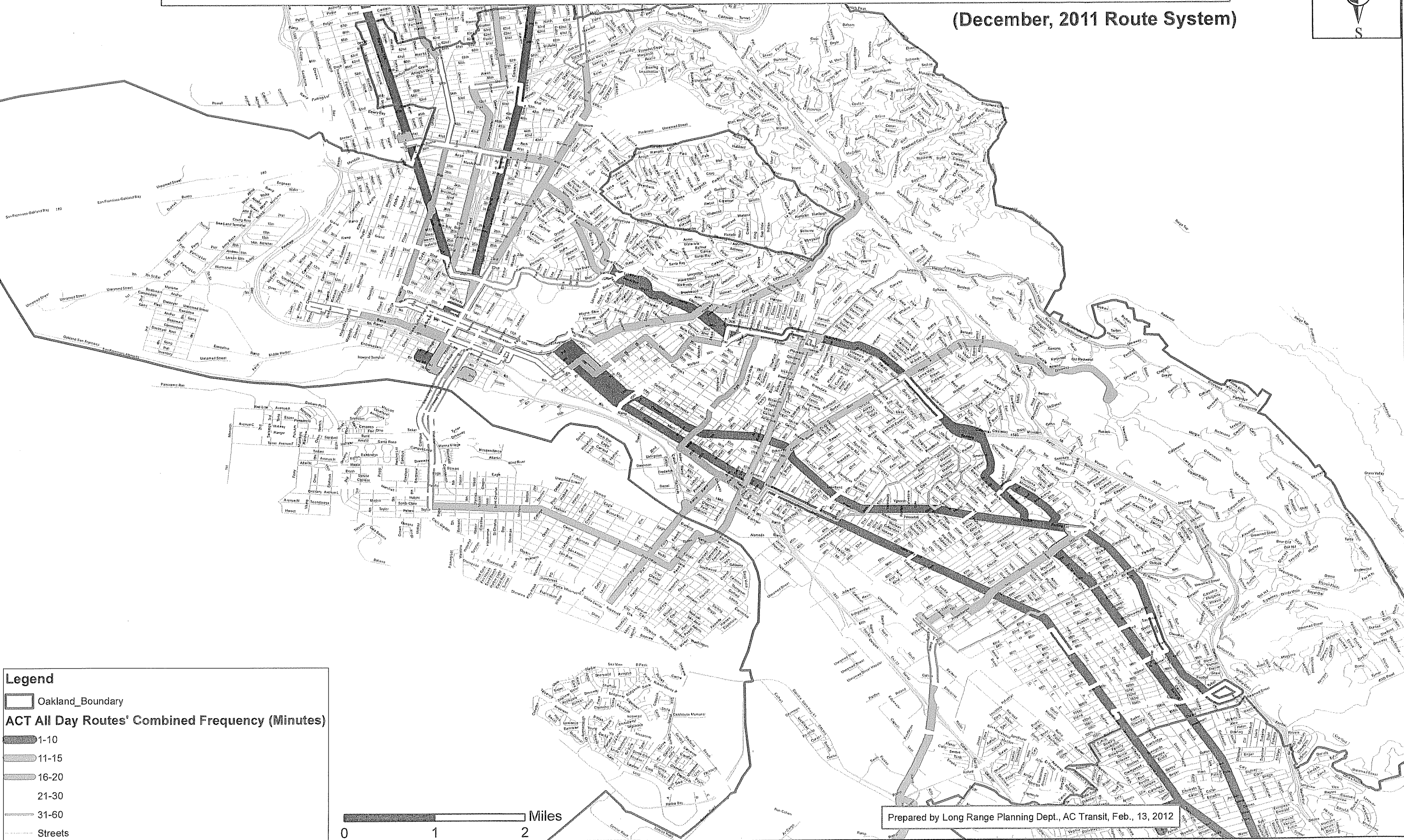
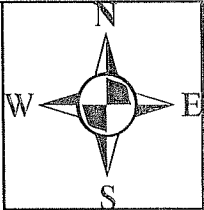

Legend

□ Oakland_Boundary

ACT All Day Routes' Combined Frequency (Minutes)

1-10

11-15

16-20

21-30

31-60

Streets



PEDESTRIAN PATHS & STAIRWAYS SURVEY

0 500 1,000
Feet

★ 125 Ped/Paths 1959 List

23 Ped/Paths 2002 Survey

2301 Parcels

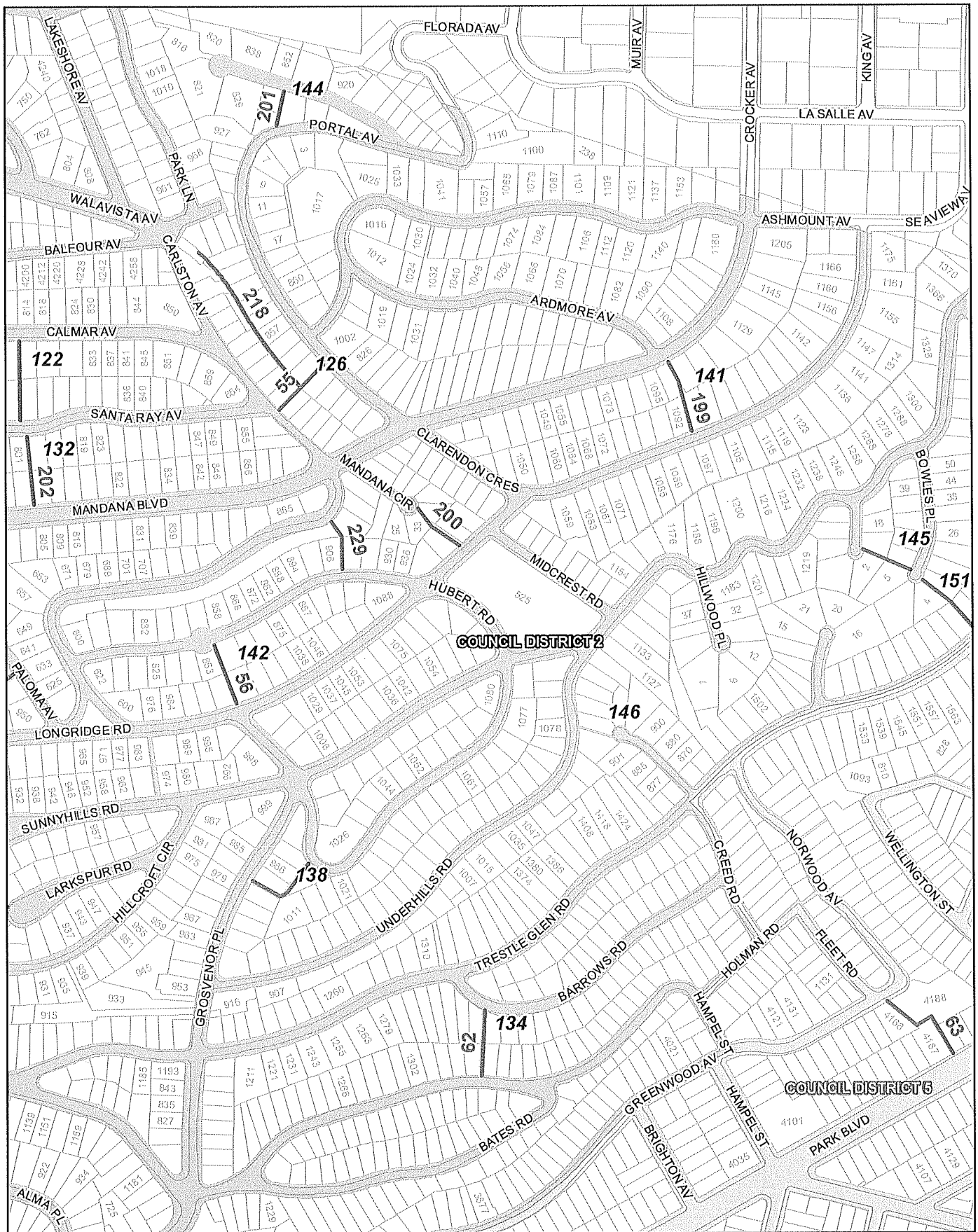

PEDESTRIAN PATHS & STAIRWAYS SURVEY

0 400 800 Feet

125 Ped/Paths 1959 List

23 Ped/Paths 2002 Survey
2301 Parcels

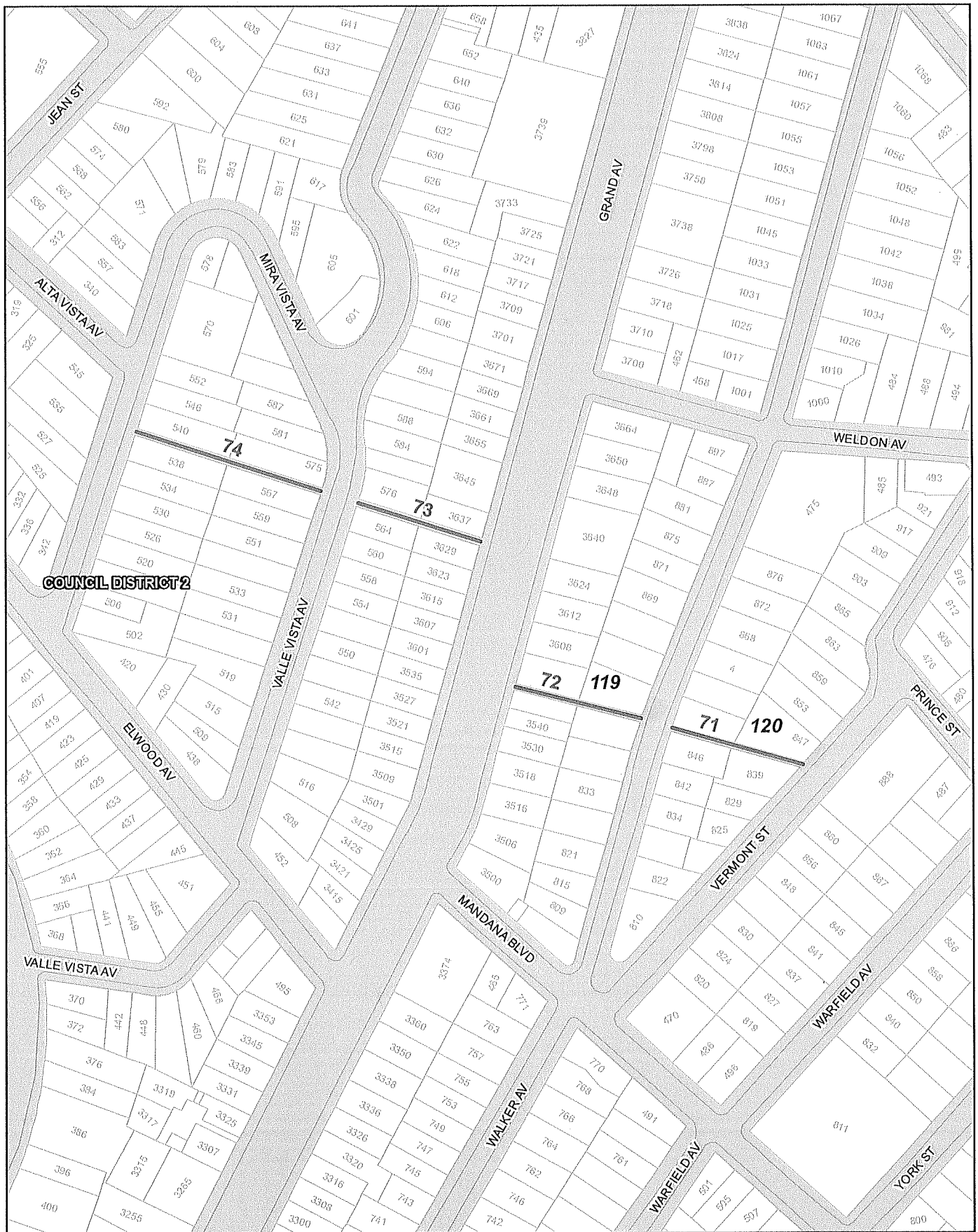

PEDESTRIAN PATHS & STAIRWAYS SURVEY

0 200 400 Feet

125 Ped/Paths 1959 List

23 Ped/Paths 2002 Survey

2301 Parcels



PEDESTRIAN PATHS & STAIRWAYS SURVEY

0 300 600 Feet

★ 125 Ped/Paths 1959 List

23 Ped/Paths 2002 Survey

2301 Parcels

4721 Telegraph Ave, Temescal Business District: Bike Parking Corral Block Diagram

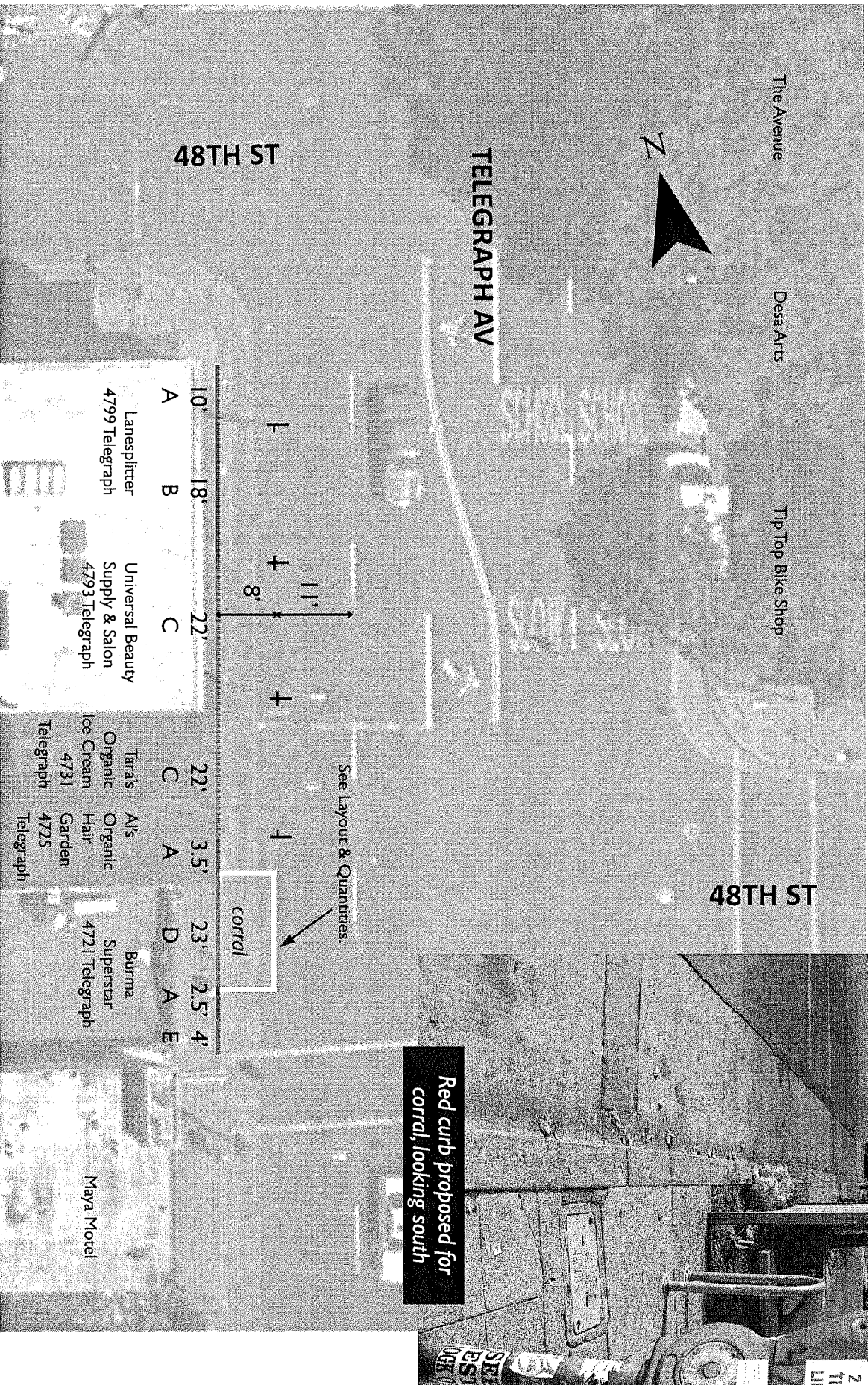

A: existing red curb; B: existing 18' disabled parking stall; C: 22' parking stall (reduced from 23'); D: 23' bike parking corral; E: edge of corral to crosswalk

NOT TO SCALE
DRAFT

4721 Telegraph Ave, Temescal Business District: Bike Parking Corral (14 bicycles) Layout & Quantities

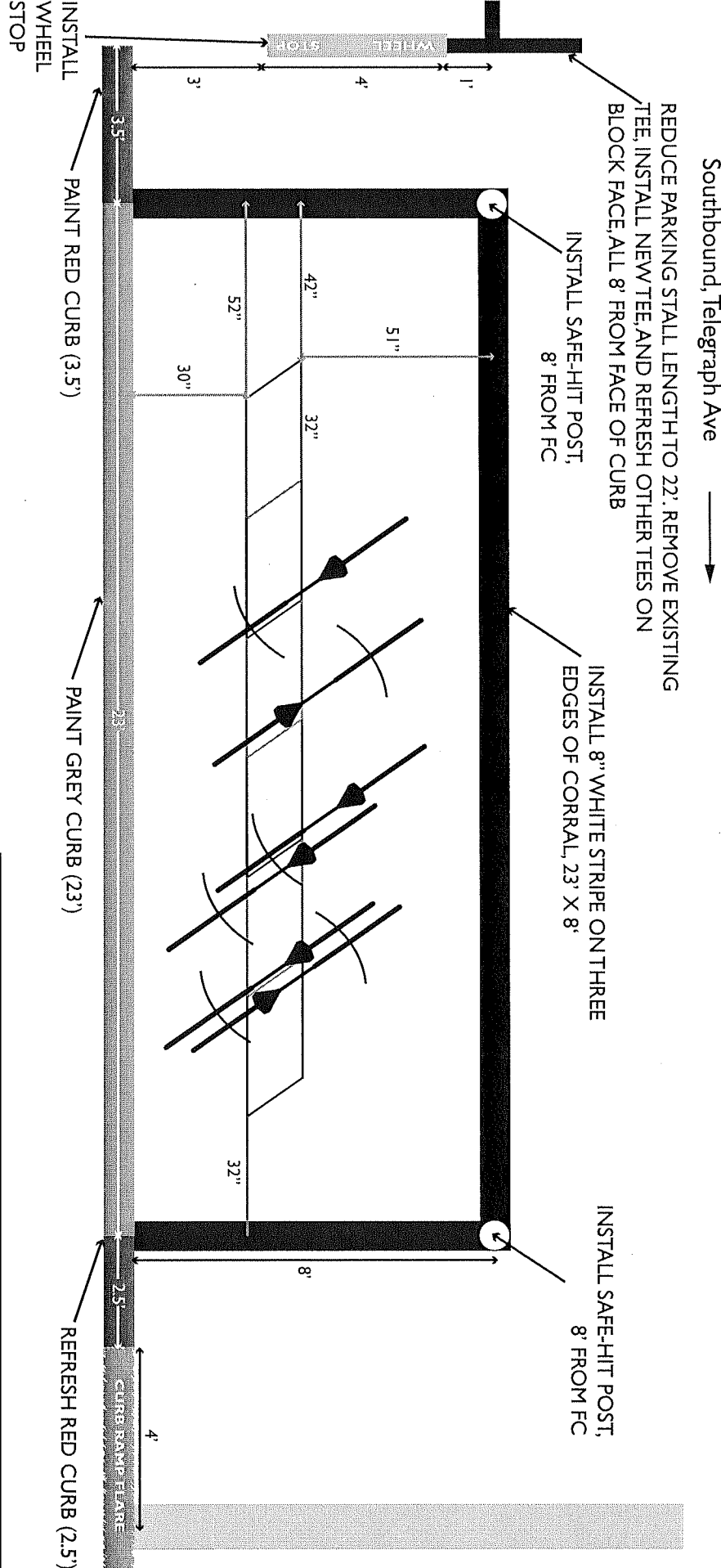

DRAFT

QUANTITY SUMMARY		
ITEM	UOM	QTY
Galvanized square tube U racks, 3-loop	EA	1
Galvanized square tube U racks, 2-loop	EA	2
8" white stripe	LF	39
Parking Tees	EA	4
Grey curb paint	LF	23
Red curb paint	LF	6
4' wheel stop	EA	1
4' safe hit post	EA	1

468 3rd St, Jack London Square: Bike Parking Corral Block Diagram

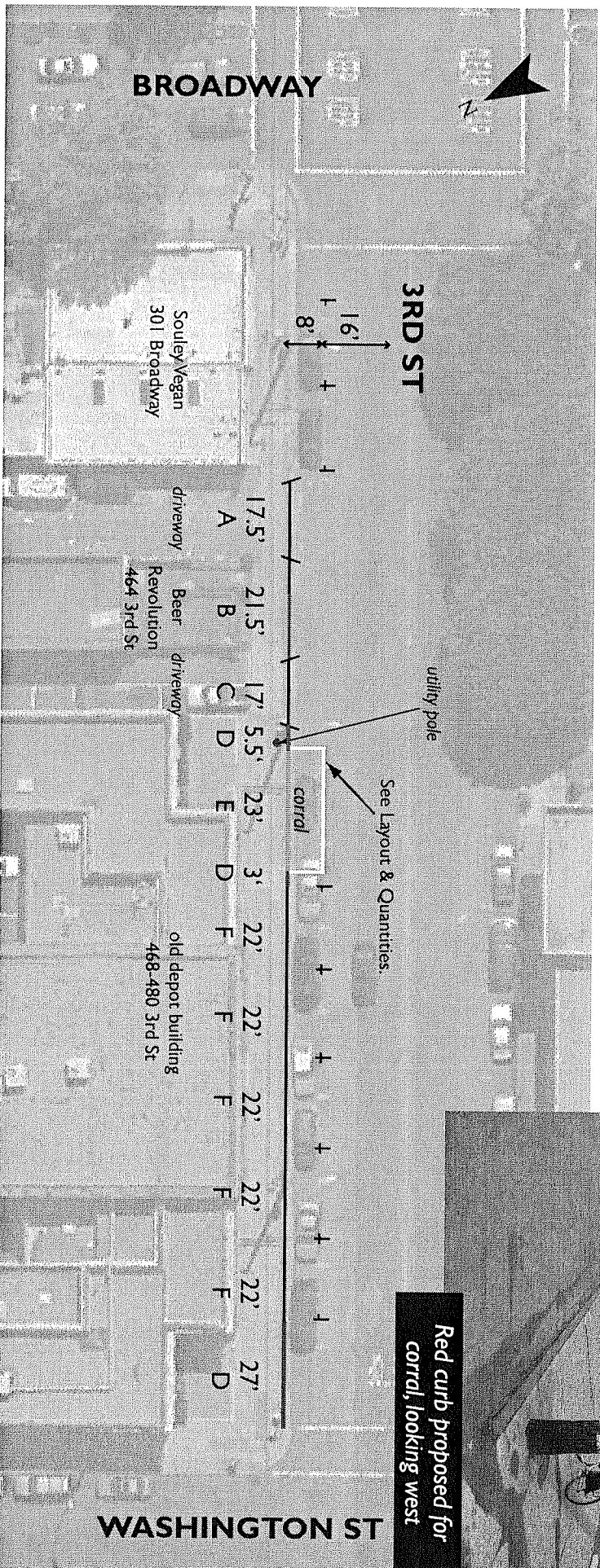

A: driveway; B: Beer Revolution frontage (non-standard, includes part of driveway and 15.5' of red curb; C: driveway; D: existing red curb; E: 23' bike parking corral; F: 22' parking stalls (reduced from 24')

NOT TO SCALE

Note: Aerial image does not reflect current traffic striping (northbound left turn pocket from 3rd St onto Broadway) or location of parking Tees.

DRAFT

overflow bike parking in front of Beer Revolution and old depot building, spring/summer 2011

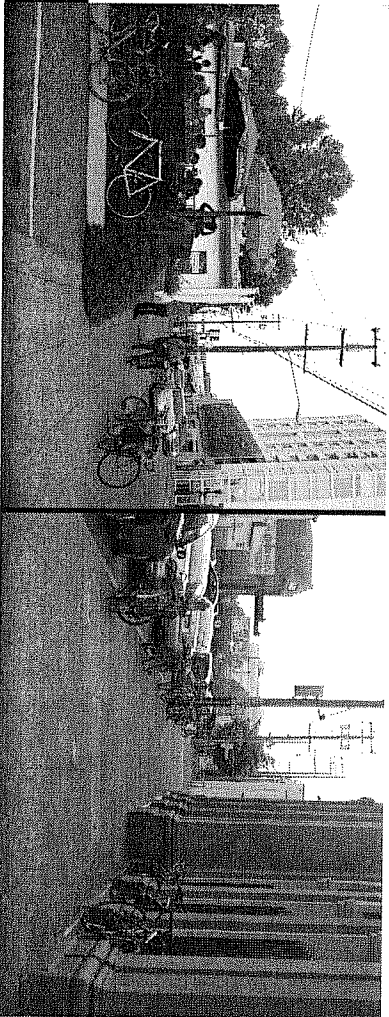

468 3rd St, Jack London Square: Bike Parking Corral (20 bicycles)

Layout & Quantities

Westbound, 3rd St →

REDUCE LENGTH OF THE FIVE (5) PARKING STALLS WEST OF CORRAL TO WASHINGTON ST TO 22'. REMOVE EXISTING TEES, INSTALL NEW TEES, AND REFRESH OTHER TEES (EAST OF CORRAL) ALL 8' FROM FACE OF CURB

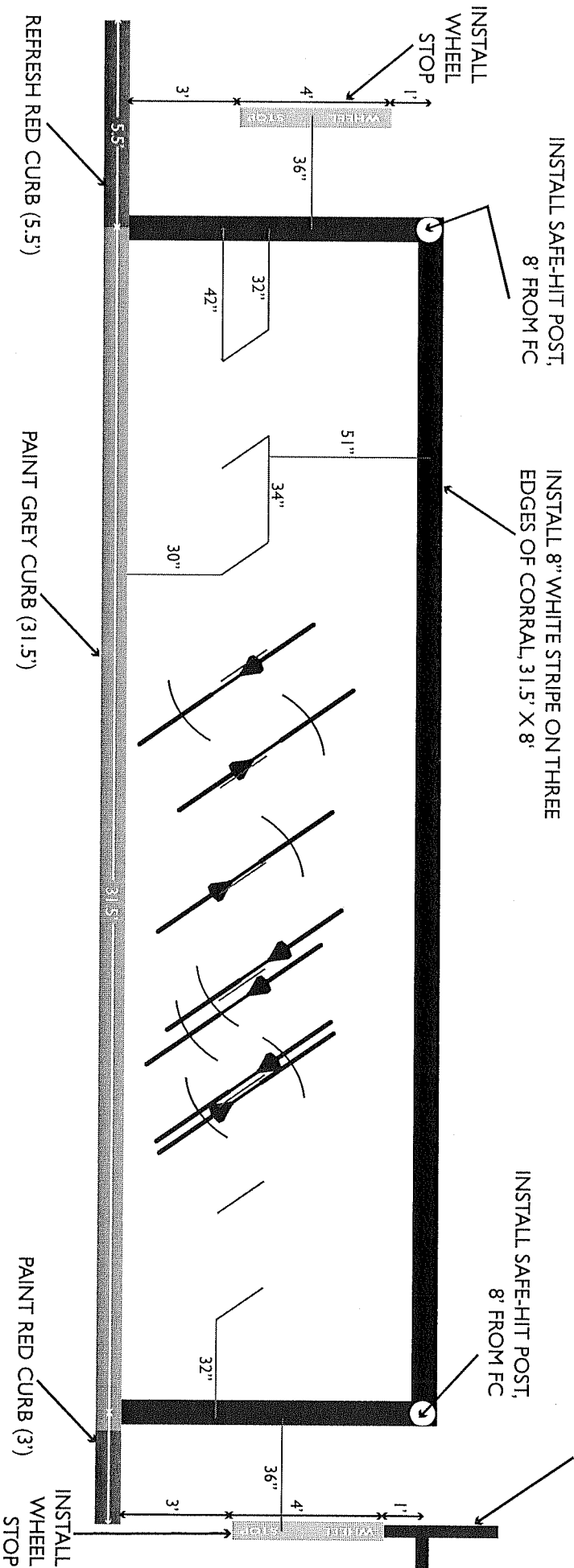

QUANTITY SUMMARY

ITEM	UOM	QTY
Galvanized square tube U racks, 3-loop	EA	2
Galvanized square tube U racks, 2-loop	EA	2
8" white stripe	LF	47.5
Parking Tees	EA	9
Grey curb paint	LF	31.5
Red curb paint	LF	11.5
4' wheel stop	EA	2
4' safe hit post	EA	2

DRAFT

IOAKLAND

www.oaklandbikes.info

Public Works Agency

3250 Lakeshore Ave, Grand/Lake Commercial District: Bike Parking Corral Block Diagram



NOT TO SCALE

DRAFT

3250 Lakeshore Ave, Grand/Lake Commercial District: Bike Parking Corral (16 bicycles)
Layout & Quantities

Eastbound, Lakeshore Ave →

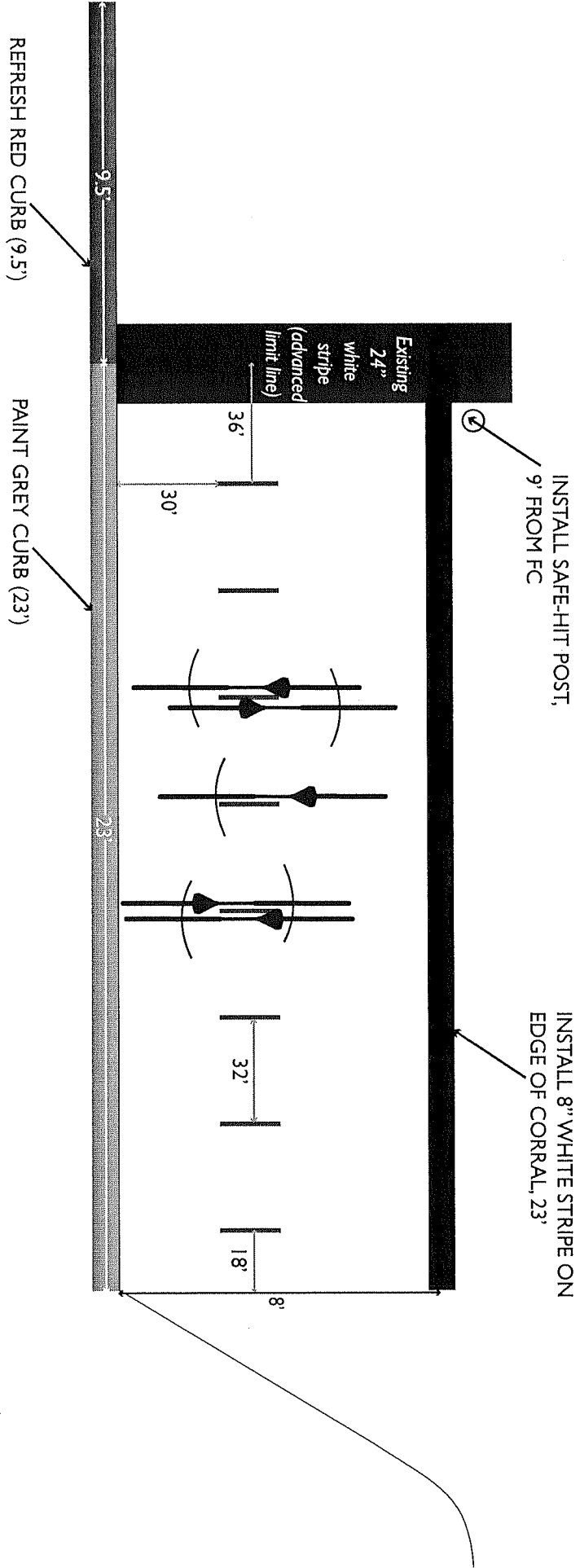

QUANTITY SUMMARY

ITEM	UOM	QTY
Galvanized square tube U racks, 4-loop	EA	2
8" white stripe	LF	23
Grey curb paint	LF	23
Red curb paint	LF	9.5
4' safe hit post	EA	1

DRAFT

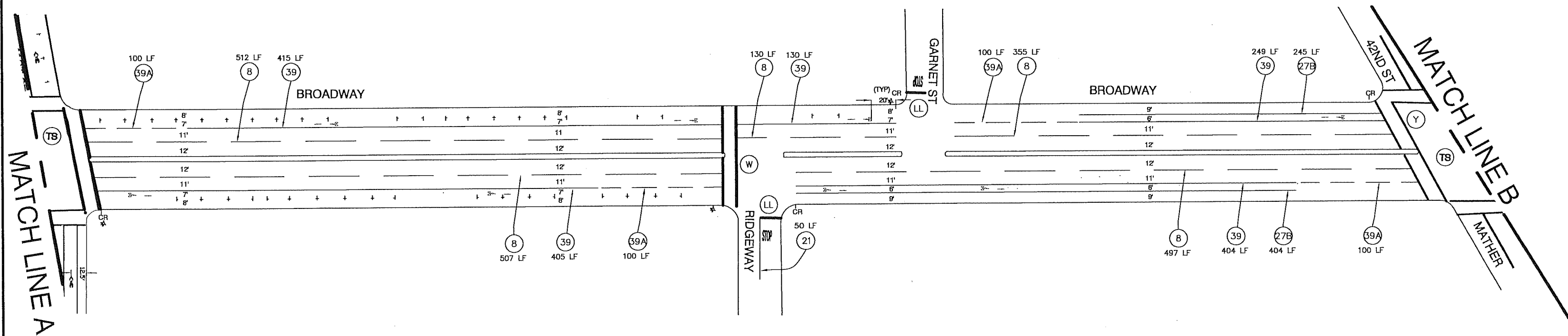
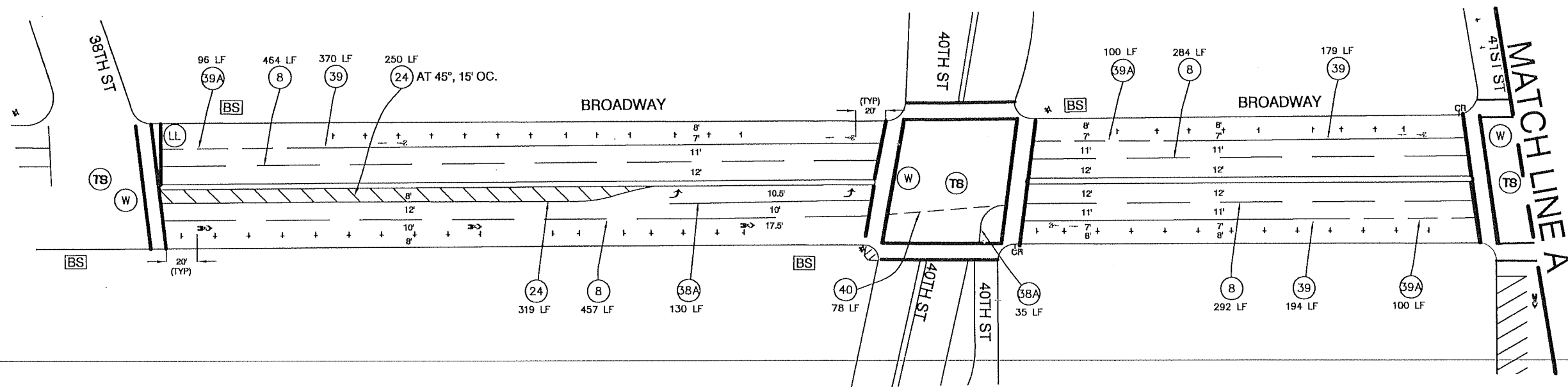

DRAFT



VARIOUS STREETS RESURFACING
AND BIKEWAY FACILITIES



CITY OF OAKLAND
DEPARTMENT OF ENGINEERING AND CONSTRUCTION SERVICES
250 FRANK OGAWA PLAZA, SUITE 4314 • OAKLAND, CA 94612
(510) 238-3437 • FAX (510) 238-7227
PROJECT NO. G427410

	No.	DATE	BY	REFERENCE
CHECKED BY				
DESIGNED BY				
DRAWN BY				

BROADWAY
STRIPING PLANS
38TH ST TO BROADWAY TERRACE

S-01

SCALE: 1"=40'
HOR.
VERT.
DATE: JUNE 30, 2012
SHEET NO.
24 OF 40

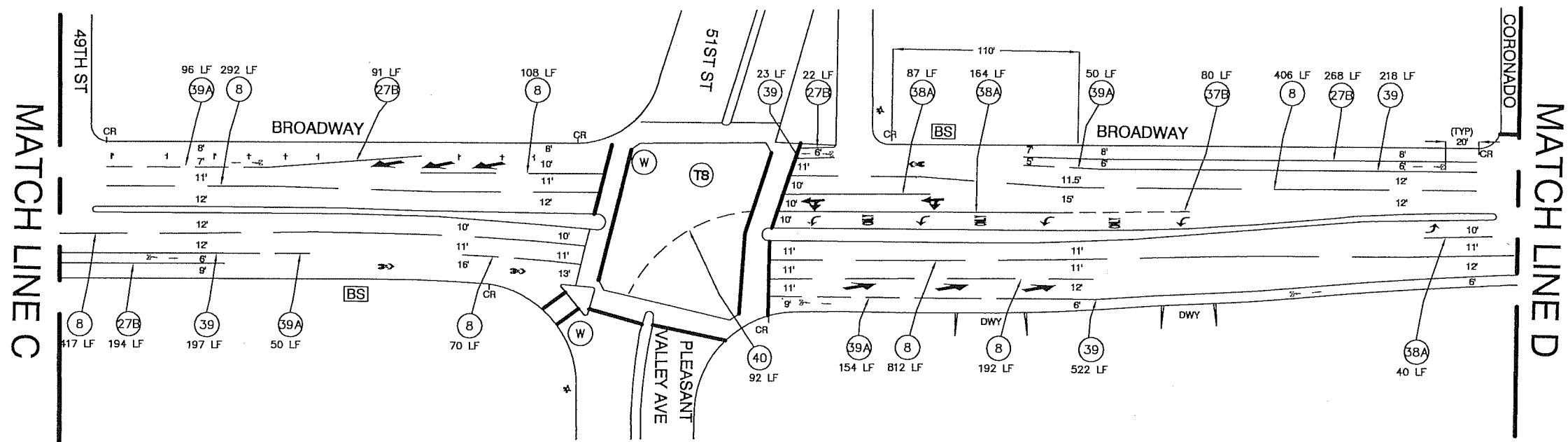
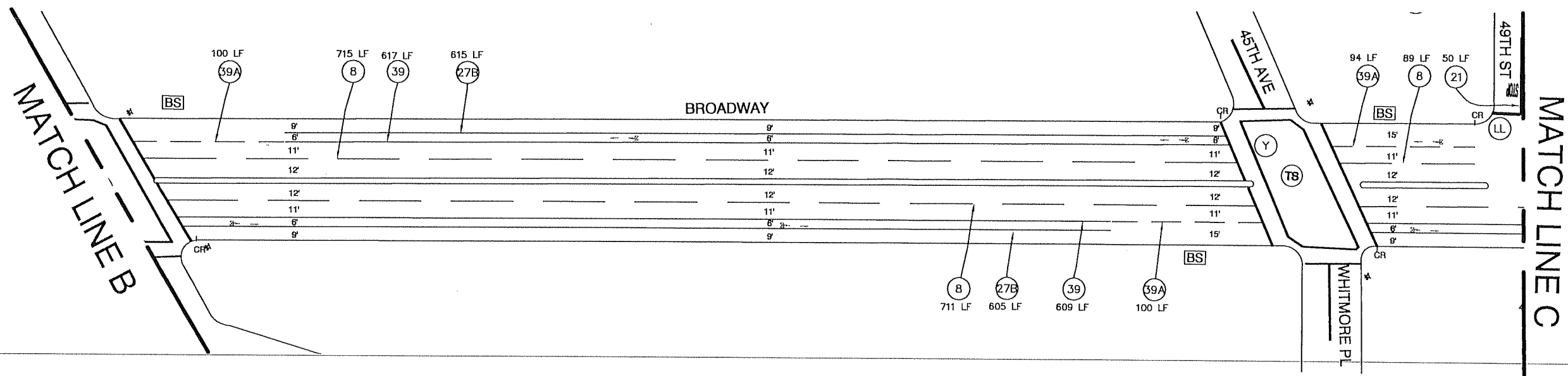

DRAFT

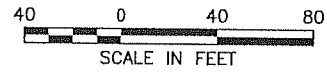

VARIOUS STREETS RESURFACING AND BIKEWAY FACILITIES	CITY OF OAKLAND DEPARTMENT OF ENGINEERING AND CONSTRUCTION SERVICES 250 FRANK OGAWA PLAZA, SUITE 4314 • OAKLAND, CA 94612 (510) 238-3437 • FAX (510) 238-7227 PROJECT NO. G427410	No.	DATE	BY	REFERENCE	BROADWAY STRIPING PLANS 38TH ST TO BROADWAY TERRACE	S-02	SCALE: 1"=40' HOR. VERT.	
		CHECKED BY	DARIAN AVELINO						DATE: JUNE 30, 2012
		DESIGNED BY	DARIAN AVELINO						SHEET NO.
		DRAWN BY	DARIAN AVELINO						25 OF 40

Drawing Name: \\oakland\pww\Engineering\Pavement_Management\003 Projects\012 G427410 Various Streets Resurfacing and Bikeway Facilities\Drawings\012 G427410 Broadway.dwg
 Plot Date: 01-23-12
 Plotter: HP

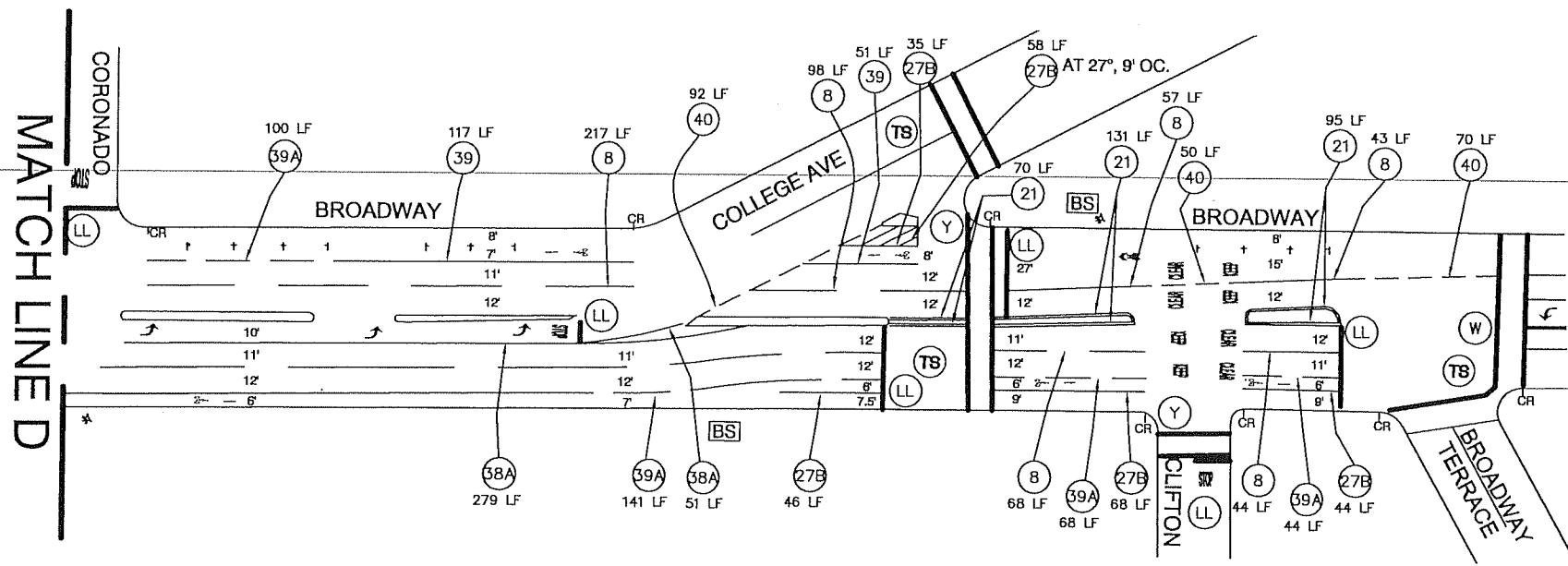

VARIOUS STREETS RESURFACING
AND BIKEWAY FACILITIES



CITY OF OAKLAND
DEPARTMENT OF ENGINEERING AND CONSTRUCTION SERVICES
250 FRANK OGAWA PLAZA, SUITE 4314 • OAKLAND, CA 94612
(510) 238-3437 • FAX (510) 238-7227
PROJECT NO. G427410

	No.	DATE	BY	REFERENCE
CHECKED BY	DARIAN AVELINO			
DESIGNED BY	DARIAN AVELINO			
DRAWN BY	DARIAN AVELINO			

BROADWAY
STRIPING PLANS
38TH ST TO BROADWAY TERRACE

S-03

SCALE: 1"=40'
HOR.
VERT.
DATE: JUNE 30, 2012
SHEET NO.
26 OF 40

DRAWING NAME: \\oakland\pwa\Engineering\Pavement_Management\03 Projects\02 G427410 Various Streets Resurfacing and Bikeway Facilities\004 Design\01-02-03-Broadway.dwg
PLOT DATE: 01-23-12
PLOTTER: dv