

**GENERAL NOTES:**

- FOR NOTES, LEGEND AND ABBREVIATIONS SEE SHEET GN-02.
- FOR DEMOLITION, LAYOUT, AND GRADING DRAWING NUMBERS AT THIS LOCATIONS, SEE SHEET T-01, INDEX OF DRAWINGS.

- XX INSTALL STRIPING DETAIL NUMBER PER CALTRANS STD. PLANS A20A - A20E
- INSTALL ROMAN NUMERAL ARROW PAVEMENT MARKINGS PER CALTRANS STD. PLAN A24A
- 1 INSTALL 12" WHITE LIMIT LINE MARKINGS
- 8 INSTALL HIGH VISIBILITY STYLE WHITE CROSSWALK MARKINGS PER CITY DETAIL RM-4
- 11 INSTALL "KEEP CLEAR" MARKINGS PER DETAIL 2, SHEET D-07
- 12 INSTALL RAILROAD MARKINGS PER CALTRANS STD. PLAN A24B
- 13 INSTALL ADVANCE STOP MARKING PER DETAIL 3, SHEET D-07
- 19 INSTALL BLUE PAVEMENT MARKER PER DETAIL 15, SHEET D-13
- 23 INSTALL DIAGONAL PAVEMENT STRIPING, COLOR PER PLANS
- 24 INSTALL SIGN ON NEW POST PER CITY DETAIL SD-1
- 31 PROTECT IN PLACE EX. SIGN
- 43 PAINT CURB, COLOR AND LENGTH PER PLANS
- 44 INSTALL 24" WHITE LIMIT LINE MARKINGS
- 47 INSTALL FG 300 INTERSTATE GRADE CURB, LENGTH PER PLANS



THE CONTRACTOR SHALL NOTIFY UNDERGROUND SERVICE ALERT AND THE CITY PUBLIC WORKS AGENCY AT LEAST 48 HOURS (2 WORKING DAYS) PRIOR TO BEGINNING ANY EXCAVATION IN THE VICINITY OF UNDERGROUND FACILITIES.

THE CONTRACTOR SHALL MARK, COVER, PROTECT, AND REMOVE ANY MATERIAL PLACED OVER UTILITIES (ANY CITY OR PRIVATE UTILITY MANHOLE COVER/VALVE LID) PRIOR TO MILL/PAVE OPERATION.

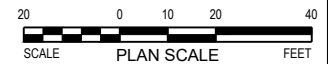

100% PLANS  
NOT FOR CONSTRUCTION



CITY OF OAKLAND  
HIGH STREET PAVING PROJECT



**CITY OF OAKLAND**  
DEPARTMENT OF TRANSPORTATION  
250 FRANK H. OGAWA PLAZA, SUITE 4314 • OAKLAND CA, 94612  
(510) 238-3437 • FAX (510) 238-7227

CIVIL ENGINEER STEVEN B. FRIESON RCE NO. C42110	NO.	DATE	BY	REFERENCE
CHECKED BY: SF				
DESIGNED BY: VH				
DRAWN BY: EK				

SIGNING AND STRIPING PLAN

PROJECT NO.  
**1005438**

SCALE: PER PLAN SCALE  
DATE: 7/5/2022

SHEET NO.  
**S-01**  
41 OF XX

DRAWING NAME: N:\Shared\PROJECTS\2020\1005438\Oakland CA Signage & Striping for 3 SAs\CAD\01\_Plan\High Street Traffic Calming\2020-004\_1\_SPA.dwg  
PLOT DATE: 10/24/22  
PLOTTED BY: ethammon

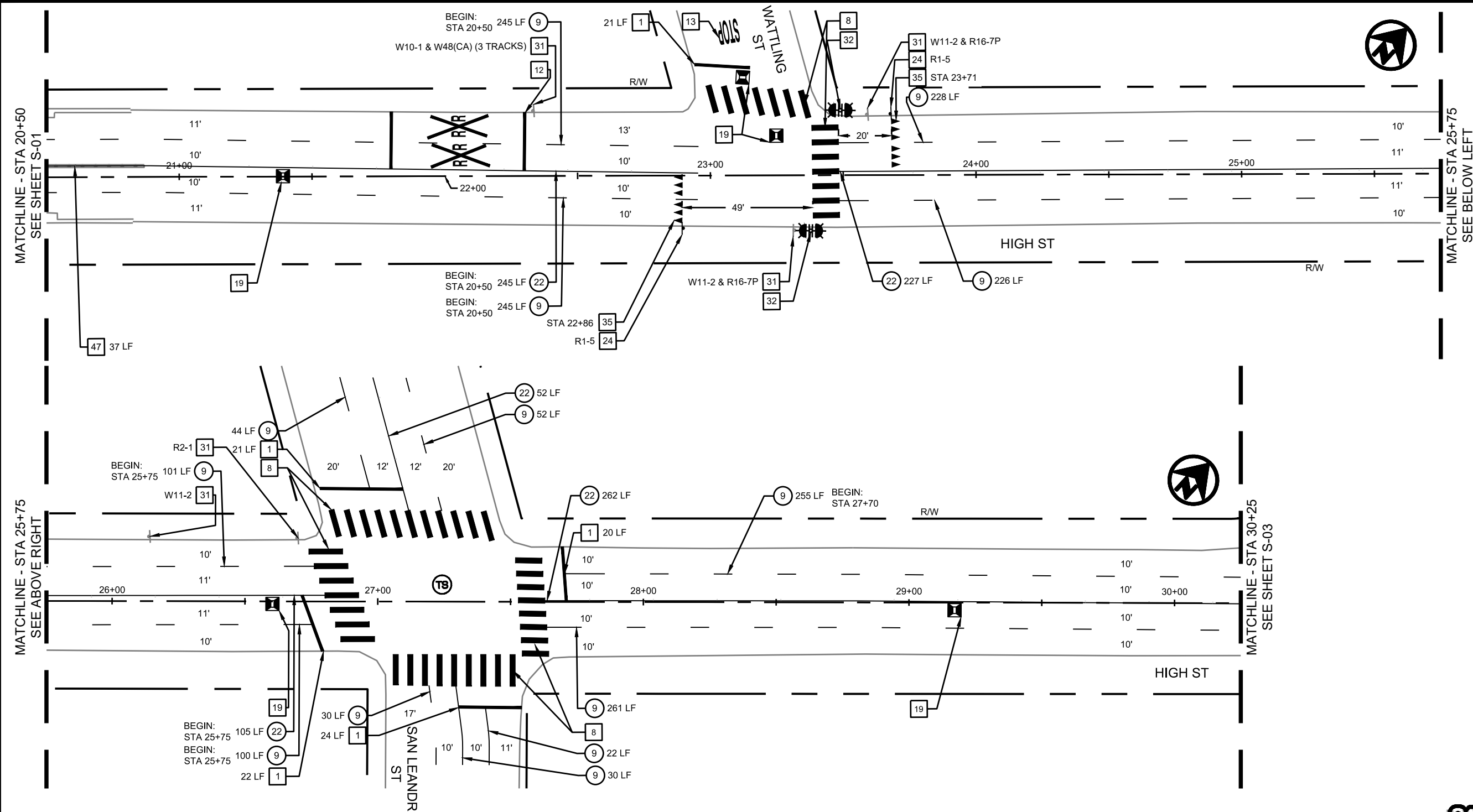

- XX INSTALL STRIPING DETAIL NUMBER PER CALTRANS STD. PLANS A20A - A20E
- INSTALL ROMAN NUMERAL ARROW PAVEMENT MARKINGS PER CALTRANS STD. PLAN A24A
- 1 INSTALL 12" WHITE LIMIT LINE MARKINGS
- 8 INSTALL HIGH VISIBILITY STYLE WHITE CROSSWALK MARKINGS PER CITY DETAIL RM-4
- 12 INSTALL RAILROAD MARKINGS PER CALTRANS STD. PLAN A24B
- 13 INSTALL ADVANCE STOP MARKING PER DETAIL 3, SHEET D-07
- 19 INSTALL BLUE PAVEMENT MARKER PER DETAIL 15, SHEET D-13
- 24 INSTALL SIGN ON NEW POST PER CITY DETAIL SD-1
- 31 PROTECT IN PLACE EX. SIGN
- 32 INSTALL SOLAR RRFB ASSEMBLY WITH PPB ON 1-B POLE PER DETAIL 7, SHEET D-08
- 35 INSTALL ADVANCE YIELD LINE PER CITY DETAIL RM-6
- 47 INSTALL FG 300 INTERSTATE GRADE CURB, LENGTH PER PLANS

**GENERAL NOTES:**

- FOR NOTES, LEGEND AND ABBREVIATIONS SEE SHEET GN-02.
- FOR DEMOLITION, LAYOUT, AND GRADING DRAWING NUMBERS AT THIS LOCATIONS, SEE SHEET T-01, INDEX OF DRAWINGS.



THE CONTRACTOR SHALL NOTIFY UNDERGROUND SERVICE ALERT AND THE CITY PUBLIC WORKS AGENCY AT LEAST 48 HOURS (2 WORKING DAYS) PRIOR TO BEGINNING ANY EXCAVATION IN THE VICINITY OF UNDERGROUND FACILITIES.

THE CONTRACTOR SHALL MARK, COVER, PROTECT, AND REMOVE ANY MATERIAL PLACED OVER UTILITIES (ANY CITY OR PRIVATE UTILITY MANHOLE COVER/VALVE LID) PRIOR TO MILL/PAVE OPERATION.

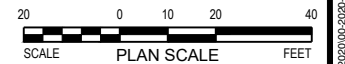

100% PLANS  
NOT FOR CONSTRUCTION



CITY OF OAKLAND  
HIGH STREET PAVING PROJECT



**CITY OF OAKLAND**  
DEPARTMENT OF TRANSPORTATION  
250 FRANK H. OGAWA PLAZA, SUITE 4314 \* OAKLAND CA, 94612  
(510) 238-3437 \* FAX (510) 238-7227

CIVIL ENGINEER STEVEN B. FRIERSON RCE NO. C42110	NO.	DATE	BY	REFERENCE
CHECKED BY: SF				
DESIGNED BY: VH				
DRAWN BY: EK				

SIGNING AND STRIPING PLAN

PROJECT NO.  
**1005438**

SCALE: PER PLAN SCALE

DATE: 7/5/2022

SHEET NO.  
**S-02**  
42 OF XX

DRAWING NAME: N:\Share\PROJECTS\2020\05\2020-204 Oakland CA Signage & Striping for 3 Sts\CAD\01\_Plan\High Street Traffic Caltrans\2020-204\_T\_SPH.dwg  
PLOT DATE: 10/24/22  
PLOT BY: ethammon

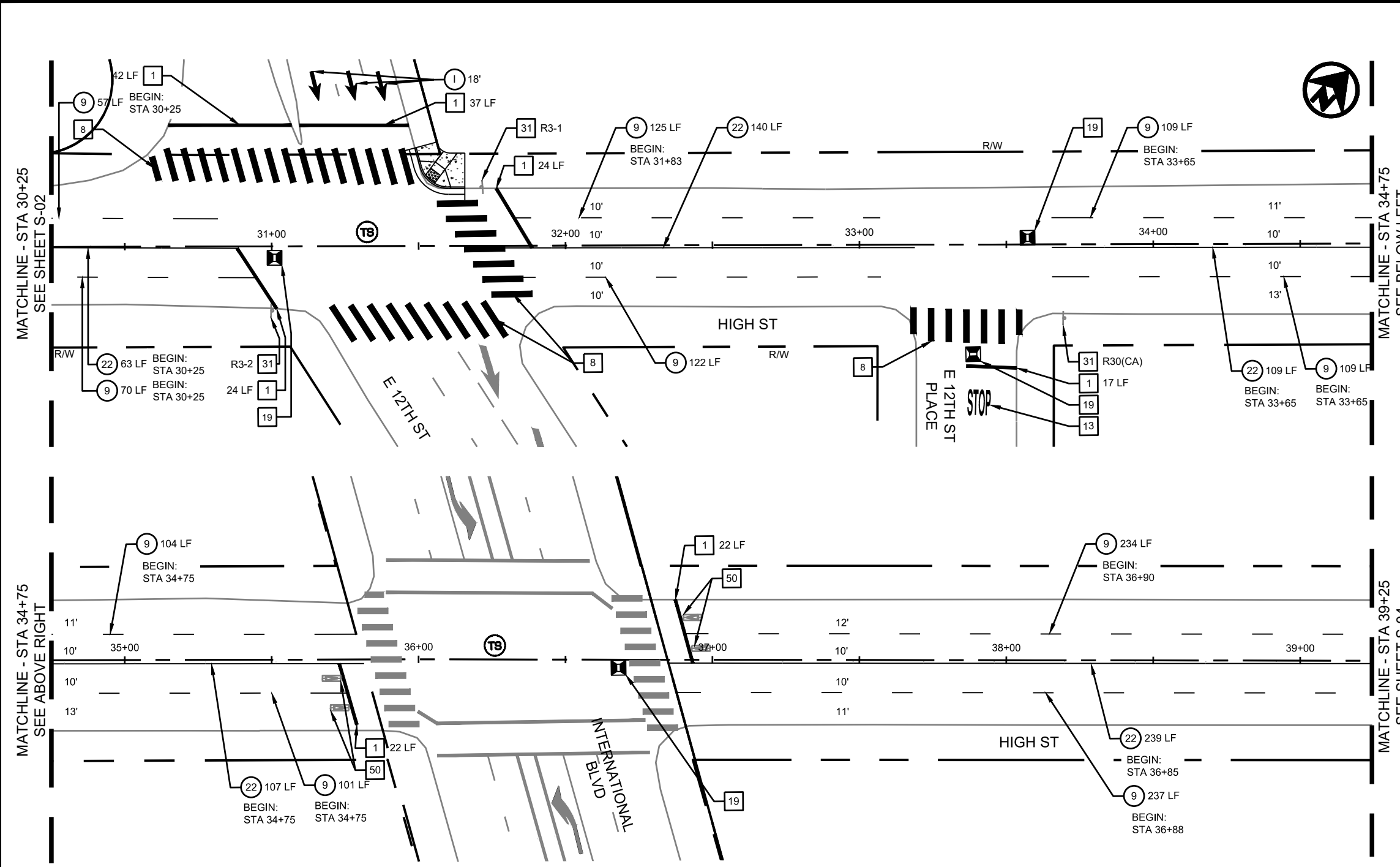

- GENERAL NOTES:**
- FOR NOTES, LEGEND AND ABBREVIATIONS SEE SHEET GN-02.
  - FOR DEMOLITION, LAYOUT, AND GRADING DRAWING NUMBERS AT THIS LOCATIONS, SEE SHEET T-01, INDEX OF DRAWINGS.

- ⊗ XX INSTALL STRIPING DETAIL NUMBER PER CALTRANS STD. PLANS A20A - A20E
- ○ INSTALL ROMAN NUMERAL ARROW PAVEMENT MARKINGS PER CALTRANS STD. PLAN A24A
- 1 INSTALL 12" WHITE LIMIT LINE MARKINGS
- 8 INSTALL HIGH VISIBILITY STYLE WHITE CROSSWALK MARKINGS PER CITY DETAIL RM-4
- 9 INSTALL HIGH VISIBILITY STYLE YELLOW CROSSWALK MARKINGS PER CITY DETAIL RM-4
- 13 INSTALL ADVANCE STOP MARKING PER DETAIL 3, SHEET D-07
- 16 INSTALL BICYCLE DETECTOR PAVEMENT MARKING PER CITY DETAIL RM-3
- 19 INSTALL BLUE PAVEMENT MARKER PER DETAIL 15, SHEET D-13
- 23 INSTALL DIAGONAL PAVEMENT STRIPING, COLOR PER PLANS
- 50 REPLACE BIKE DETECTOR LOOPS PER DETAIL RM-3 (SEE PAVING PLANS FOR DETAILS)



Know what's below.  
Call before you dig.

THE CONTRACTOR SHALL NOTIFY UNDERGROUND SERVICE ALERT AND THE CITY PUBLIC WORKS AGENCY AT LEAST 48 HOURS (2 WORKING DAYS) PRIOR TO BEGINNING ANY EXCAVATION IN THE VICINITY OF UNDERGROUND FACILITIES.

THE CONTRACTOR SHALL MARK, COVER, PROTECT, AND REMOVE ANY MATERIAL PLACED OVER UTILITIES (ANY CITY OR PRIVATE UTILITY MANHOLE COVER/VALVE LID) PRIOR TO MILL/PAVE OPERATION.

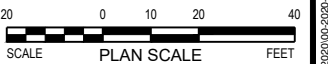

100% PLANS  
NOT FOR CONSTRUCTION



CITY OF OAKLAND  
HIGH STREET PAVING PROJECT



**CITY OF OAKLAND**  
DEPARTMENT OF TRANSPORTATION  
250 FRANK H. OGAWA PLAZA, SUITE 4314 • OAKLAND CA, 94612  
(510) 238-3437 • FAX (510) 238-7227

CIVIL ENGINEER  
**STEVEN B. FRIESON**  
RCE NO. C42110  
CHECKED BY: SF  
DESIGNED BY: VH  
DRAWN BY: EK

NO.	DATE	BY	REFERENCE

SIGNING AND STRIPING PLAN

PROJECT NO.  
**1005438**

SCALE: PER PLAN SCALE  
DATE: 7/5/2022

SHEET NO.  
**S-03**  
43 OF XX

DRAWING NAME: N:\Share\PROJECTS\2020\00-2020-204 Oakland CA, Signage & Striping for 3 Sts\CAD\01\_Plan\High Street Traffic Calming\2020-204\_T-CPH.dwg  
PLOT DATE: 10/24/22  
PLOT BY: ethammon

MATCHLINE - STA 39+25  
SEE SHEET S-03

MATCHLINE - STA 43+50  
SEE BELOW LEFT

MATCHLINE - STA 43+50  
SEE ABOVE RIGHT

MATCHLINE - STA 47+70  
SEE SHEET S-05

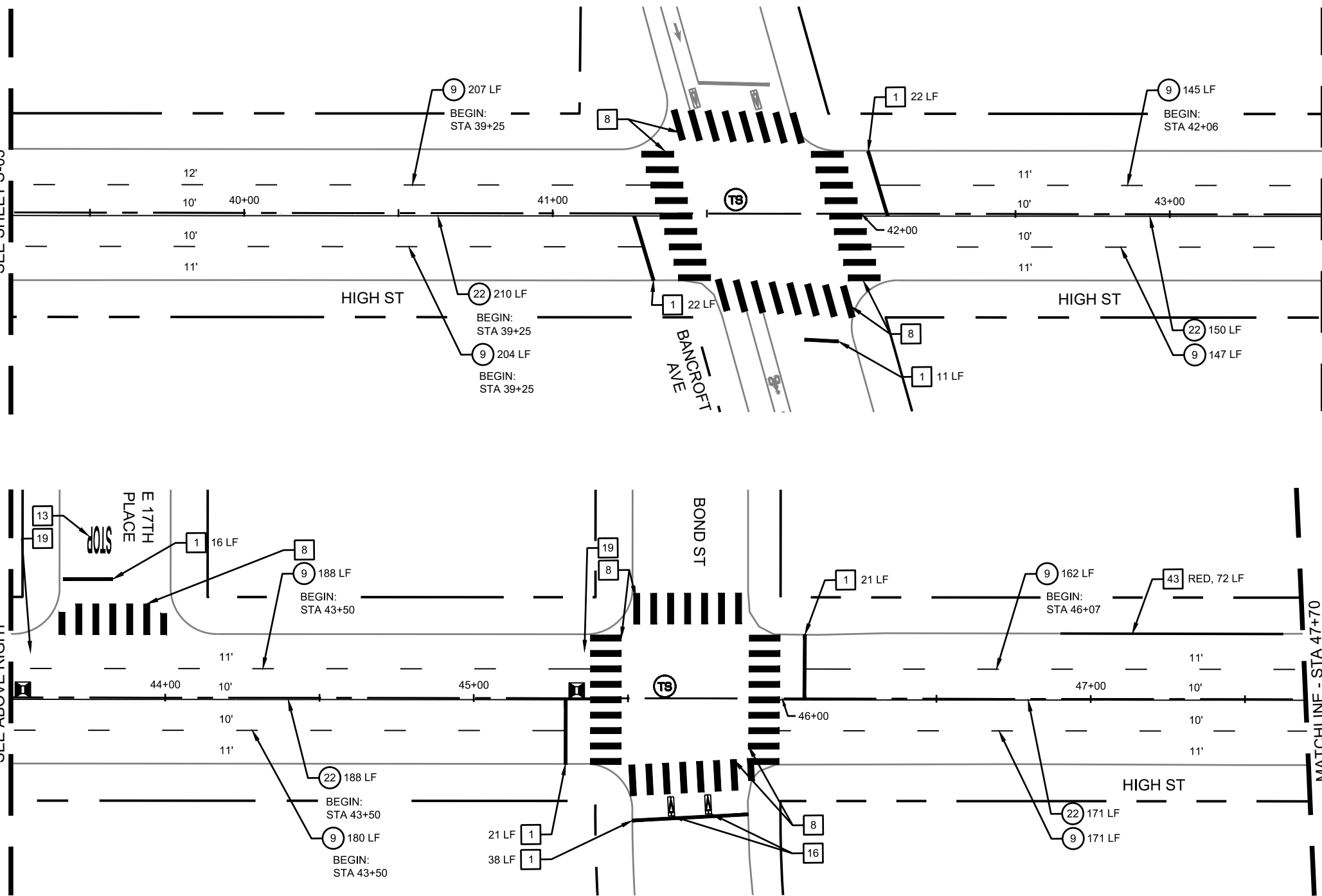

- ⊗ XX INSTALL STRIPING DETAIL NUMBER PER CALTRANS STD. PLANS A20A - A20E
- - INSTALL ROMAN NUMERAL ARROW PAVEMENT MARKINGS PER CALTRANS STD. PLAN A24A
- 1 INSTALL 12" WHITE LIMIT LINE MARKINGS

- 8 INSTALL HIGH VISIBILITY STYLE WHITE CROSSWALK MARKINGS PER CITY DETAIL RM-4
- 13 INSTALL ADVANCE STOP MARKING PER DETAIL 3, SHEET D-07
- 16 INSTALL BICYCLE DETECTOR PAVEMENT MARKING PER CITY DETAIL RM-3

- 19 INSTALL BLUE PAVEMENT MARKER PER DETAIL 15, SHEET D-13
- 43 PAINT CURB, COLOR AND LENGTH PER PLANS

**GENERAL NOTES:**

1. FOR NOTES, LEGEND AND ABBREVIATIONS SEE SHEET GN-02.
2. FOR DEMOLITION, LAYOUT, AND GRADING DRAWING NUMBERS AT THIS LOCATIONS, SEE SHEET T-01, INDEX OF DRAWINGS.



Know what's below.  
Call before you dig.

THE CONTRACTOR SHALL NOTIFY UNDERGROUND SERVICE ALERT AND THE CITY PUBLIC WORKS AGENCY AT LEAST 48 HOURS (2 WORKING DAYS) PRIOR TO BEGINNING ANY EXCAVATION IN THE VICINITY OF UNDERGROUND FACILITIES.

THE CONTRACTOR SHALL MARK, COVER, PROTECT, AND REMOVE ANY MATERIAL PLACED OVER UTILITIES (ANY CITY OR PRIVATE UTILITY MANHOLE COVER/VALVE LID) PRIOR TO MILL/PAVE OPERATION.

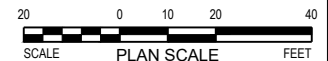

100% PLANS  
NOT FOR CONSTRUCTION



PRINCIPAL CIVIL ENGINEER

CITY OF OAKLAND  
HIGH STREET PAVING PROJECT



**CITY OF OAKLAND**

DEPARTMENT OF TRANSPORTATION  
250 FRANK H. OGAWA PLAZA, SUITE 4314 • OAKLAND CA, 94612  
(510) 238-3437 • FAX (510) 238-7227

CIVIL ENGINEER  
**STEVEN B. FRIESON**  
RCE NO. C42110  
CHECKED BY: SF  
DESIGNED BY: VH  
DRAWN BY: EK

NO.	DATE	BY	REFERENCE

**SIGNING AND STRIPING PLAN**

PROJECT NO. <b>1005438</b>	
SCALE: PER PLAN SCALE	SHEET NO. <b>S-04</b>
DATE: 7/5/2022	<b>44</b> OF <b>XX</b>

DRAWING NAME: N:\Share\PROJECTS\2020\00-2020-204 Oakland CA, Signage & Striping for 3 Sts\CAD\01\_Plan\High Street Traffic Calming\2020-004\_T-CPH.dwg  
PLOT DATE: 10/24/22  
PLOTTED BY: ethammon



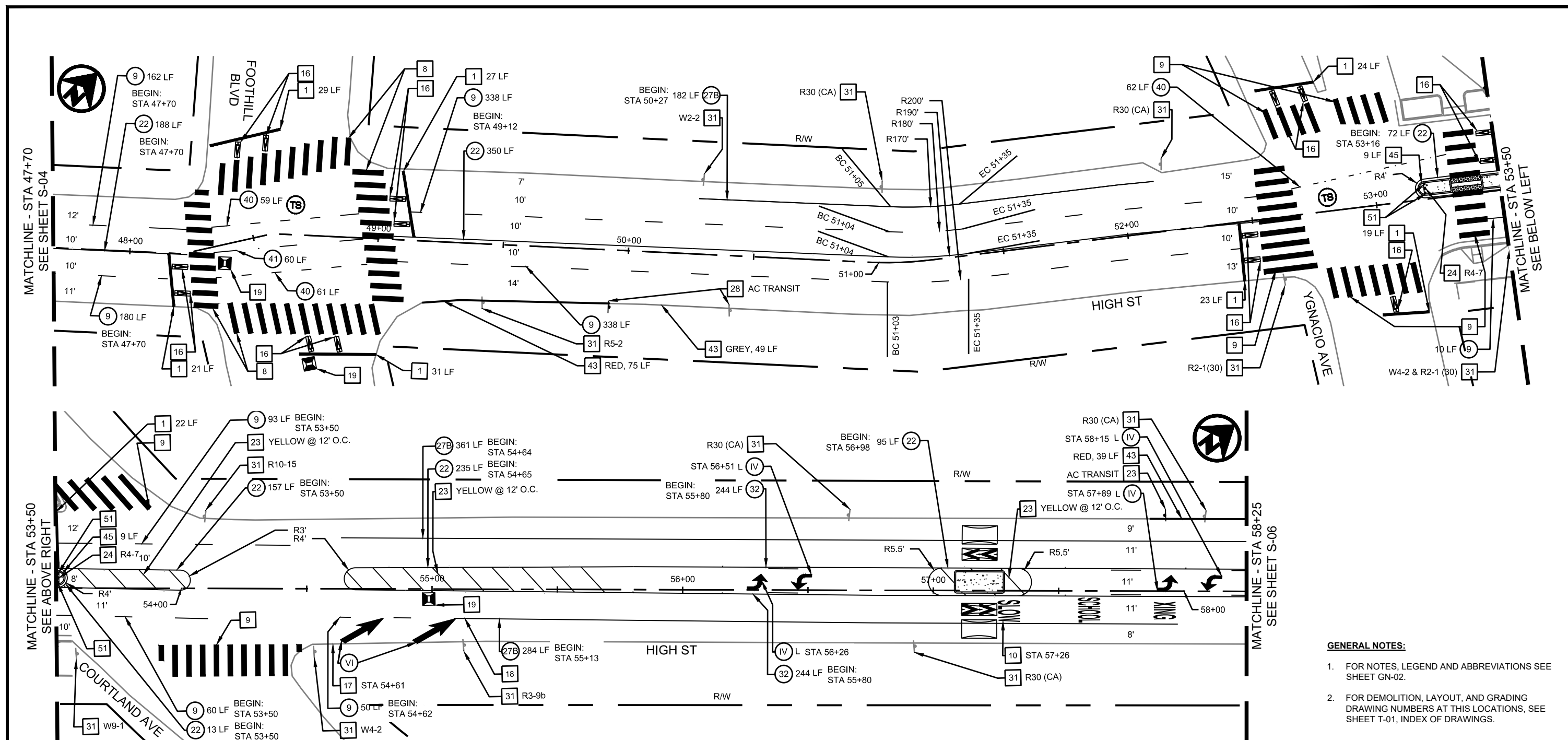

- GENERAL NOTES:**
- FOR NOTES, LEGEND AND ABBREVIATIONS SEE SHEET GN-02.
  - FOR DEMOLITION, LAYOUT, AND GRADING DRAWING NUMBERS AT THIS LOCATIONS, SEE SHEET T-01, INDEX OF DRAWINGS.

- XX INSTALL STRIPING DETAIL NUMBER PER CALTRANS STD. PLANS A20A - A20E
- INSTALL ROMAN NUMERAL ARROW PAVEMENT MARKINGS PER CALTRANS STD. PLAN A24A
- 1 INSTALL 12" WHITE LIMIT LINE MARKINGS
- 8 INSTALL HIGH VISIBILITY STYLE WHITE CROSSWALK MARKINGS PER CITY DETAIL RM-4
- 9 INSTALL HIGH VISIBILITY STYLE YELLOW CROSSWALK MARKINGS PER CITY DETAIL RM-4
- 10 INSTALL "SLOW SCHOOL XING" MARKINGS PER DETAIL 1, SHEET D-07
- 16 INSTALL BICYCLE DETECTOR PAVEMENT MARKING PER CITY DETAIL RM-3
- 17 BEGIN LANE TRANSITION PER CITY DETAIL CS-6
- 18 END LANE TRANSITION PER CITY DETAIL CS-6
- 19 INSTALL BLUE PAVEMENT MARKER PER DETAIL 15, SHEET D-13
- 23 INSTALL DIAGONAL PAVEMENT STRIPING, COLOR PER PLANS
- 24 INSTALL SIGN ON NEW POST PER CITY DETAIL SD-1
- 28 RELOCATE EX. SIGN AND POST AS SHOWN
- 31 PROTECT IN PLACE EX. SIGN
- 35 INSTALL ADVANCE YIELD LINE PER CITY DETAIL RM-6
- 43 PAINT CURB, COLOR AND LENGTH PER PLANS
- 45 INSTALL YELLOW CURB PAINT AND REFLECTORS ON MEDIAN NOSE PER DETAIL 17, SHEET D-20
- 51 TYPE Q (CA) OBJECT MARKER PER CALTRANS STD PLANS A 73 A, SHEET D-20 DETAIL 16

**811**  
Know what's below.  
Call before you dig.

THE CONTRACTOR SHALL NOTIFY UNDERGROUND SERVICE ALERT AND THE CITY PUBLIC WORKS AGENCY AT LEAST 48 HOURS (2 WORKING DAYS) PRIOR TO BEGINNING ANY EXCAVATION IN THE VICINITY OF UNDERGROUND FACILITIES.

THE CONTRACTOR SHALL MARK, COVER, PROTECT, AND REMOVE ANY MATERIAL PLACED OVER UTILITIES (ANY CITY OR PRIVATE UTILITY MANHOLE COVER/VALVE LID) PRIOR TO MILL/PAVE OPERATION.

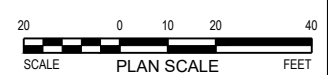

**100% PLANS NOT FOR CONSTRUCTION**



CITY OF OAKLAND  
HIGH STREET PAVING PROJECT



**CITY OF OAKLAND**  
DEPARTMENT OF TRANSPORTATION  
250 FRANK H. OGAWA PLAZA, SUITE 4314 • OAKLAND CA, 94612  
(510) 238-3437 • FAX: (510) 238-7227

CIVIL ENGINEER STEVEN B. FRIESON RCE NO. C42110	NO.	DATE	BY	REFERENCE
CHECKED BY: SF				
DESIGNED BY: VH				
DRAWN BY: EK				

**SIGNING AND STRIPING PLAN**

PROJECT NO.  
**1005438**

SCALE: PER PLAN SCALE  
DATE: 7/5/2022

SHEET NO.  
**S-05**  
45 OF XX

DRAWING NAME: N:\Shared\PROJECTS\2020\05\2020-204 Oakland CA, Signage & Striping for 3 Sts\CA\01\_ Plans\High Street Traffic Caltrans\2020-204\_T-CPH.dwg  
10/24/22  
PLOT DATE: 7/5/2022  
PLOTTED BY: ethammon

**GENERAL NOTES:**

- FOR NOTES, LEGEND AND ABBREVIATIONS SEE SHEET GN-02.
- FOR DEMOLITION, LAYOUT, AND GRADING DRAWING NUMBERS AT THIS LOCATIONS, SEE SHEET T-01, INDEX OF DRAWINGS.

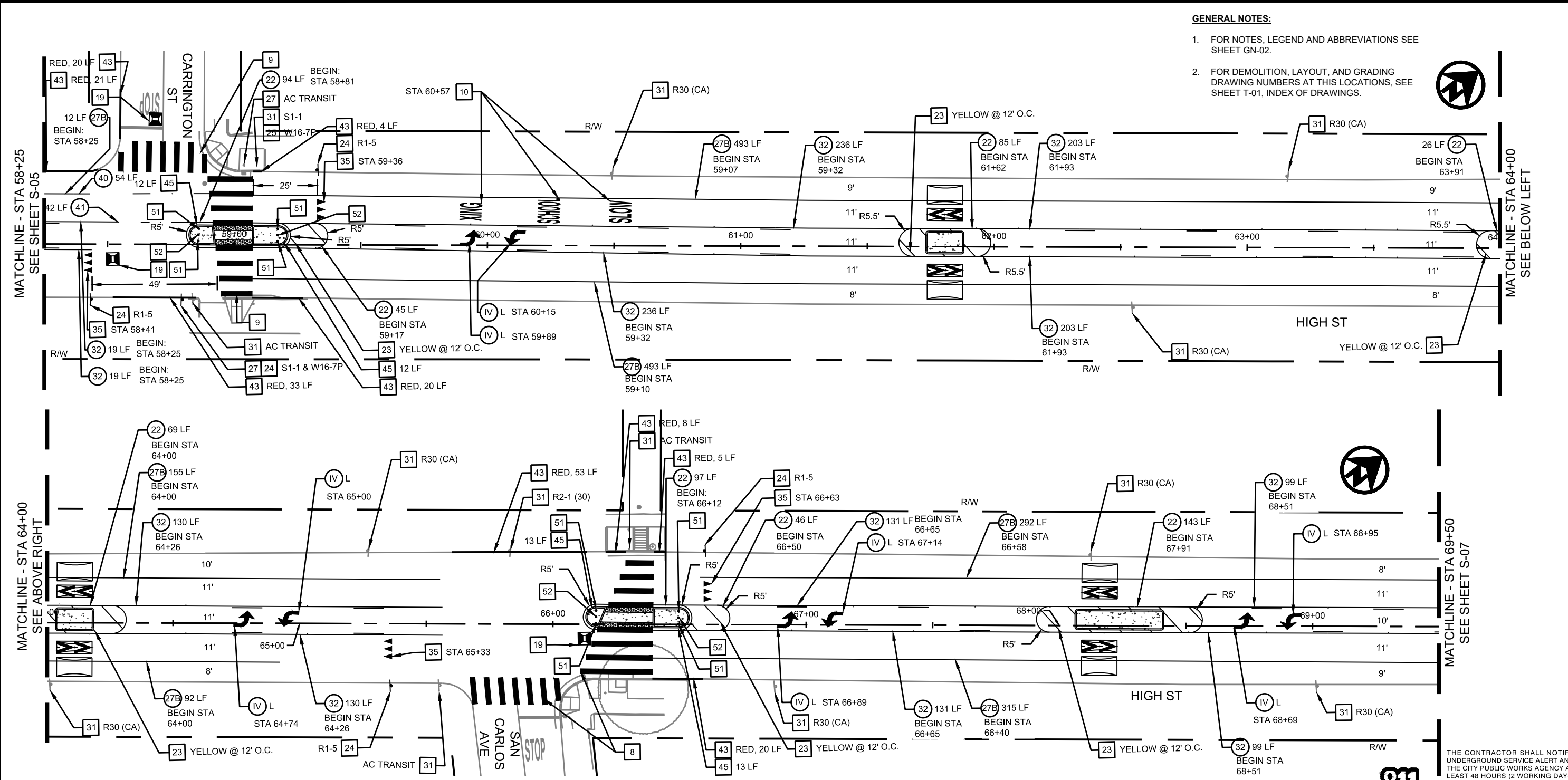

- (XX) INSTALL STRIPING DETAIL NUMBER PER CALTRANS STD. PLANS A20A - A20E
- (●) INSTALL ROMAN NUMERAL ARROW PAVEMENT MARKINGS PER CALTRANS STD. PLAN A24A
- (8) INSTALL HIGH VISIBILITY STYLE WHITE CROSSWALK MARKINGS PER CITY DETAIL RM-4
- (9) INSTALL HIGH VISIBILITY STYLE YELLOW CROSSWALK MARKINGS PER CITY DETAIL RM-4
- (10) INSTALL "SLOW SCHOOL XING" MARKINGS PER DETAIL 1, SHEET D-07
- (19) INSTALL BLUE PAVEMENT MARKER PER DETAIL 15, SHEET D-13
- (24) INSTALL SIGN ON NEW POST PER CITY DETAIL SD-1
- (25) INSTALL SIGN ON EX. POST
- (27) REMOVE EXISTING SIGN AND POST
- (31) PROTECT IN PLACE EX. SIGN
- (35) INSTALL ADVANCE YIELD LINE PER CITY DETAIL RM-6
- (43) PAINT CURB, COLOR AND LENGTH PER PLANS
- (45) INSTALL YELLOW CURB PAINT AND REFLECTORS ON MEDIAN NOSE PER DETAIL 17, SHEET D-20
- (51) TYPE Q (CA) OBJECT MARKER PER CALTRANS STD PLANS A 73 A, SHEET D-20 DETAIL 16
- (52) INSTALL R1-7 SIGN WITH TYPE K(CA) OBJECT MARKER



THE CONTRACTOR SHALL NOTIFY UNDERGROUND SERVICE ALERT AND THE CITY PUBLIC WORKS AGENCY AT LEAST 48 HOURS (2 WORKING DAYS) PRIOR TO BEGINNING ANY EXCAVATION IN THE VICINITY OF UNDERGROUND FACILITIES.

THE CONTRACTOR SHALL MARK, COVER, PROTECT, AND REMOVE ANY MATERIAL PLACED OVER UTILITIES (ANY CITY OR PRIVATE UTILITY MANHOLE COVER/VALVE LID) PRIOR TO MILL/PAVE OPERATION.

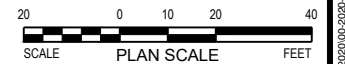

100% PLANS  
NOT FOR CONSTRUCTION



**CITY OF OAKLAND**  
HIGH STREET PAVING PROJECT



**CITY OF OAKLAND**  
DEPARTMENT OF TRANSPORTATION  
250 FRANK H. OGAWA PLAZA, SUITE 4314 • OAKLAND CA, 94612  
(510) 238-3437 • FAX: (510) 238-7227

CIVIL ENGINEER  
**STEVEN B. FRIESON**  
RCE NO. C42110  
CHECKED BY: SF  
DESIGNED BY: VH  
DRAWN BY: EK

NO.	DATE	BY	REFERENCE

SIGNING AND STRIPING PLAN

PROJECT NO.  
**1005438**

SCALE: PER PLAN SCALE  
DATE: 7/5/2022

SHEET NO.  
**S-06**  
46 OF XX

DRAWING NAME: N:\Share\PROJECTS\2020\00-2020-204 Oakland CA Signage & Striping for 3 Sts\CA\010\_Plan\High Street Traffic Calming\2020-204\_T-CPH.dwg  
PLOT DATE: 10/24/22  
PLOTTED BY: ethammon

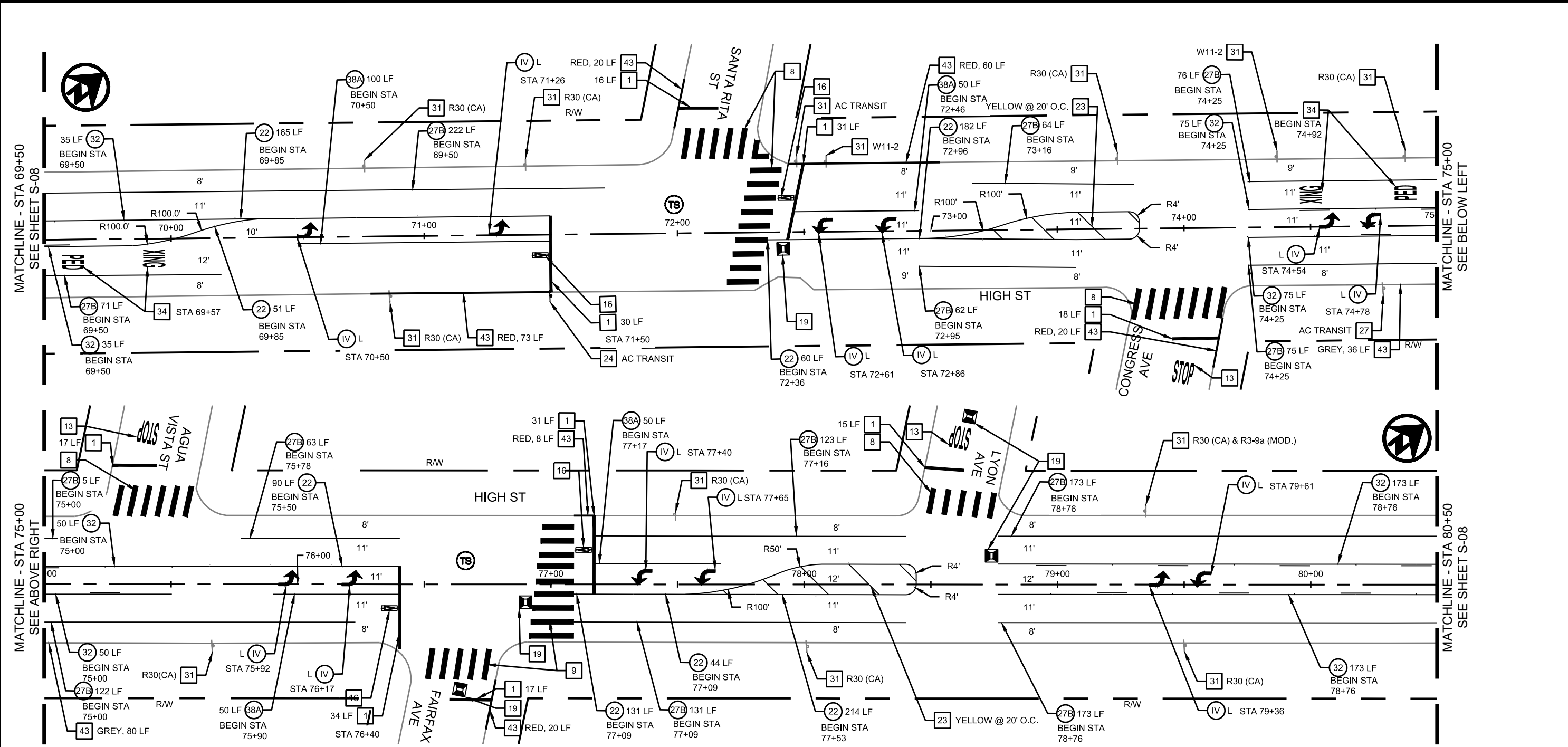

MATCHLINE - STA 69+50  
SEE SHEET S-08

MATCHLINE - STA 75+00  
SEE BELOW LEFT

MATCHLINE - STA 75+00  
SEE ABOVE RIGHT

MATCHLINE - STA 80+50  
SEE SHEET S-08

**GENERAL NOTES:**

- FOR NOTES, LEGEND AND ABBREVIATIONS SEE SHEET GN-02.
  - FOR DEMOLITION, LAYOUT, AND GRADING DRAWING NUMBERS AT THIS LOCATIONS, SEE SHEET T-01, INDEX OF DRAWINGS.
- 31 PROTECT IN PLACE EX. SIGN
  - 34 INSTALL "PED XING" MARKING PER DETAIL 4, SHEET D-08
  - 43 PAINT CURB, COLOR AND LENGTH PER PLANS



THE CONTRACTOR SHALL NOTIFY UNDERGROUND SERVICE ALERT AND THE CITY PUBLIC WORKS AGENCY AT LEAST 48 HOURS (2 WORKING DAYS) PRIOR TO BEGINNING ANY EXCAVATION IN THE VICINITY OF UNDERGROUND FACILITIES.

THE CONTRACTOR SHALL MARK, COVER, PROTECT, AND REMOVE ANY MATERIAL PLACED OVER UTILITIES (ANY CITY OR PRIVATE UTILITY MANHOLE COVER/VALVE LID) PRIOR TO MILL/PAVE OPERATION.

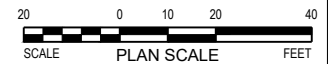

- XX INSTALL STRIPING DETAIL NUMBER PER CALTRANS STD. PLANS A20A - A20E
- INSTALL ROMAN NUMERAL ARROW PAVEMENT MARKINGS PER CALTRANS STD. PLAN A24A
- 1 INSTALL 12" WHITE LIMIT LINE MARKINGS
- 8 INSTALL HIGH VISIBILITY STYLE WHITE CROSSWALK MARKINGS PER CITY DETAIL RM-4
- 13 INSTALL ADVANCE STOP MARKING PER DETAIL 3, SHEET D-07
- 16 INSTALL BICYCLE DETECTOR PAVEMENT MARKING PER CITY DETAIL RM-3
- 19 INSTALL BLUE PAVEMENT MARKER PER DETAIL 15, SHEET D-13
- 23 INSTALL DIAGONAL PAVEMENT STRIPING, COLOR PER PLANS
- 27 REMOVE EXISTING SIGN AND POST

100% PLANS  
NOT FOR CONSTRUCTION



CITY OF OAKLAND  
HIGH STREET PAVING PROJECT



**CITY OF OAKLAND**  
DEPARTMENT OF TRANSPORTATION  
250 FRANK H. OGAWA PLAZA, SUITE 4314 • OAKLAND CA, 94612  
(510) 238-3437 • FAX: (510) 238-7227

CIVIL ENGINEER <b>STEVEN B. FRIESON</b> RCE No. C42110	NO.	DATE	BY	REFERENCE
CHECKED BY: SF				
DESIGNED BY: VH				
DRAWN BY: EK				

SIGNING AND STRIPING PLAN

PROJECT NO.  
**1005438**

SCALE: PER PLAN SCALE  
DATE: 7/5/2022

SHEET NO.  
**S-07**  
47 OF XX



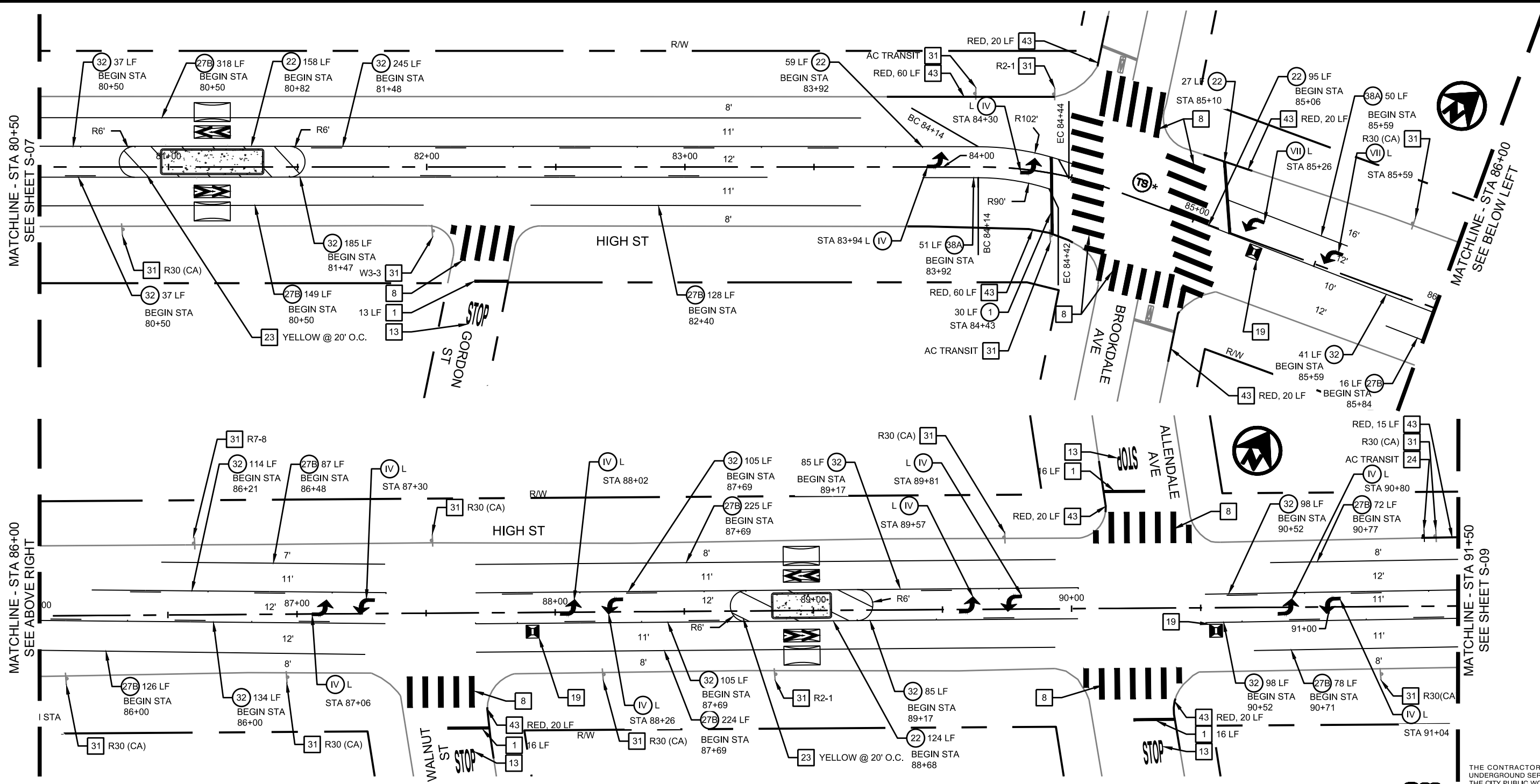

MATCHLINE - STA 80+50  
SEE SHEET S-07

MATCHLINE - STA 86+00  
SEE BELOW LEFT

MATCHLINE - STA 86+00  
SEE ABOVE RIGHT

MATCHLINE - STA 91+50  
SEE SHEET S-09

- (XX) INSTALL STRIPING DETAIL NUMBER PER CALTRANS STD. PLANS A20A - A20E
- (●) INSTALL ROMAN NUMERAL ARROW PAVEMENT MARKINGS PER CALTRANS STD. PLAN A24A
- [1] INSTALL 12" WHITE LIMIT LINE MARKINGS
- [8] INSTALL HIGH VISIBILITY STYLE WHITE CROSSWALK MARKINGS PER CITY DETAIL RM-4
- [13] INSTALL ADVANCE STOP MARKING PER DETAIL 3, SHEET D-07
- [19] INSTALL BLUE PAVEMENT MARKER PER DETAIL 15, SHEET D-13
- [24] INSTALL SIGN ON NEW POST PER CITY DETAIL SD-1
- [31] PROTECT IN PLACE EX. SIGN
- [43] PAINT CURB, COLOR AND LENGTH PER PLANS

**GENERAL NOTES:**

1. FOR NOTES, LEGEND AND ABBREVIATIONS SEE SHEET GN-02.
2. FOR DEMOLITION, LAYOUT, AND GRADING DRAWING NUMBERS AT THIS LOCATIONS, SEE SHEET T-01, INDEX OF DRAWINGS.
- 3\*. REMOVE MERGING (W4-2) SIGN FROM MAST ARM



THE CONTRACTOR SHALL NOTIFY UNDERGROUND SERVICE ALERT AND THE CITY PUBLIC WORKS AGENCY AT LEAST 48 HOURS (2 WORKING DAYS) PRIOR TO BEGINNING ANY EXCAVATION IN THE VICINITY OF UNDERGROUND FACILITIES.

THE CONTRACTOR SHALL MARK, COVER, PROTECT, AND REMOVE ANY MATERIAL PLACED OVER UTILITIES (ANY CITY OR PRIVATE UTILITY MANHOLE COVER/VALVE LID) PRIOR TO MILL/PAVE OPERATION.

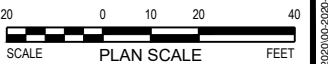

100% PLANS  
NOT FOR CONSTRUCTION



CITY OF OAKLAND  
HIGH STREET PAVING PROJECT



**CITY OF OAKLAND**  
DEPARTMENT OF TRANSPORTATION  
250 FRANK H. OGAWA PLAZA, SUITE 4314 • OAKLAND CA, 94612  
(510) 238-3437 • FAX: (510) 238-7227

CIVIL ENGINEER STEVEN B. FRIESON RCE NO. C42110	NO.	DATE	BY	REFERENCE
CHECKED BY: SF				
DESIGNED BY: VH				
DRAWN BY: EK				

SIGNING AND STRIPING PLAN

PROJECT NO.  
**1005438**

SCALE: PER PLAN SCALE  
DATE: 7/5/2022

SHEET NO.  
**S-08**  
48 OF XX

DRAWING NAME: N:\Shared\PROJECTS\2020\00-2020-204 Oakland CA, Signage & Striping for 3 Sts\CA\010\_Plan\High Street Traffic Calming\2020-204\_T-CPH.dwg  
PLOT DATE: 10/24/22  
PLOT BY: ethammon



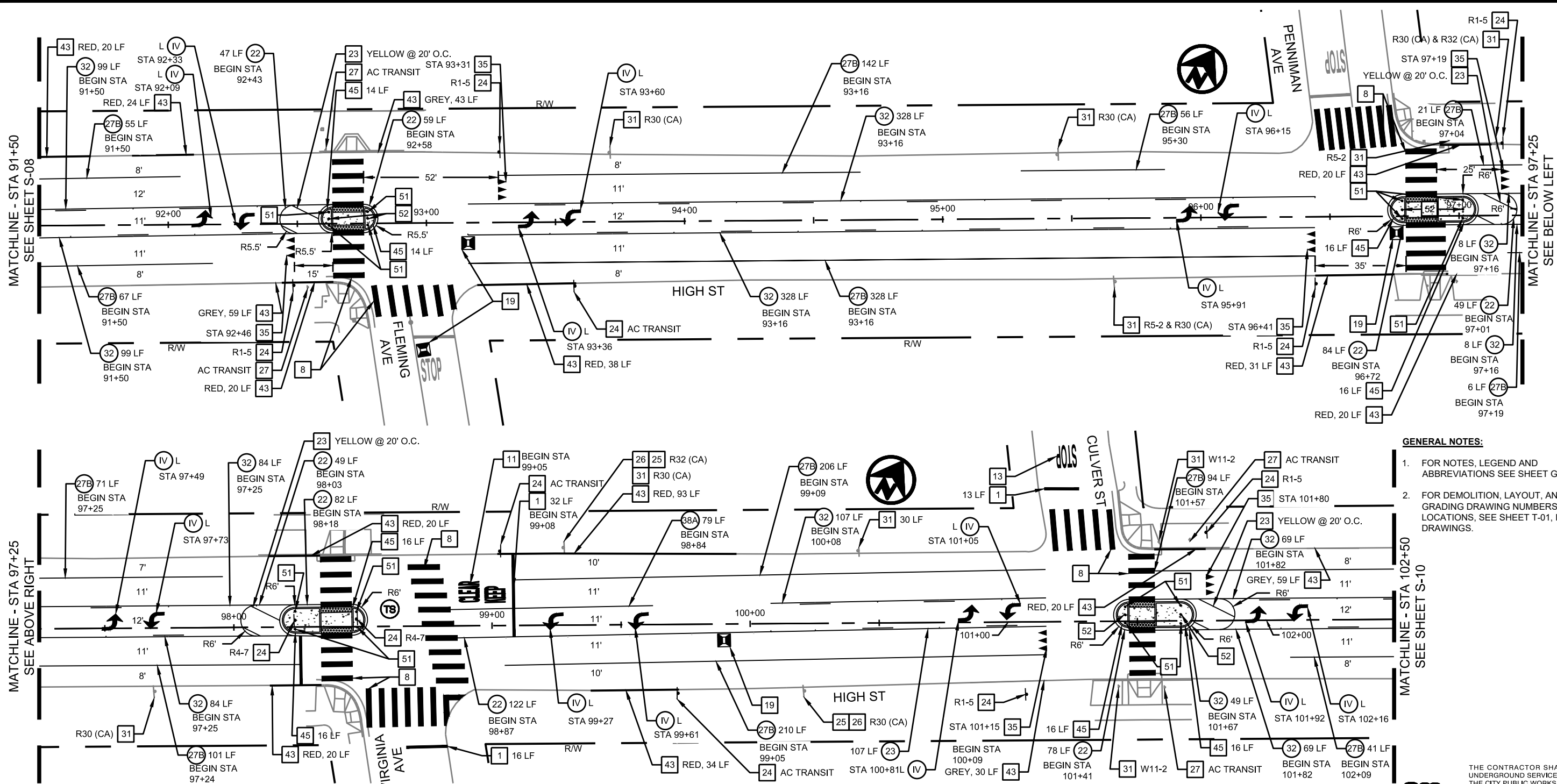

- GENERAL NOTES:**
- FOR NOTES, LEGEND AND ABBREVIATIONS SEE SHEET GN-02.
  - FOR DEMOLITION, LAYOUT, AND GRADING DRAWING NUMBERS AT THIS LOCATIONS, SEE SHEET T-01, INDEX OF DRAWINGS.

- XX INSTALL STRIPING DETAIL NUMBER PER CALTRANS STD. PLANS A20A - A20E
- INSTALL ROMAN NUMERAL ARROW PAVEMENT MARKINGS PER CALTRANS STD. PLAN A24A
- 1 INSTALL 12" WHITE LIMIT LINE MARKINGS
- 8 INSTALL HIGH VISIBILITY STYLE WHITE CROSSWALK MARKINGS PER CITY DETAIL RM-4
- 11 INSTALL "KEEP CLEAR" MARKINGS PER DETAIL 2, SHEET D-07
- 13 INSTALL ADVANCE STOP MARKING PER DETAIL 3, SHEET D-07
- 19 INSTALL BLUE PAVEMENT MARKER PER DETAIL 15, SHEET D-13
- 23 INSTALL DIAGONAL PAVEMENT STRIPING, COLOR PER PLANS
- 24 INSTALL SIGN ON NEW POST PER CITY DETAIL SD-1
- 25 INSTALL SIGN ON EX. POST
- 26 REMOVE EX. SIGN
- 27 REMOVE EXISTING SIGN AND POST
- 31 PROTECT IN PLACE EX. SIGN
- 35 INSTALL ADVANCE YIELD LINE PER CITY DETAIL RM-6
- 43 PAINT CURB, COLOR AND LENGTH PER PLANS
- 45 INSTALL YELLOW CURB PAINT AND REFLECTORS ON MEDIAN NOSE PER DETAIL 17, SHEET D-20
- 51 TYPE Q (CA) OBJECT MARKER PER CALTRANS STD PLANS A 73 A, SHEET D-20 DETAIL 16
- 52 INSTALL R1-7 SIGN WITH TYPE K(CA) OBJECT MARKER



THE CONTRACTOR SHALL NOTIFY UNDERGROUND SERVICE ALERT AND THE CITY PUBLIC WORKS AGENCY AT LEAST 48 HOURS (2 WORKING DAYS) PRIOR TO BEGINNING ANY EXCAVATION IN THE VICINITY OF UNDERGROUND FACILITIES.

THE CONTRACTOR SHALL MARK, COVER, PROTECT, AND REMOVE ANY MATERIAL PLACED OVER UTILITIES (ANY CITY OR PRIVATE UTILITY MANHOLE COVER/VALVE LID) PRIOR TO MILL/PAVE OPERATION.

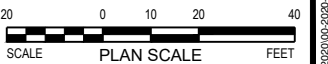

100% PLANS  
NOT FOR CONSTRUCTION

REGISTERED PROFESSIONAL ENGINEER  
STATE OF CALIFORNIA

PRINCIPAL CIVIL ENGINEER

CITY OF OAKLAND  
HIGH STREET PAVING PROJECT



**CITY OF OAKLAND**  
DEPARTMENT OF TRANSPORTATION  
250 FRANK H. OGAWA PLAZA, SUITE 4314 • OAKLAND CA, 94612  
(510) 238-3437 • FAX: (510) 238-7227

CIVIL ENGINEER STEVEN B. FRIESON RCE NO. C42110	NO.	DATE	BY	REFERENCE
CHECKED BY: SF				
DESIGNED BY: VH				
DRAWN BY: EK				

**SIGNING AND STRIPING PLAN**

PROJECT NO.  
**1005438**

SCALE: PER PLAN SCALE  
DATE: 7/5/2022

SHEET NO.  
**S-09**  
49 OF XX

DRAWING NAME: N:\Shared\PROJECTS\2020\1005438\Oakland CA\_Signage & Striping for 3 Sts\CA091\_Plan\High Street Traffic Calming\2020-094\_T\_CPA.dwg  
PLOT DATE: 10/24/22  
PLOTTED BY: ethammon

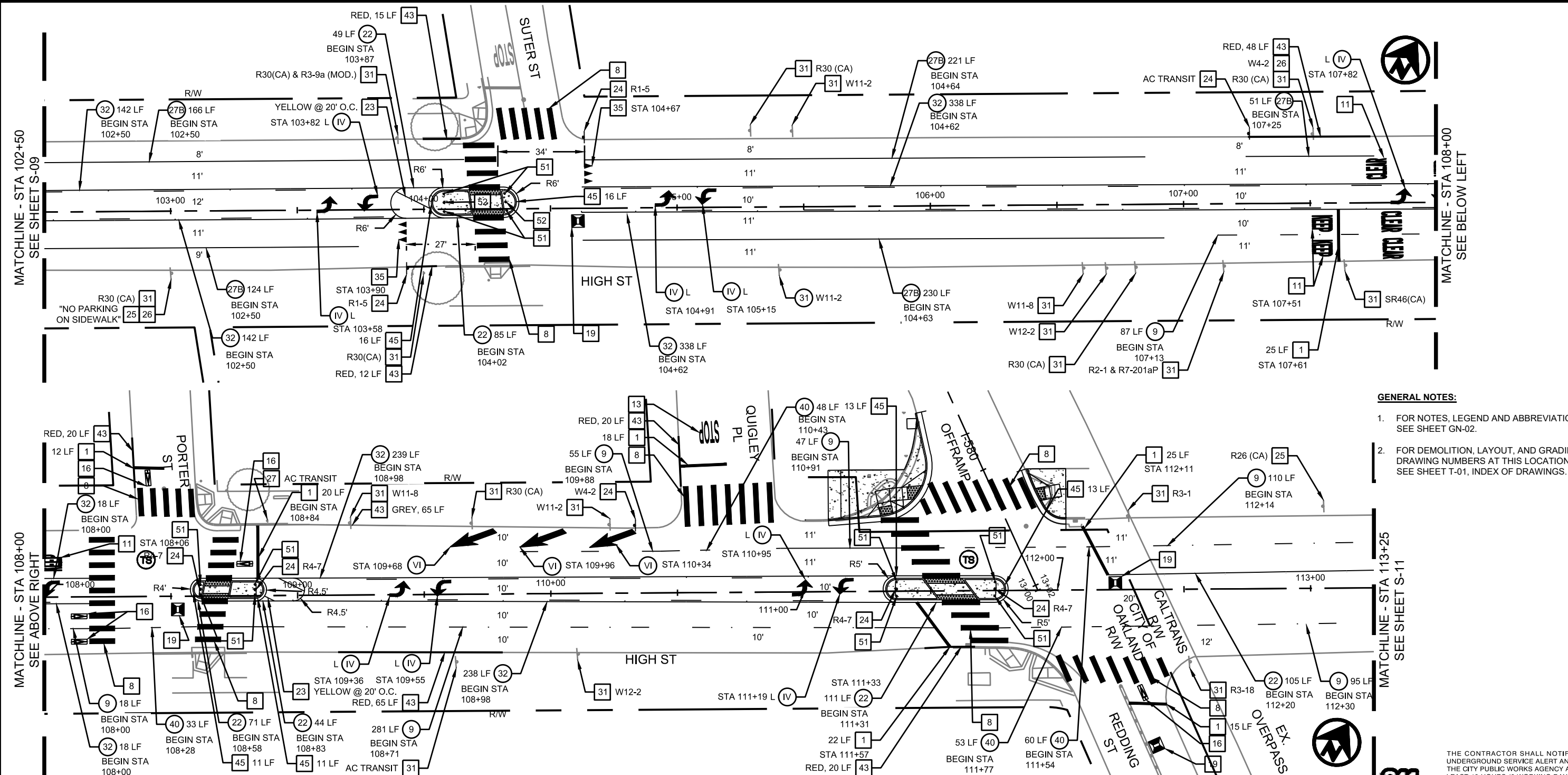

- GENERAL NOTES:**
- FOR NOTES, LEGEND AND ABBREVIATIONS SEE SHEET GN-02.
  - FOR DEMOLITION, LAYOUT, AND GRADING DRAWING NUMBERS AT THIS LOCATIONS, SEE SHEET T-01, INDEX OF DRAWINGS.

- XX INSTALL STRIPING DETAIL NUMBER PER CALTRANS STD. PLANS A20A - A20E
- INSTALL ROMAN NUMERAL ARROW PAVEMENT MARKINGS PER CALTRANS STD. PLAN A24A
- 1 INSTALL 12" WHITE LIMIT LINE MARKINGS
- 8 INSTALL HIGH VISIBILITY STYLE WHITE CROSSWALK MARKINGS PER CITY DETAIL RM-4
- 11 INSTALL "KEEP CLEAR" MARKINGS PER DETAIL 2, SHEET D-07
- 13 INSTALL ADVANCE STOP MARKING PER DETAIL 3, SHEET D-07
- 19 INSTALL BLUE PAVEMENT MARKER PER DETAIL 15, SHEET D-13
- 23 INSTALL DIAGONAL PAVEMENT STRIPING, COLOR PER PLANS
- 24 INSTALL SIGN ON NEW POST PER CITY DETAIL SD-1
- 25 INSTALL SIGN ON Ex. POST
- 26 REMOVE Ex. SIGN
- 27 REMOVE EXISTING SIGN AND POST
- 31 PROTECT IN PLACE EX. SIGN
- 35 INSTALL ADVANCE YIELD LINE PER CITY DETAIL RM-6
- 43 PAINT CURB, COLOR AND LENGTH PER PLANS
- 45 INSTALL YELLOW CURB PAINT AND REFLECTORS ON MEDIAN NOSE PER DETAIL 17, SHEET D-20
- 51 TYPE Q (CA) OBJECT MARKER PER CALTRANS STD PLANS A 73 A, SHEET D-20 DETAIL 16
- 52 INSTALL R1-7 SIGN WITH TYPE K(CA) OBJECT MARKER

**811**  
 Know what's below.  
 Call before you dig.

THE CONTRACTOR SHALL NOTIFY UNDERGROUND SERVICE ALERT AND THE CITY PUBLIC WORKS AGENCY AT LEAST 48 HOURS (2 WORKING DAYS) PRIOR TO BEGINNING ANY EXCAVATION IN THE VICINITY OF UNDERGROUND FACILITIES.

THE CONTRACTOR SHALL MARK, COVER, PROTECT, AND REMOVE ANY MATERIAL PLACED OVER UTILITIES (ANY CITY OR PRIVATE UTILITY MANHOLE COVER/VALVE LID) PRIOR TO MILL/PAVE OPERATION.

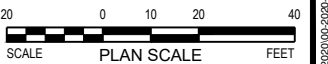

**100% PLANS NOT FOR CONSTRUCTION**

REGISTERED PROFESSIONAL ENGINEER  
 STATE OF CALIFORNIA

PRINCIPAL CIVIL ENGINEER

CITY OF OAKLAND  
 HIGH STREET PAVING PROJECT

**alta**

**CITY OF OAKLAND**  
 DEPARTMENT OF TRANSPORTATION  
 250 FRANK H. OGAWA PLAZA, SUITE 4314 • OAKLAND CA, 94612  
 (510) 238-3437 • FAX: (510) 238-7227

CIVIL ENGINEER STEVEN B. FRIESON RCE NO. C42110	NO.	DATE	BY	REFERENCE
CHECKED BY: SF				
DESIGNED BY: VH				
DRAWN BY: EK				

**SIGNING AND STRIPING PLAN**

PROJECT NO.  
**1005438**

SCALE: PER PLAN SCALE  
 SHEET NO. S-10  
 DATE: 7/5/2022  
 50 OF XX

DRAWING NAME: N:\Shared\PROJECTS\2020\00-2020-204 Oakland CA Signage & Striping for 3 SAs\CA001\_Plan\High Street Traffic Caltrans\2020-204\_T-CPN.dwg  
 PLOT DATE: 10/24/22  
 PLOTTED BY: ethammon



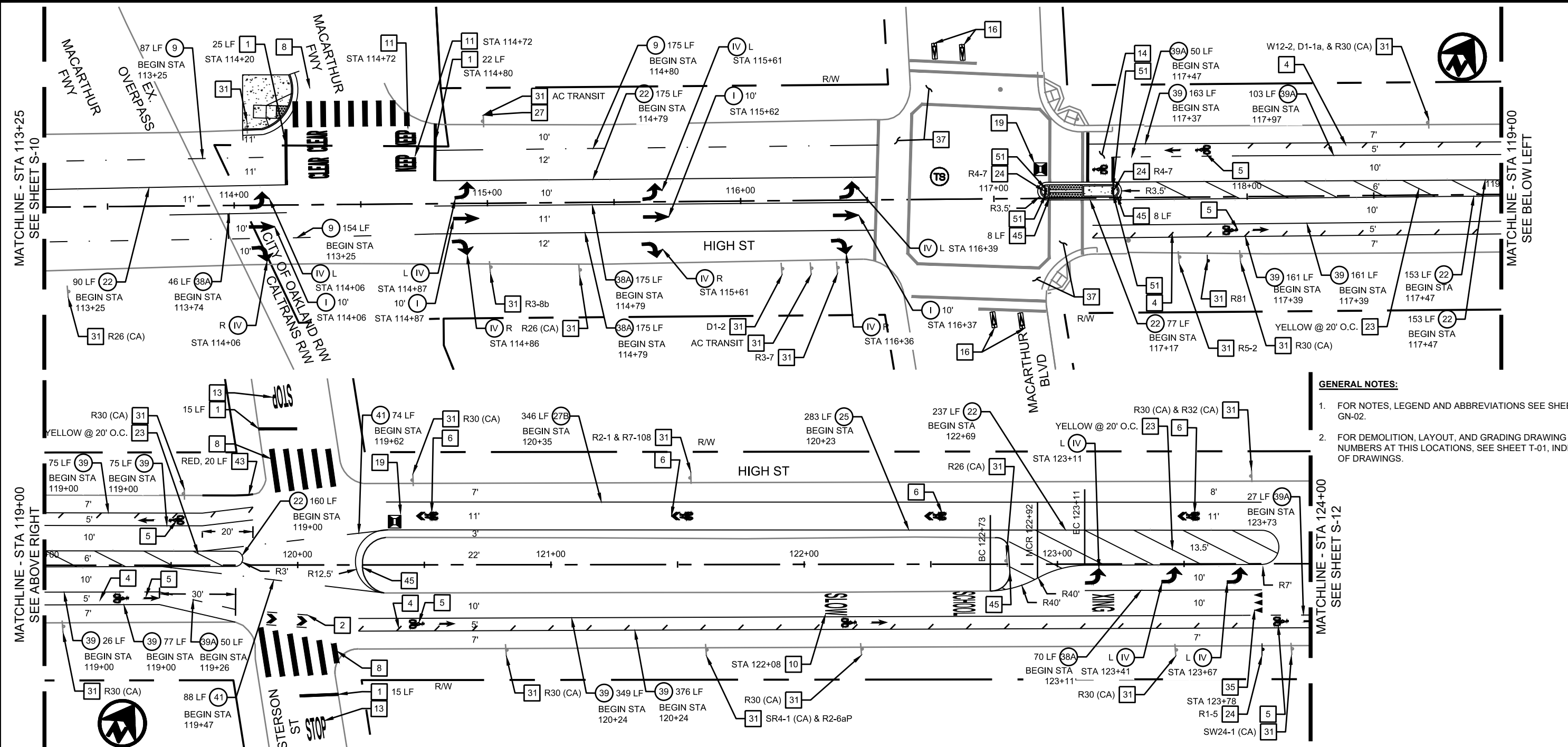

- GENERAL NOTES:**
- FOR NOTES, LEGEND AND ABBREVIATIONS SEE SHEET GN-02.
  - FOR DEMOLITION, LAYOUT, AND GRADING DRAWING NUMBERS AT THIS LOCATIONS, SEE SHEET T-01, INDEX OF DRAWINGS.

- XX INSTALL STRIPING DETAIL NUMBER PER CALTRANS STD. PLANS A20A - A20E
- INSTALL ROMAN NUMERAL ARROW PAVEMENT MARKINGS PER CALTRANS STD. PLAN A24A
- 1 INSTALL 12" WHITE LIMIT LINE MARKINGS
- 2 INSTALL BIKE LANE EXTENSION MARKINGS PER CITY DETAIL RM-9
- 4 INSTALL DIAGONAL BIKE LANE BUFFER STRIPING PER CITY DETAIL CS-1, TYP
- 5 INSTALL BIKE LANE PAVEMENT MARKINGS PER CITY DETAIL RM-1
- 6 INSTALL SHARED LANE PAVEMENT MARKINGS PER CITY DETAIL RM-2
- 8 INSTALL HIGH VISIBILITY STYLE WHITE CROSSWALK MARKINGS PER CITY DETAIL RM-4
- 10 INSTALL "SLOW SCHOOL XING" MARKINGS PER DETAIL 1, SHEET D-07
- 11 INSTALL "KEEP CLEAR" MARKINGS PER DETAIL 2, SHEET D-07
- 13 INSTALL ADVANCE STOP MARKING PER DETAIL 3, SHEET D-07
- 14 INSTALL INTERSECTION BIKE BOX PER CITY DETAIL RM-7
- 16 INSTALL BICYCLE DETECTOR PAVEMENT MARKING PER CITY DETAIL RM-3
- 19 INSTALL BLUE PAVEMENT MARKER PER DETAIL 15, SHEET D-13
- 23 INSTALL DIAGONAL PAVEMENT STRIPING, COLOR PER PLANS
- 24 INSTALL SIGN ON NEW POST PER CITY DETAIL SD-1
- 27 REMOVE EXISTING SIGN AND POST
- 31 PROTECT IN PLACE EX. SIGN
- 37 PROTECT IN PLACE DECORATIVE CROSSWALK
- 45 INSTALL YELLOW CURB PAINT AND REFLECTORS ON MEDIAN NOSE PER DETAIL 17, SHEET D-20
- 51 TYPE Q (CA) OBJECT MARKER PER CALTRANS STD PLANS A 73 A, SHEET D-20 DETAIL 16



THE CONTRACTOR SHALL NOTIFY UNDERGROUND SERVICE ALERT AND THE CITY PUBLIC WORKS AGENCY AT LEAST 48 HOURS (2 WORKING DAYS) PRIOR TO BEGINNING ANY EXCAVATION IN THE VICINITY OF UNDERGROUND FACILITIES.

THE CONTRACTOR SHALL MARK, COVER, PROTECT, AND REMOVE ANY MATERIAL PLACED OVER UTILITIES (ANY CITY OR PRIVATE UTILITY MANHOLE COVER/VALVE LID) PRIOR TO MILL/PAVE OPERATION.

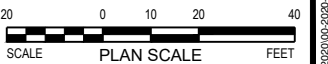

100% PLANS  
NOT FOR CONSTRUCTION



CITY OF OAKLAND  
HIGH STREET PAVING PROJECT



**CITY OF OAKLAND**  
DEPARTMENT OF TRANSPORTATION  
250 FRANK H. OGAWA PLAZA, SUITE 4314 • OAKLAND CA, 94612  
(510) 238-3437 • FAX: (510) 238-7227

CIVIL ENGINEER <b>STEVEN B. FRIESON</b> RCE NO. <b>C42110</b>	NO.	DATE	BY	REFERENCE
CHECKED BY: SF				
DESIGNED BY: VH				
DRAWN BY: EK				

SIGNING AND STRIPING PLAN

PROJECT NO.  
**1005438**

SCALE: PER PLAN SCALE  
DATE: 7/5/2022

SHEET NO.  
**S-11**  
51 OF XX

DRAWING NAME: N:\Shared\PROJECTS\2020\00-2620-26 Oakland CA Signage & Striping for 3 SAs\CA\010\_Plan\High Street Traffic Caltrans\2020-004\_T\_SPA.dwg  
PLOT DATE: 10/24/22  
PLOT BY: ethammon



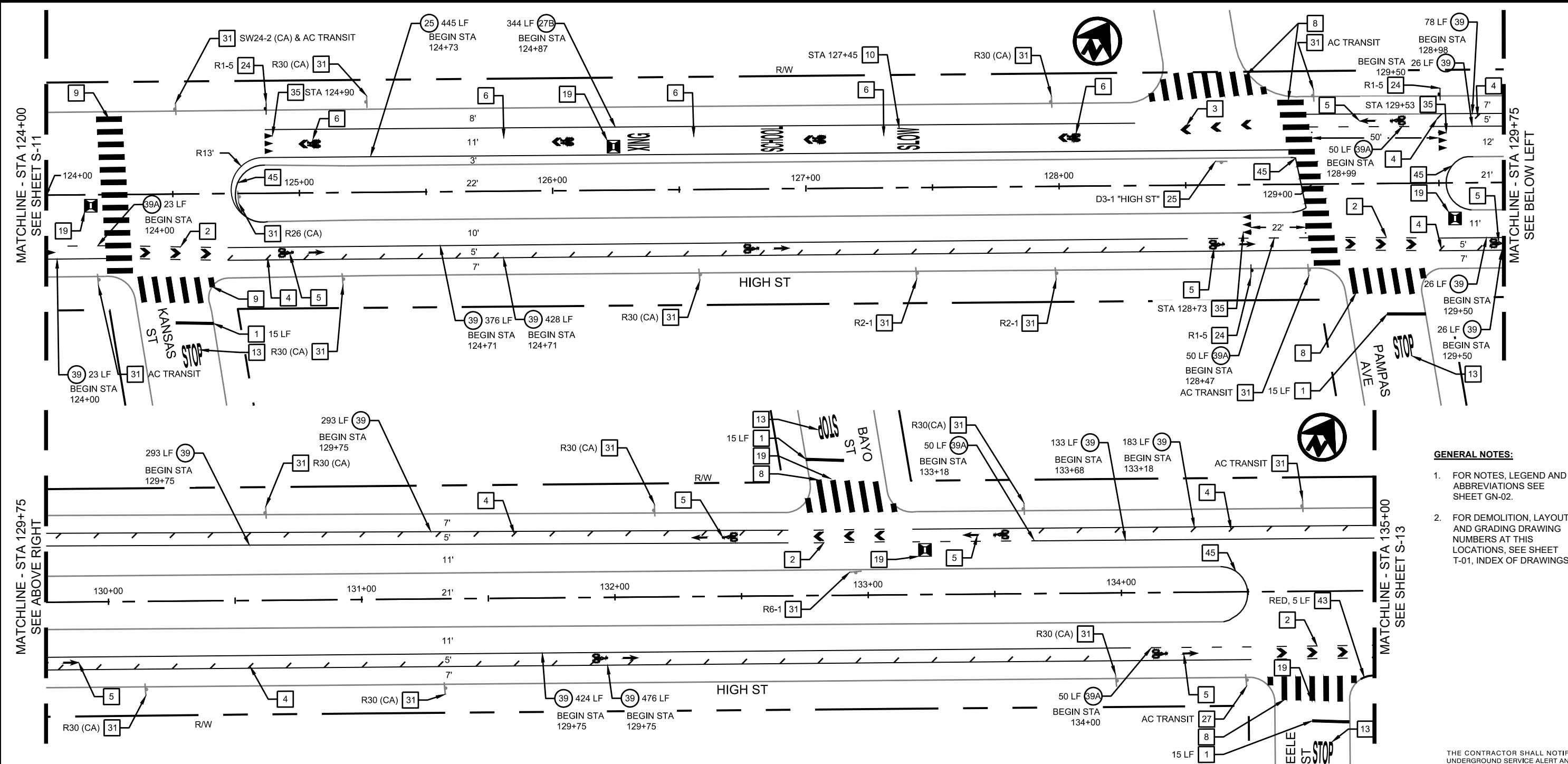

- GENERAL NOTES:**
- FOR NOTES, LEGEND AND ABBREVIATIONS SEE SHEET GN-02.
  - FOR DEMOLITION, LAYOUT, AND GRADING DRAWING NUMBERS AT THIS LOCATIONS, SEE SHEET T-01, INDEX OF DRAWINGS.

- ⊗ XX INSTALL STRIPING DETAIL NUMBER PER CALTRANS STD. PLANS A20A - A20E
- - INSTALL ROMAN NUMERAL ARROW PAVEMENT MARKINGS PER CALTRANS STD. PLAN A24A
- 1 INSTALL 12" WHITE LIMIT LINE MARKINGS
- 2 INSTALL BIKE LANE EXTENSION MARKINGS PER CITY DETAIL RM-9
- 4 INSTALL DIAGONAL BIKE LANE BUFFER STRIPING PER CITY DETAIL CS-1, TYP
- 5 INSTALL BIKE LANE PAVEMENT MARKINGS PER CITY DETAIL RM-1
- 6 INSTALL SHARED LANE PAVEMENT MARKINGS PER CITY DETAIL RM-2
- 8 INSTALL HIGH VISIBILITY STYLE WHITE CROSSWALK MARKINGS PER CITY DETAIL RM-4
- 9 INSTALL HIGH VISIBILITY STYLE YELLOW CROSSWALK MARKINGS PER CITY DETAIL RM-4
- 10 INSTALL "SLOW SCHOOL XING" MARKINGS PER DETAIL 1, SHEET D-07
- 13 INSTALL ADVANCE STOP MARKING PER DETAIL 3, SHEET D-07
- 19 INSTALL BLUE PAVEMENT MARKER PER DETAIL 15, SHEET D-13
- 24 INSTALL SIGN ON NEW POST PER CITY DETAIL SD-1
- 27 REMOVE EXISTING SIGN AND POST
- 31 PROTECT IN PLACE EX. SIGN
- 35 INSTALL ADVANCE YIELD LINE PER CITY DETAIL RM-6
- 43 PAINT CURB, COLOR AND LENGTH PER PLANS
- 45 INSTALL YELLOW CURB PAINT AND REFLECTORS ON MEDIAN NOSE PER DETAIL 17, SHEET D-20



THE CONTRACTOR SHALL NOTIFY UNDERGROUND SERVICE ALERT AND THE CITY PUBLIC WORKS AGENCY AT LEAST 48 HOURS (2 WORKING DAYS) PRIOR TO BEGINNING ANY EXCAVATION IN THE VICINITY OF UNDERGROUND FACILITIES.

THE CONTRACTOR SHALL MARK, COVER, PROTECT, AND REMOVE ANY MATERIAL PLACED OVER UTILITIES (ANY CITY OR PRIVATE UTILITY MANHOLE COVER/VALVE LID) PRIOR TO MILL/PAVE OPERATION.

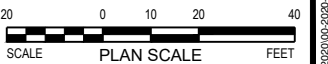

100% PLANS  
NOT FOR CONSTRUCTION



CITY OF OAKLAND  
HIGH STREET PAVING PROJECT



**CITY OF OAKLAND**  
DEPARTMENT OF TRANSPORTATION  
250 FRANK H. OGAWA PLAZA, SUITE 4314 • OAKLAND CA, 94612  
(510) 238-3437 • FAX: (510) 238-7227

CIVIL ENGINEER STEVEN B. FRIERSON RCE NO. C42110	NO.	DATE	BY	REFERENCE
CHECKED BY: SF				
DESIGNED BY: VH				
DRAWN BY: EK				

SIGNING AND STRIPING PLAN

PROJECT NO.  
**1005438**

SCALE: PER PLAN SCALE  
DATE: 7/5/2022

SHEET NO.  
**S-12**  
52 OF XX

DRAWING NAME: N:\Shared\PROJECTS\2020\1005438\2020-08-26\Oakland CA\_Signage & Striping for 3 Sts\CA\010\_Plan\High Street Traffic Calming\2020-08-26\_1.dwg  
PLOT DATE: 10/24/22  
PLOTTED BY: ethammon

MATCHLINE - STA 135+00  
SEE SHEET S-12

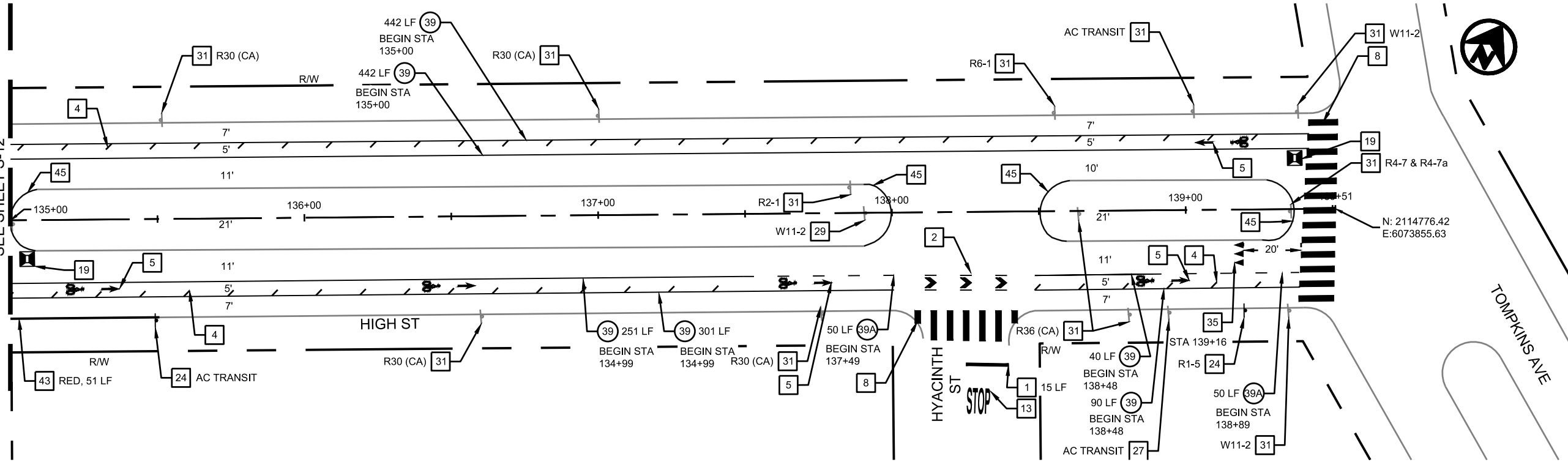

**GENERAL NOTES:**

- FOR NOTES, LEGEND AND ABBREVIATIONS SEE SHEET GN-02.
- FOR DEMOLITION, LAYOUT, AND GRADING DRAWING NUMBERS AT THIS LOCATIONS, SEE SHEET T-01, INDEX OF DRAWINGS.

- XX INSTALL STRIPING DETAIL NUMBER PER CALTRANS STD. PLANS A20A - A20E
- INSTALL ROMAN NUMERAL ARROW PAVEMENT MARKINGS PER CALTRANS STD. PLAN A24A
- 1 INSTALL 12" WHITE LIMIT LINE MARKINGS
- 2 INSTALL BIKE LANE EXTENSION MARKINGS PER CITY DETAIL RM-9

- 4 INSTALL DIAGONAL BIKE LANE BUFFER STRIPING PER CITY DETAIL CS-1, TYP
- 5 INSTALL BIKE LANE PAVEMENT MARKINGS PER CITY DETAIL RM-1
- 8 INSTALL HIGH VISIBILITY STYLE WHITE CROSSWALK MARKINGS PER CITY DETAIL RM-4
- 13 INSTALL ADVANCE STOP MARKING PER DETAIL 3, SHEET D-07

- 19 INSTALL BLUE PAVEMENT MARKER PER DETAIL 15, SHEET D-13
- 24 INSTALL SIGN ON NEW POST PER CITY DETAIL SD-1
- 27 REMOVE EXISTING SIGN AND POST
- 29 RELOCATE Ex. SIGN AS SHOWN

- 31 PROTECT IN PLACE EX. SIGN
- 35 INSTALL ADVANCE YIELD LINE PER CITY DETAIL RM-6
- 43 PAINT CURB, COLOR AND LENGTH PER PLANS
- 45 INSTALL YELLOW CURB PAINT AND REFLECTORS ON MEDIAN NOSE PER DETAIL 17, SHEET D-20

**811**  
Know what's below.  
Call before you dig.

THE CONTRACTOR SHALL NOTIFY UNDERGROUND SERVICE ALERT AND THE CITY PUBLIC WORKS AGENCY AT LEAST 48 HOURS (2 WORKING DAYS) PRIOR TO BEGINNING ANY EXCAVATION IN THE VICINITY OF UNDERGROUND FACILITIES.

THE CONTRACTOR SHALL MARK, COVER, PROTECT, AND REMOVE ANY MATERIAL PLACED OVER UTILITIES (ANY CITY OR PRIVATE UTILITY MANHOLE COVER/VALVE LID) PRIOR TO MILL/PAVE OPERATION.

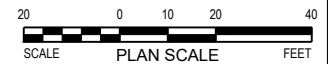

**100% PLANS NOT FOR CONSTRUCTION**



CITY OF OAKLAND  
HIGH STREET PAVING PROJECT



**CITY OF OAKLAND**  
DEPARTMENT OF TRANSPORTATION  
250 FRANK H. OGAWA PLAZA, SUITE 4314 \* OAKLAND CA, 94612  
(510) 238-3437 \* FAX (510) 238-7227

CIVIL ENGINEER  
**STEVEN B. FRIESON**  
RCE NO. **C42110**  
CHECKED BY: SF  
DESIGNED BY: VH  
DRAWN BY: EK

NO.	DATE	BY	REFERENCE

**SIGNING AND STRIPING PLAN  
HIGH STREET**

PROJECT NO.  
**1005438**

SCALE: PER PLAN SCALE  
DATE: 7/5/2022

SHEET NO.  
**S-13**  
53 OF XX

DRAWING NAME: N:\Share\PROJECTS\2020\05\2020-204 Oakland CA, Signage & Striping for 3 Sts\CA\010\_Plan\High Street Traffic Calming\2020-204\_T\_CPH.dwg  
PLOT DATE: 10/24/22  
PLOT BY: ethammon