

LAMMPS Phases 2 & 3

March 7, 2024

BPAC Infrastructure Committee Meeting

Cathy DeLuca, Transportation Planner

Charlie Ream, Acting Lead, Planning & Project Development



City of
Oakland

Department of
Transportation

LAMMPS

Laurel Access to Mills, Maxwell Park and Seminary

A network of safe, calm, connected streets from the Laurel District to Mills and surrounding neighborhoods

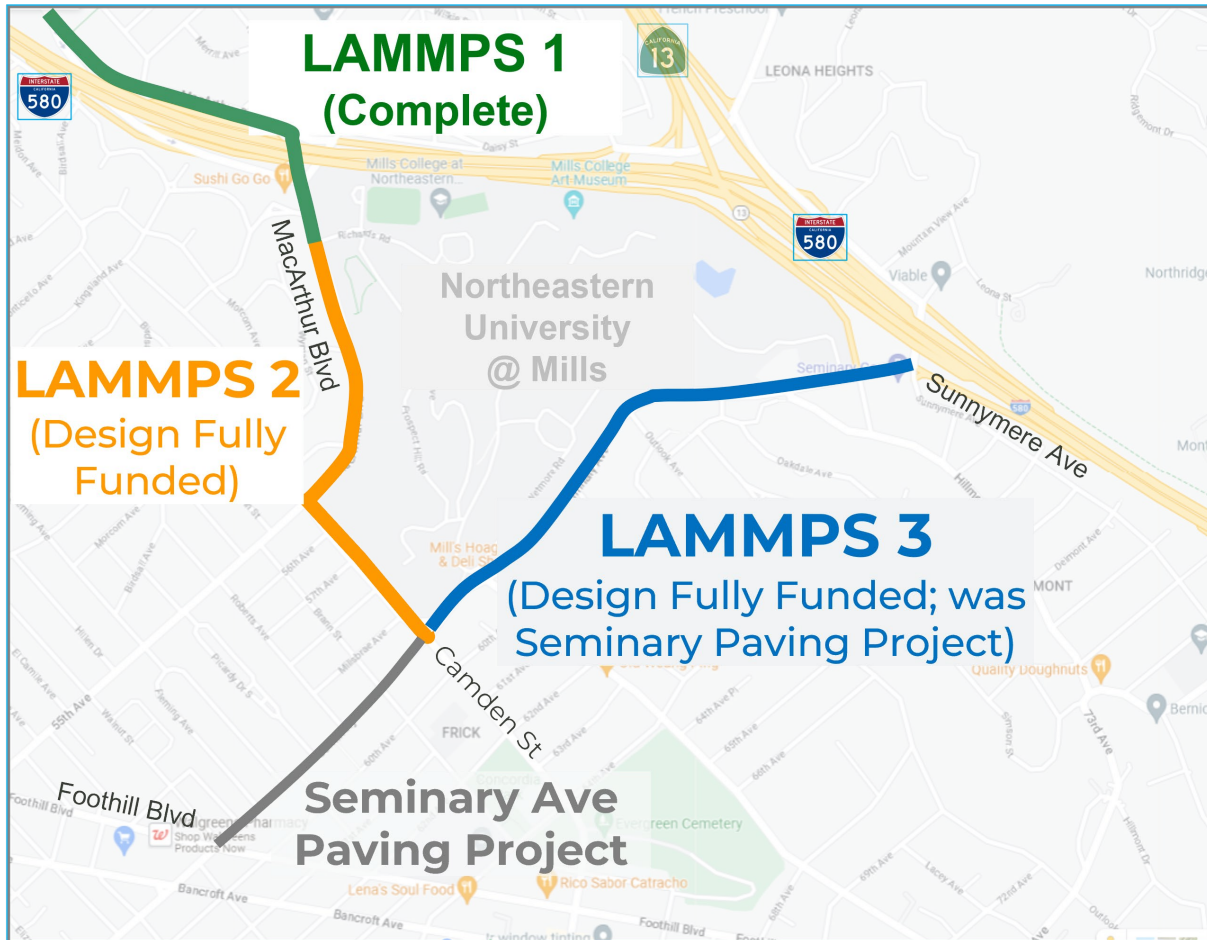

Extension of Class 1 path up Seminary will result in a 1.7 mile continuous recreational path

LAMMPS 2 & 3 Construction Funding

Affordable Housing & Sustainable Communities (AHSC)

- \$9m
- March 19 – app due

Safe Streets for All

- Funding ask TBD
- May 16 – app due

LAMMPS 2 Project Schedule

Timeframe	Activity
2022	35% Design Complete
Spring 2024	Issue RFP for Final Design
Early 2025	Revised 35% Design & Community Outreach
Fall 2025/Winter 2026	Final Design
2027	Construction Start

LAMMPS 3 (Seminary) Project Schedule

Timeframe	Activity
Spring 2023	Initial Outreach
Spring/Summer 2023	Traffic Studies
Late Summer/Fall 2023	Bike Connection Survey
Winter 2023/24	Initial Design (15%) Completed
Early 2024	Outreach on Initial Design
Late Summer/Fall 2024	Share 35% Design
2027	Construction

LAMMPS 3 / Seminary Ave

15% Designs

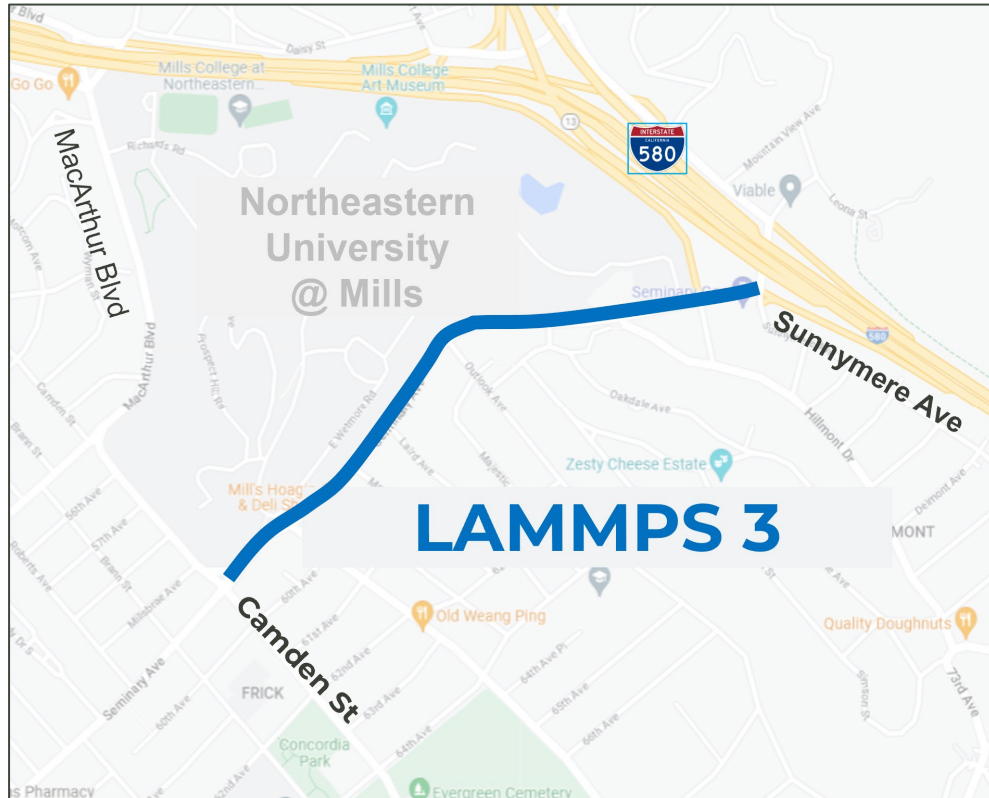

Northeastern @ Mills

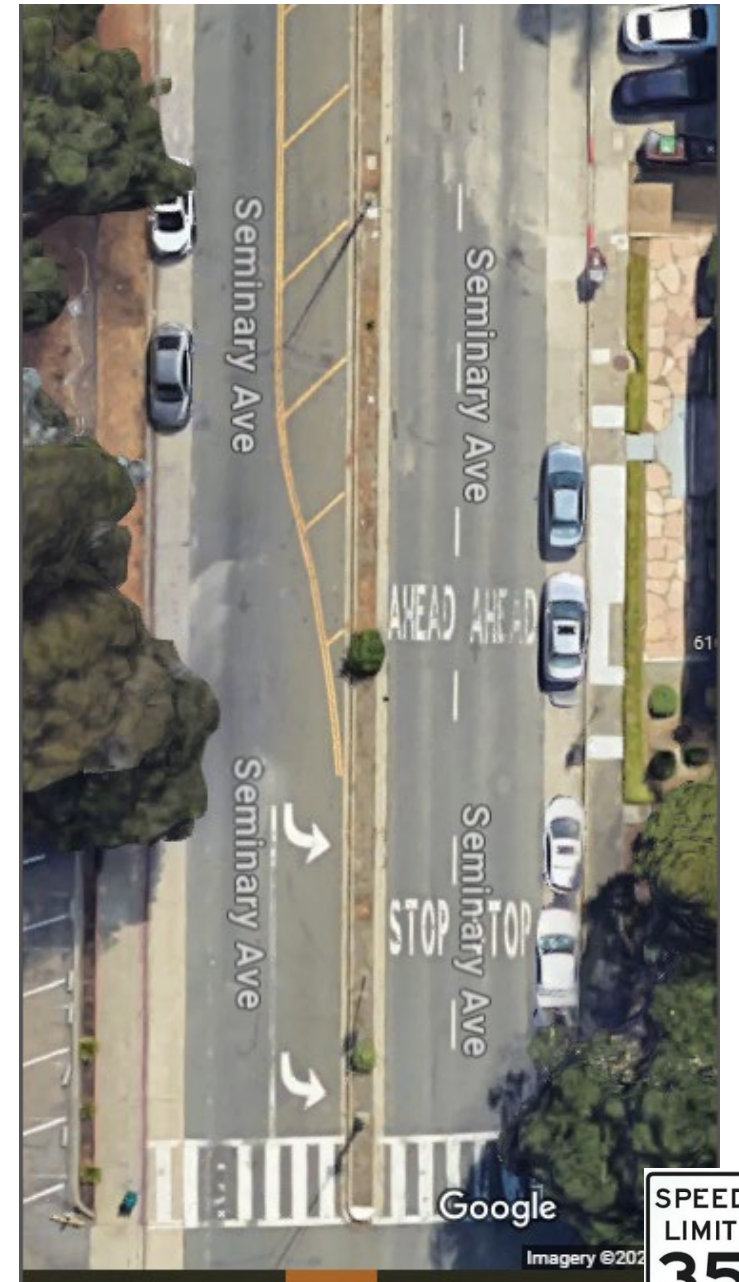

Millsmont
Neighborhood

↓ downhill toward Camden

SPEED
LIMIT
35

Main Project Components

- Class 1 path along Mills frontage
- Uphill road diet (2 to 1)
- Closure of sidewalk gaps (res. side)

Consideration

- Fire clearance

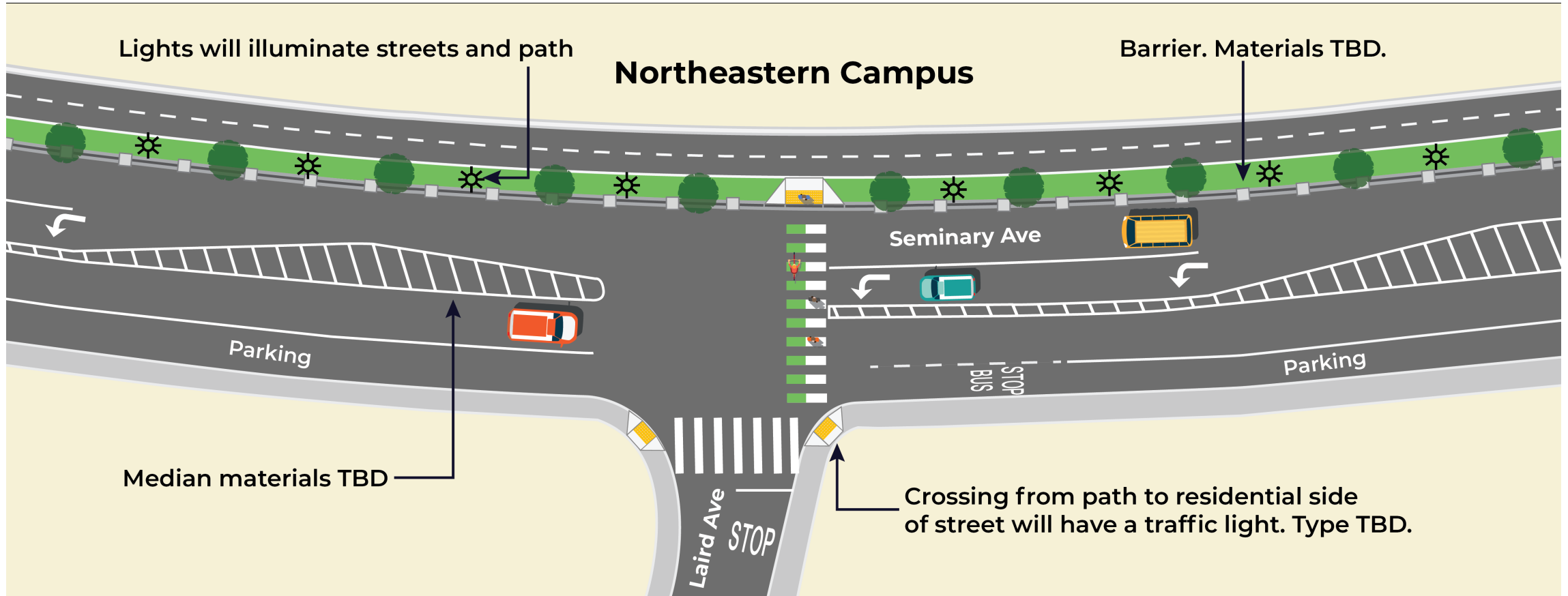

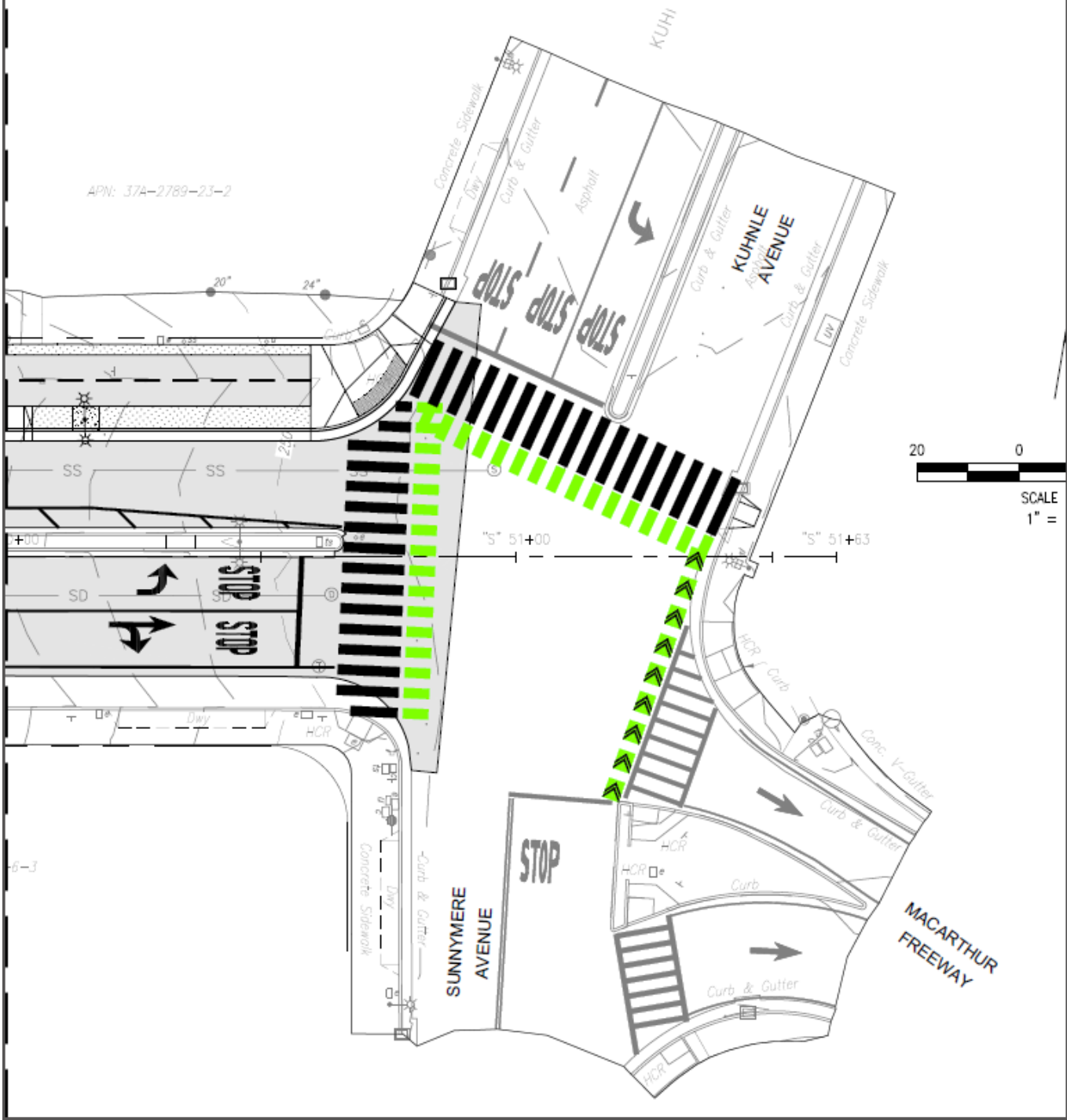

Oak Knoll Development Project



SCALE IN FEET
1" = 20'-0"

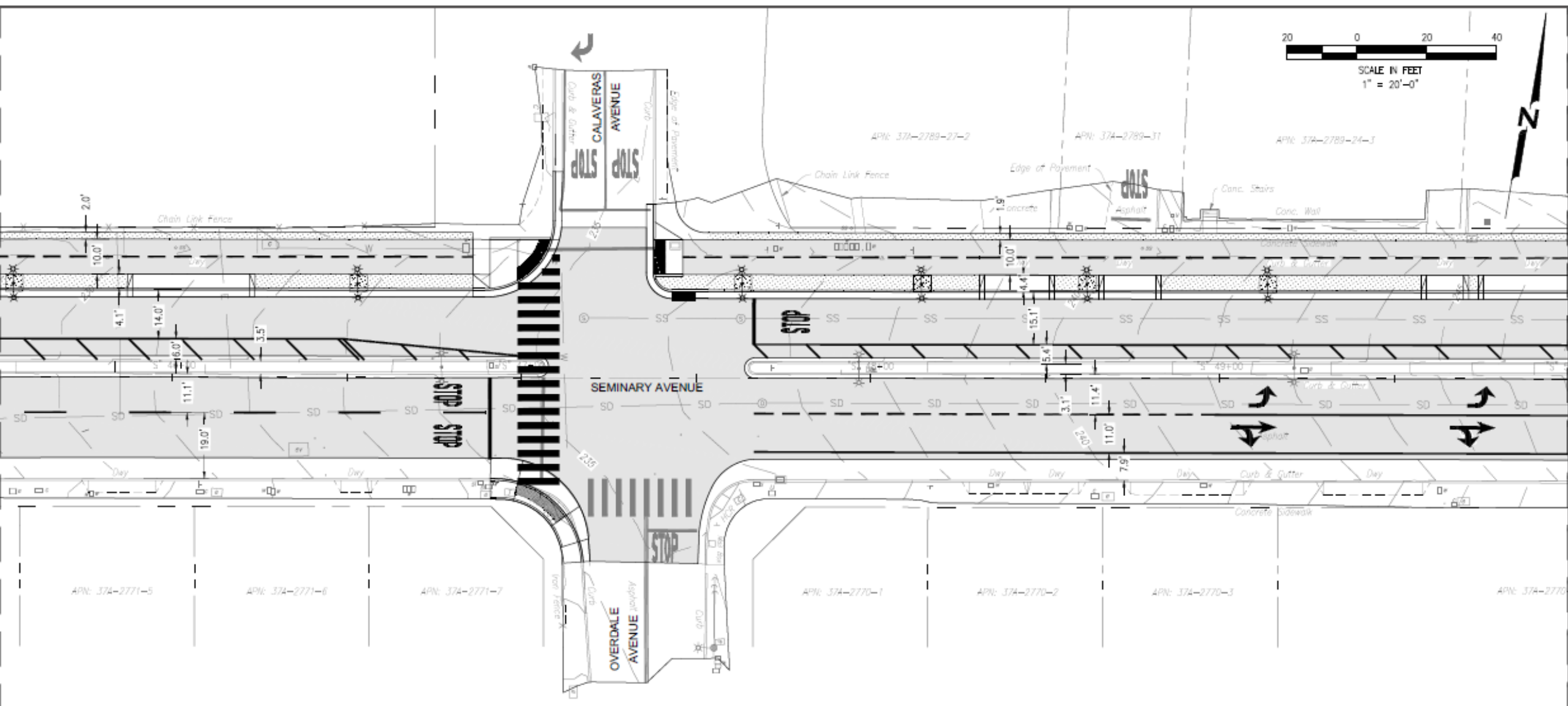

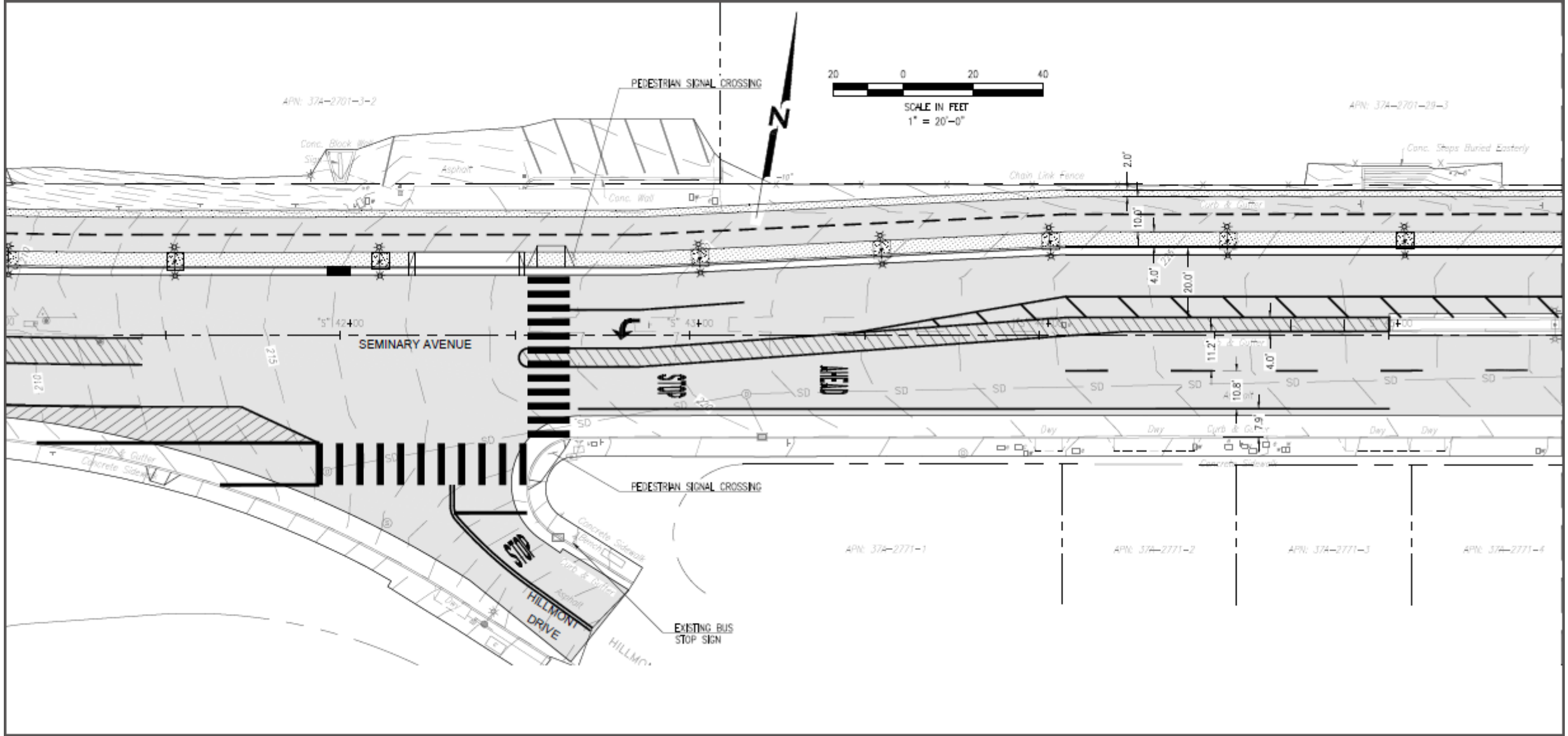

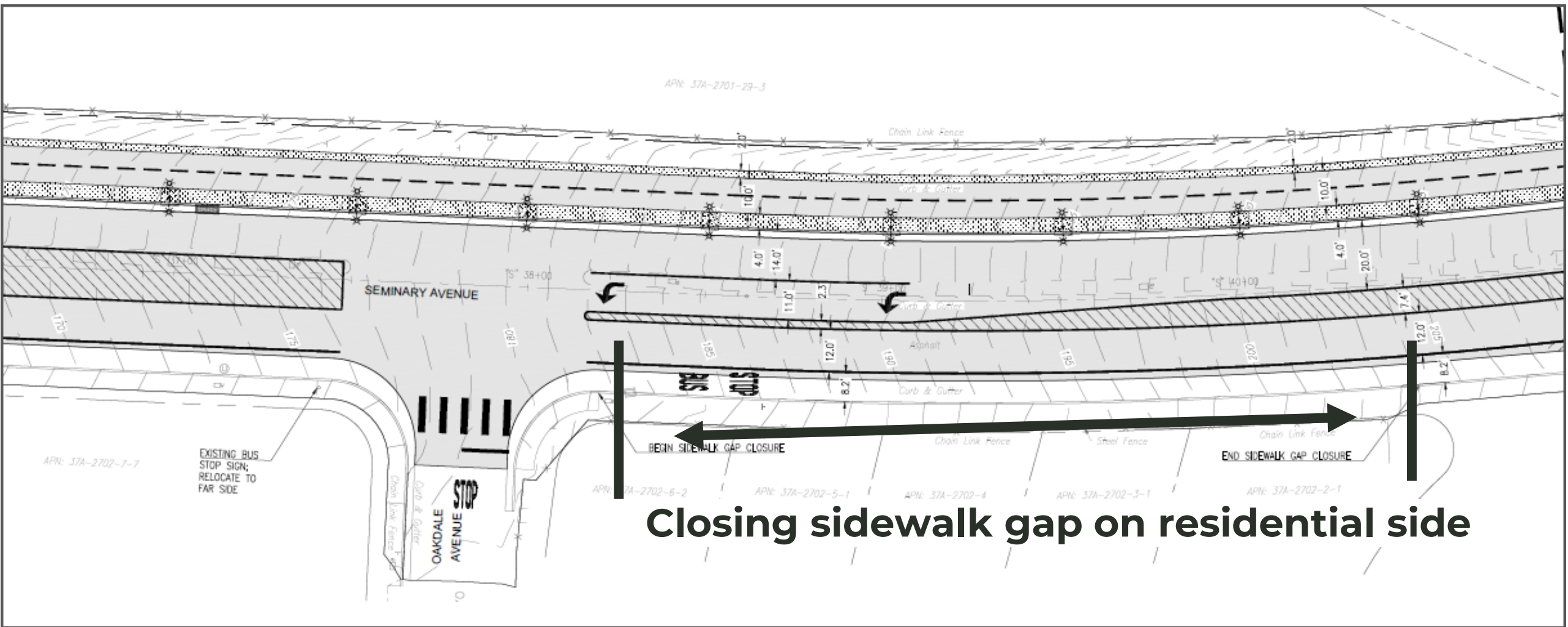

Closing sidewalk gap on residential side

Barrier between Class 1 path and street Materials TBD

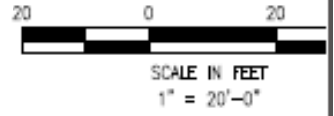

Closing sidewalk gap on residential side



SCALE IN FEET
1" = 20'-0"

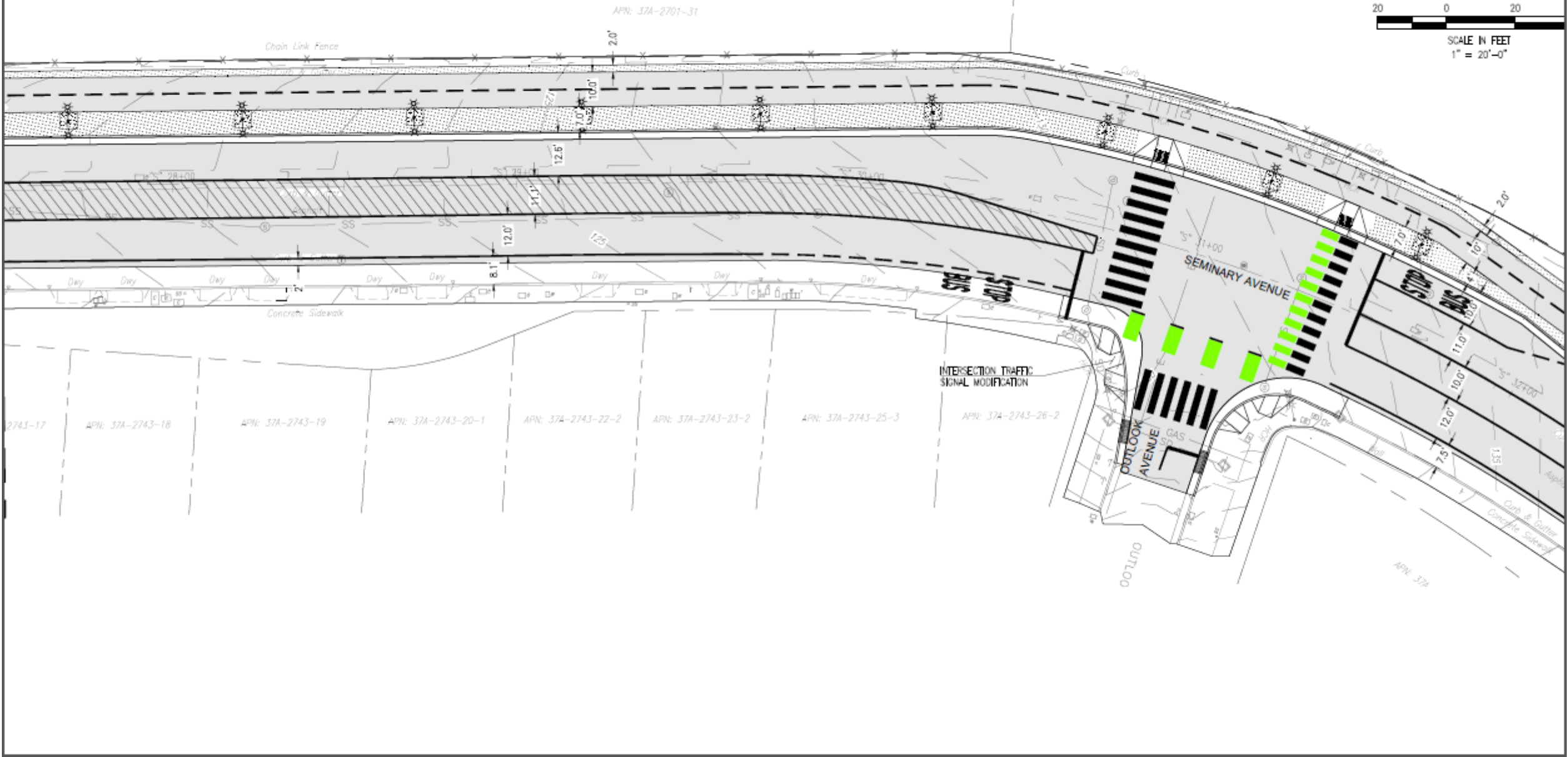

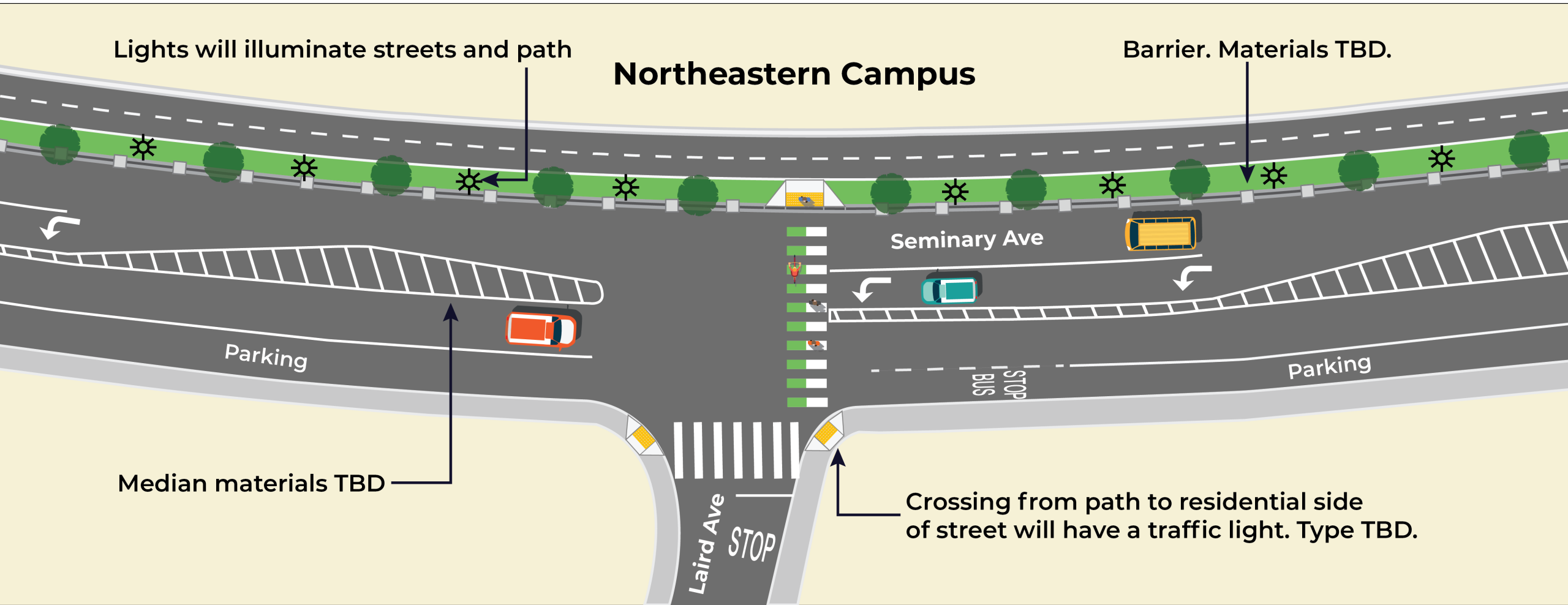

Lights will illuminate streets and path

Northeastern Campus

Barrier. Materials TBD.

Seminary Ave

Parking

Parking

Median materials TBD

Laird Ave
STOP

BUS STOP

Crossing from path to residential side of street will have a traffic light. Type TBD.



SCALE IN FEET
1" = 20'-0"

APN: 37A-2701

MATCHLINE "S" 19+50 SEE SHEET 4

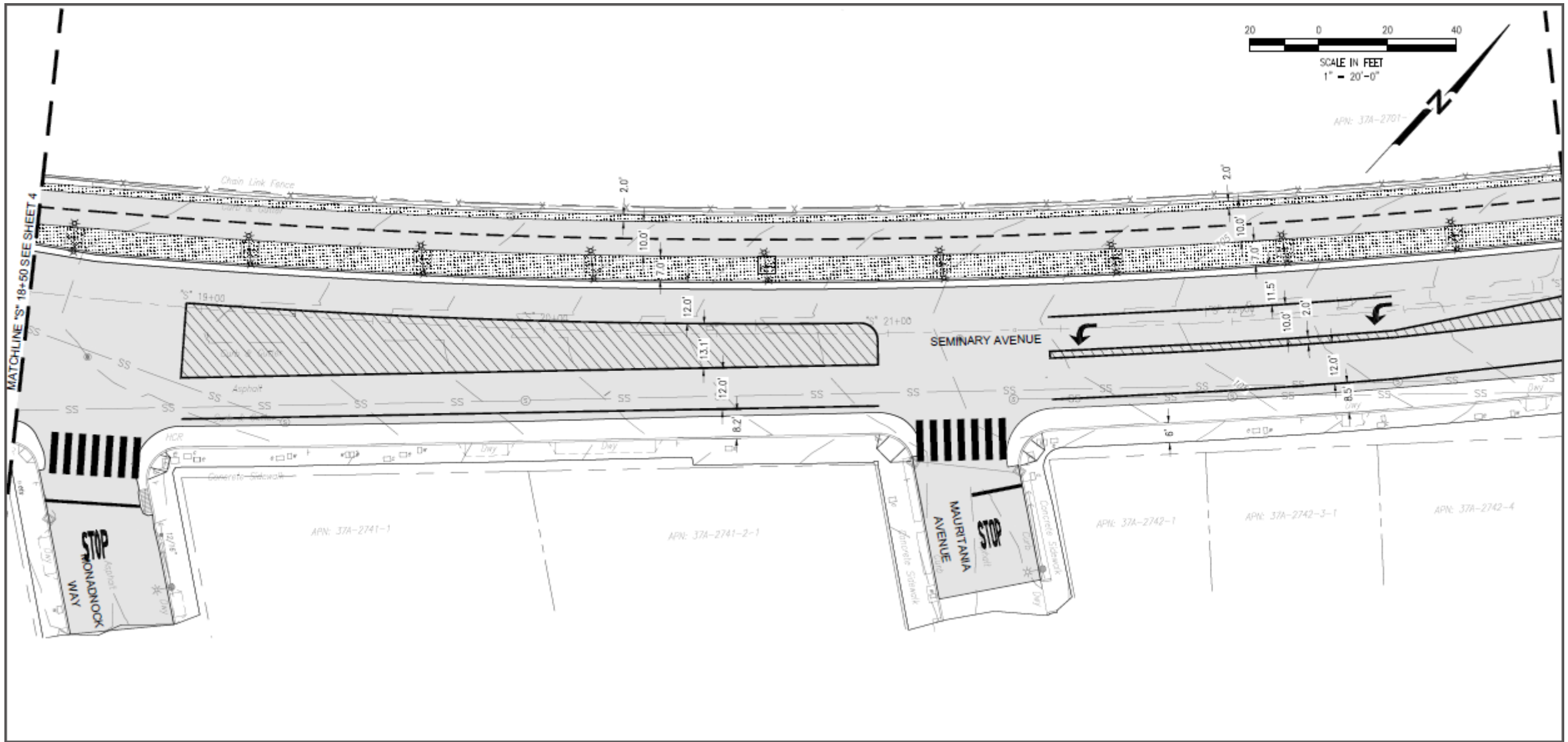

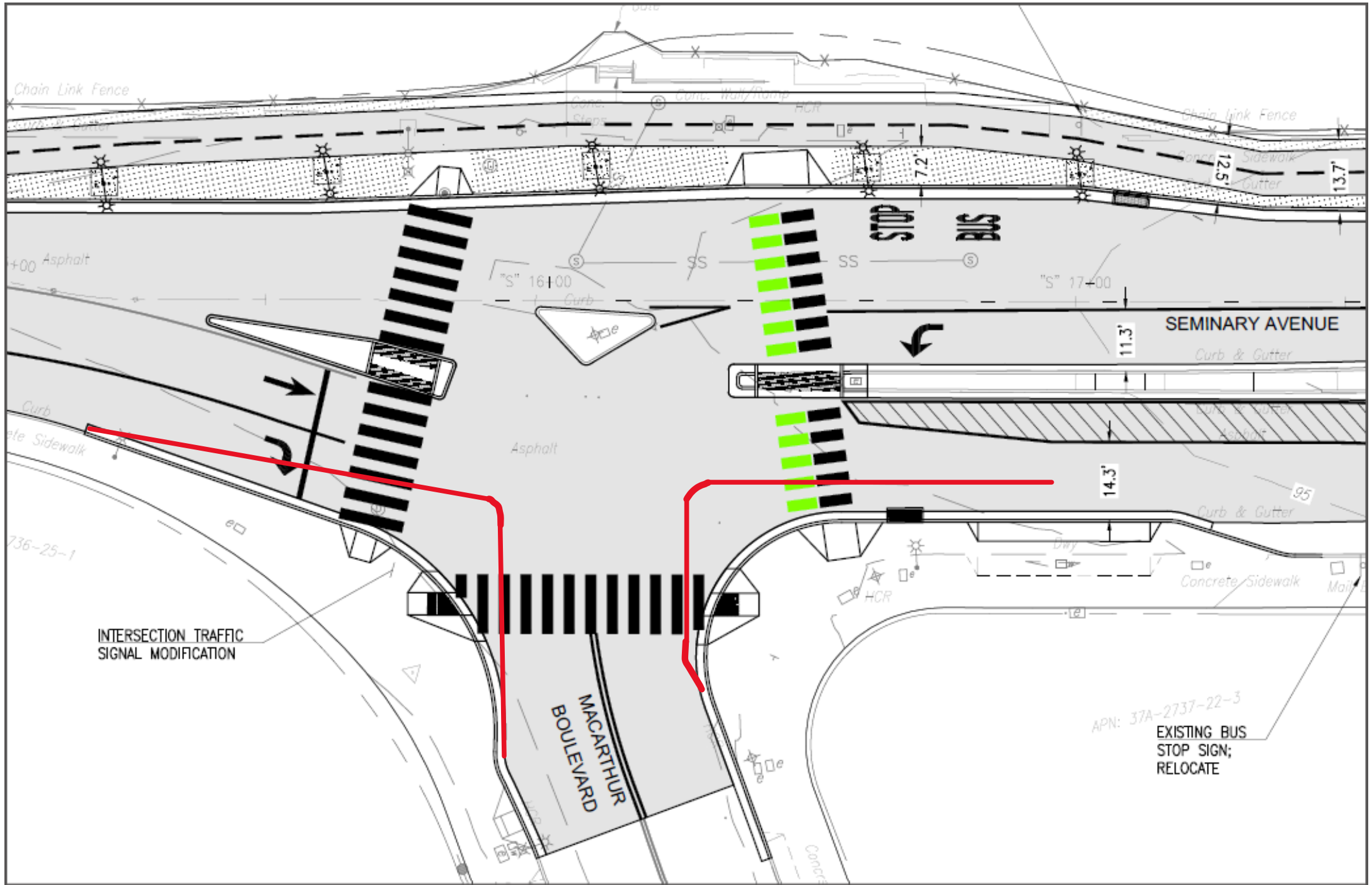

INTERSECTION TRAFFIC
SIGNAL MODIFICATION

MACARTHUR
BOULEVARD

SEMINARY AVENUE

APN: 37A-2737-22-3
EXISTING BUS
STOP SIGN;
RELOCATE

STOP
BUS

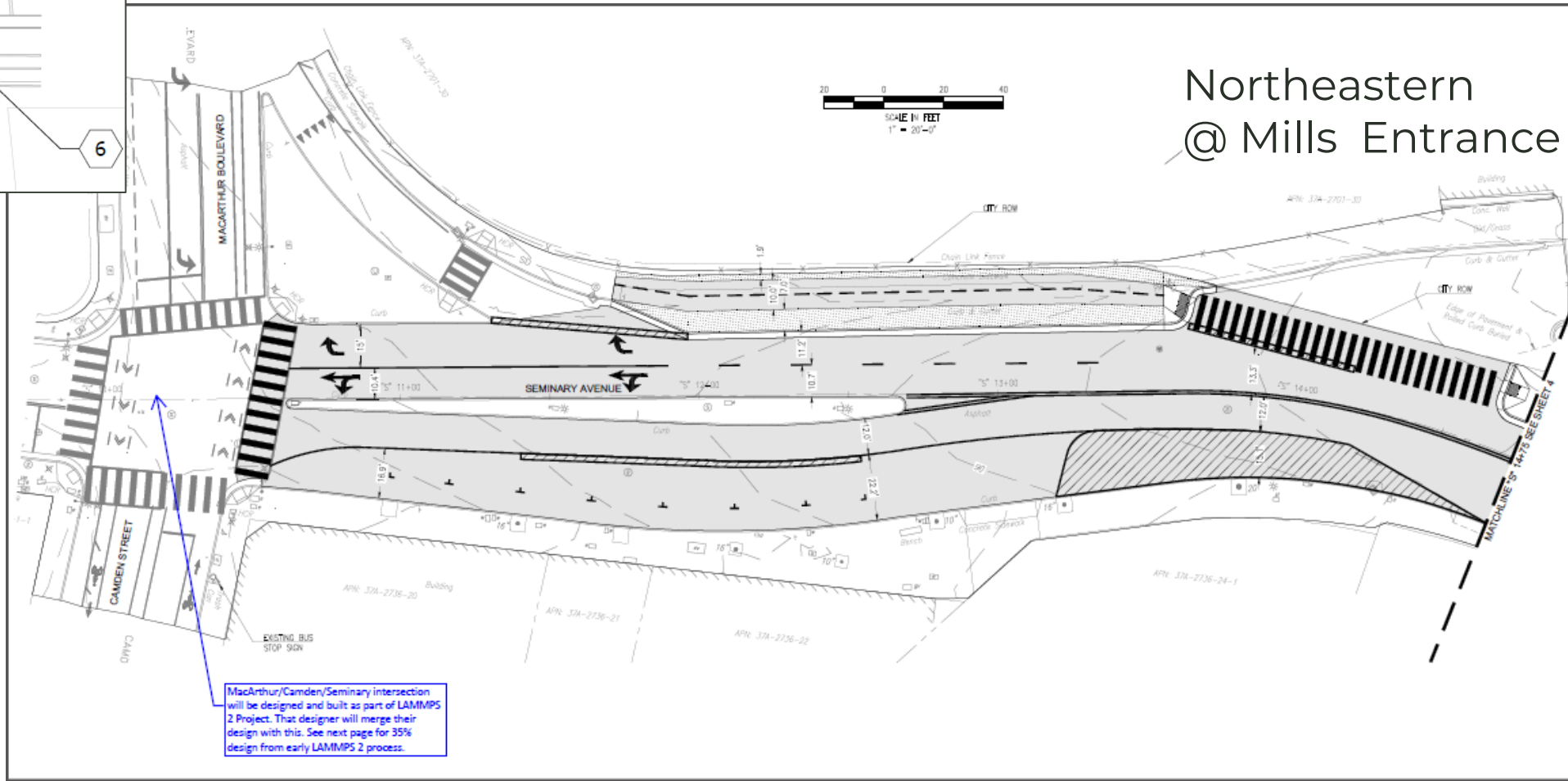
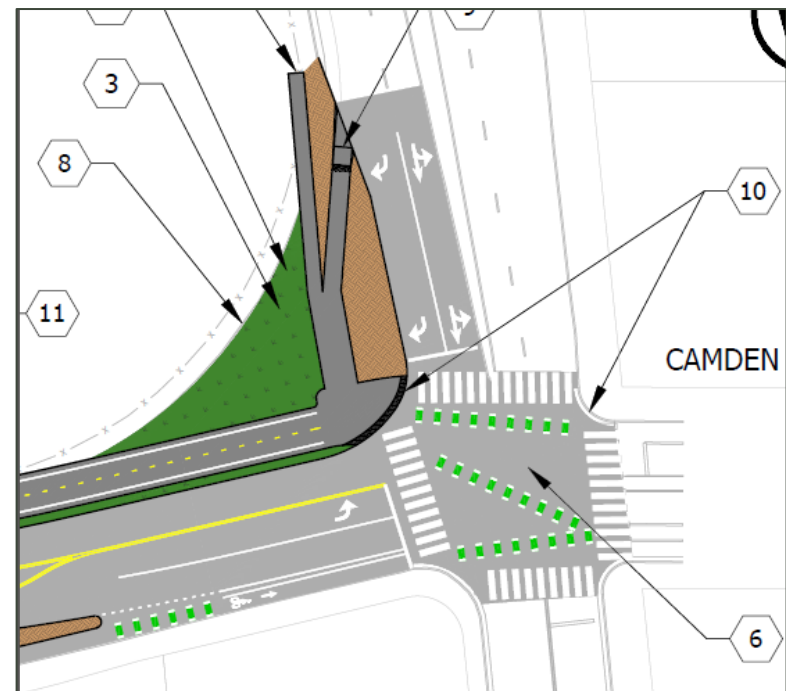

MacArthur/Camden/Seminary intersection will be designed and built as part of LAMMPS 2 Project. That designer will merge their design with this. See next page for 35% design from early LAMMPS 2 process.

More Information

Cathy DeLuca

CDeLuca@oaklandca.gov

510-519-1605

Sign up for updates on the Seminary Avenue Project webpage:

<https://www.oaklandca.gov/projects/lammmps3>



City of
Oakland

Department of
Transportation