

SECTION A-A

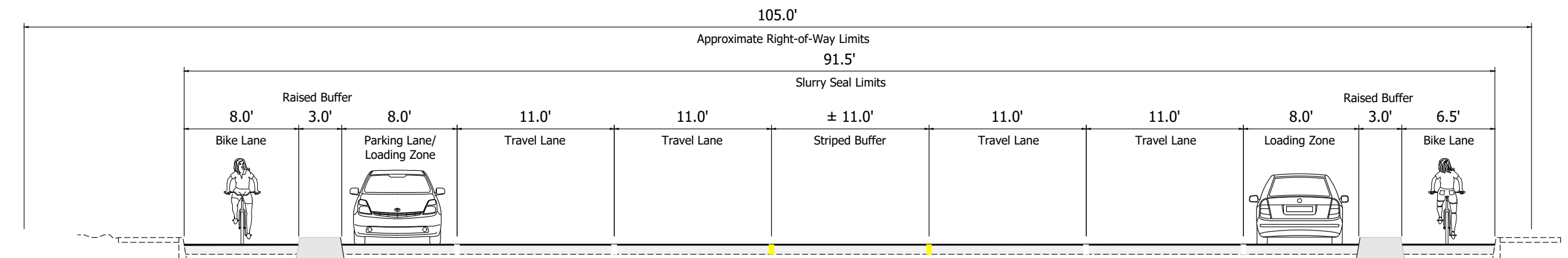

SECTION B-B

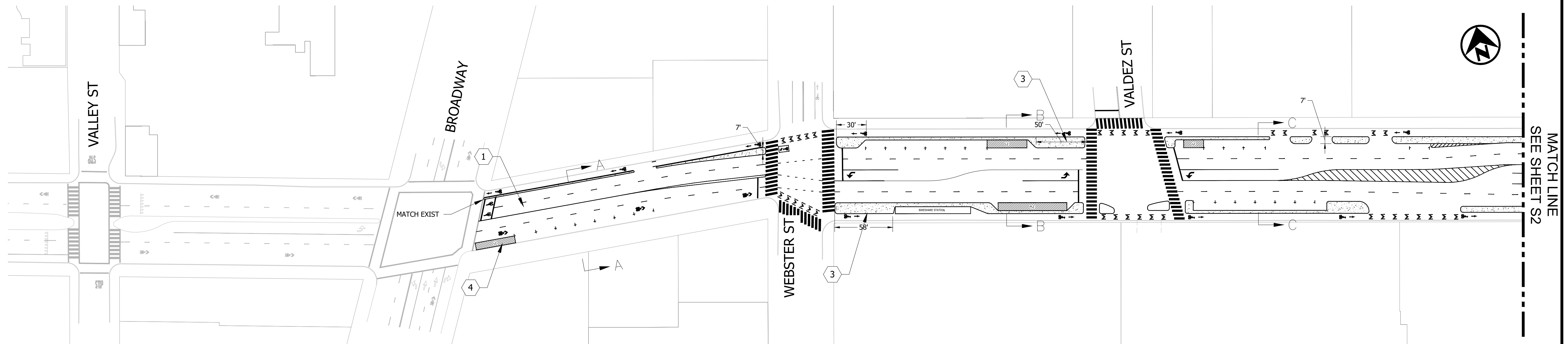

MATCH LINE SEE SHEET S2

CONSTRUCTION NOTES

- 1 CRACK TREATMENT AND SLURRY SEAL EXISTING PAVEMENT FULL WIDTH (TYP)
- 2 REMOVE EXISTING CURB EXTENSION AND INSTALL NEW CURB RAMP, SIDEWALK, AND CURB
- 3 AC TRANSIT BUS STOP; INSTALL BUS BOARDING ISLAND, LENGTH AS SHOWN
- 4 LOADING ZONE "LZ" OR PASSENGER LOADING ZONE "PLZ" (TYP)
- 5 EXISTING RRFB
- 6 AC TRANSIT BUS BOARDING ISLAND; BY OTHER PROJECTS
- 7 NEW DRAINAGE FACILITY
- 8 ADD PEDESTRIAN SIGNAL HEAD AND STRIPED CROSSWALK
- 9 POTENTIAL RECONSTRUCTION/ RECONFIGURATION OF SLIP LANE FROM MACARTHUR TO EB GRAND
- 10 RAMP UP/DOWN TO SIDEWALK LEVEL; AC TRANSIT BUS STOP

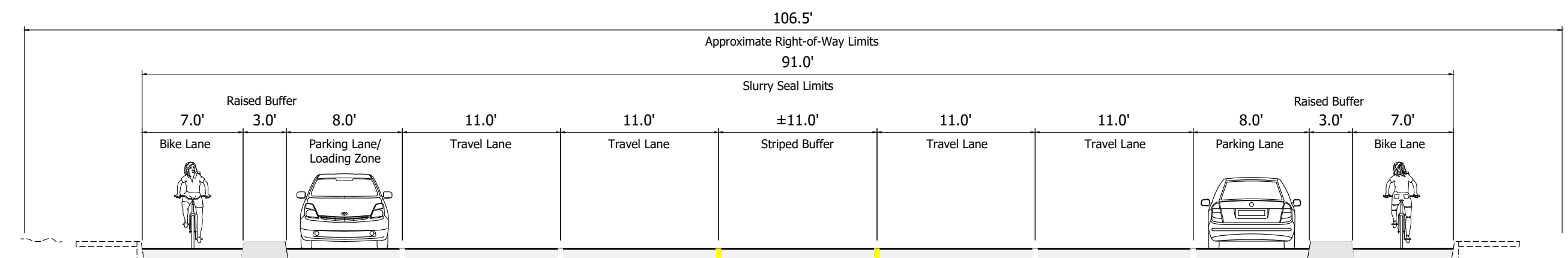

SECTION C-C



	 155 GRAND AVENUE, SUITE 505 OAKLAND, CA 94612 P 510.839.1742 F 510.839.0871	GRAND AVENUE	 CITY OF OAKLAND BUREAU OF ENGINEERING AND CONSTRUCTION SERVICES 250 FRANK OGAWA PLAZA, SUITE 4314 * OAKLAND, CA 94612 (510) 238-3437 * FAX (510) 238-7227 PROJECT NO. _____	CIVIL ENGINEER RCE NO. _____ EXP. _____ CHECKED BY JGA DESIGNED BY MGA DRAWN BY KKD	<table border="1" style="width: 100%; border-collapse: collapse;"> <thead> <tr> <th>No.</th> <th>DATE</th> <th>BY</th> <th>REFERENCE</th> </tr> </thead> <tbody> <tr><td> </td><td> </td><td> </td><td> </td></tr> <tr><td> </td><td> </td><td> </td><td> </td></tr> <tr><td> </td><td> </td><td> </td><td> </td></tr> </tbody> </table>	No.	DATE	BY	REFERENCE													35% CONCEPT PLAN NOT FOR CONSTRUCTION	S1	SCALE: HOR. 1" = 50' VERT. _____ DATE: 10/06/2023 SHEET NO. 1 OF 5
No.	DATE	BY	REFERENCE																					

DRAWING NAME: H:\2022\2521 - Oakland Transportation On-Call 2018\009 - Oak 35% Design\Grand Ave\design_CD\2521_009G_CD_SIGN&STRIP.dwg
 PLOT DATE: 10/05/23
 PLOTTED BY: Kkd

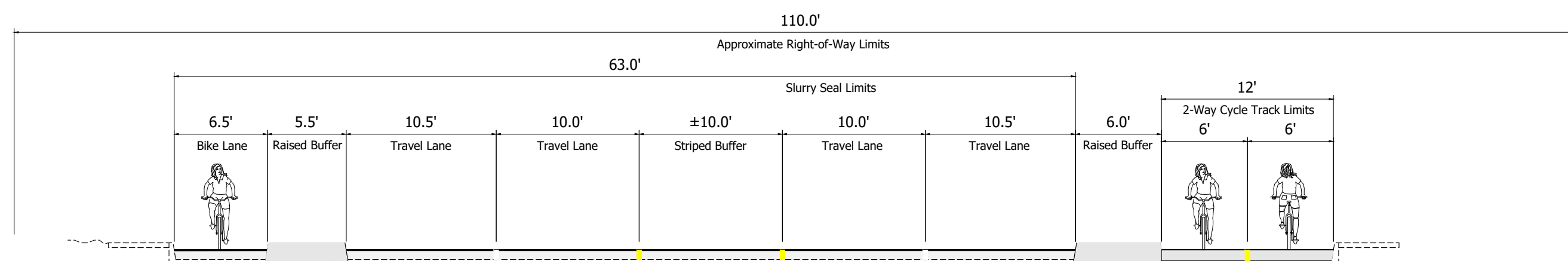

SECTION A-A

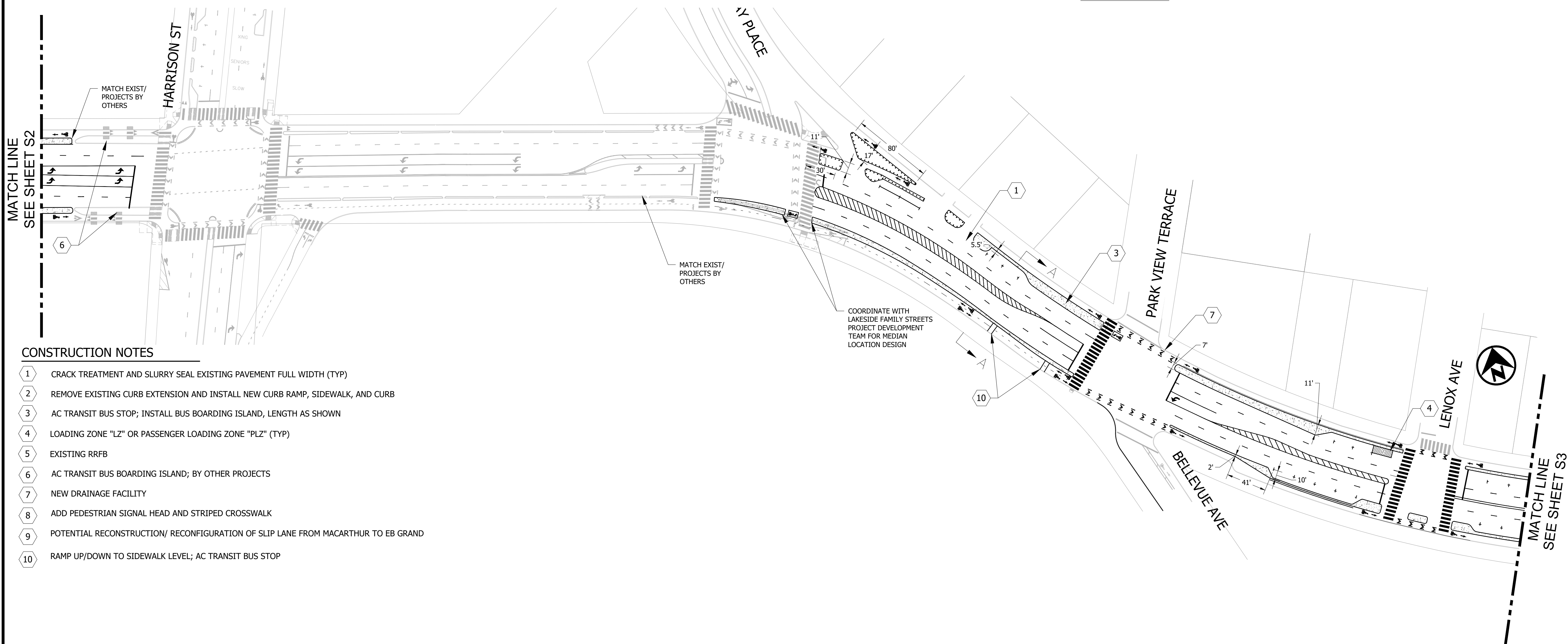

CONSTRUCTION NOTES

- 1 CRACK TREATMENT AND SLURRY SEAL EXISTING PAVEMENT FULL WIDTH (TYP)
- 2 REMOVE EXISTING CURB EXTENSION AND INSTALL NEW CURB RAMP, SIDEWALK, AND CURB
- 3 AC TRANSIT BUS STOP; INSTALL BUS BOARDING ISLAND, LENGTH AS SHOWN
- 4 LOADING ZONE "LZ" OR PASSENGER LOADING ZONE "PLZ" (TYP)
- 5 EXISTING RRFB
- 6 AC TRANSIT BUS BOARDING ISLAND; BY OTHER PROJECTS
- 7 NEW DRAINAGE FACILITY
- 8 ADD PEDESTRIAN SIGNAL HEAD AND STRIPED CROSSWALK
- 9 POTENTIAL RECONSTRUCTION/ RECONFIGURATION OF SLIP LANE FROM MACARTHUR TO EB GRAND
- 10 RAMP UP/DOWN TO SIDEWALK LEVEL; AC TRANSIT BUS STOP



 155 GRAND AVENUE, SUITE 505 OAKLAND, CA 94612 P 510.839.1742 F 510.839.0871	GRAND AVENUE	 CITY OF OAKLAND BUREAU OF ENGINEERING AND CONSTRUCTION SERVICES 250 FRANK OGAWA PLAZA, SUITE 4314 * OAKLAND, CA 94612 (510) 238-3437 * FAX (510) 238-7227 PROJECT NO. _____	CIVIL ENGINEER	No.	DATE	BY	REFERENCE	35% CONCEPT PLAN NOT FOR CONSTRUCTION	S2	SCALE: HOR. 1" = 50' VERT. _____
			RCE NO. _____ EXP. _____							DATE: 10/06/2023

DRAWING NAME: H:\2022\2521 - Oakland Transportation On-Call 2018\009 - Oak 35% Design\Grand Ave\design_CD\2521_009G-CD-SIGN&STRIP.dwg
 PLOT DATE: 10/05/23
 PLOTTED BY: Kkd

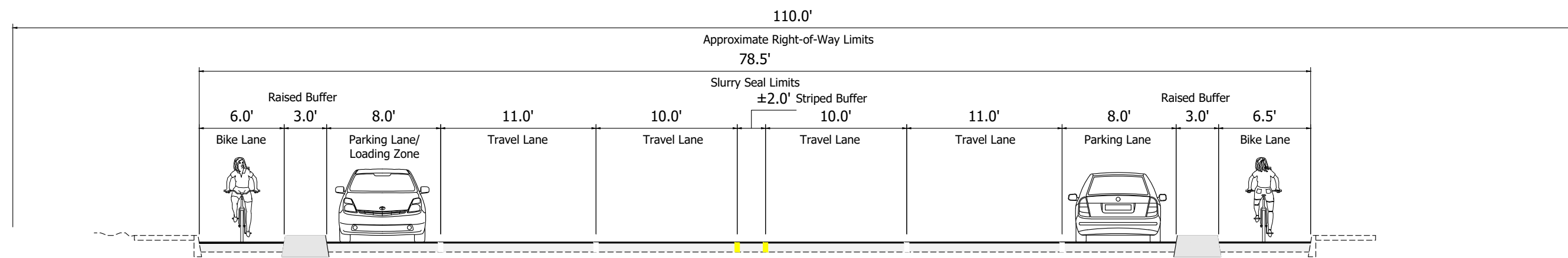

SECTION A-A

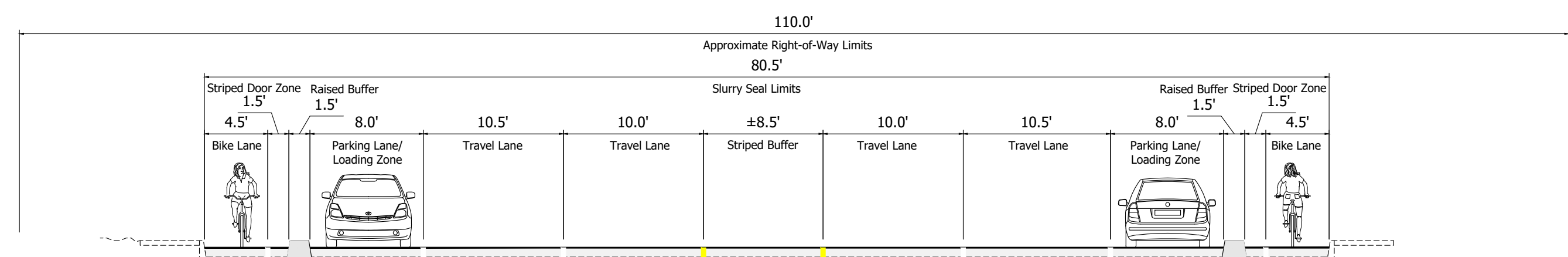

SECTION B-B

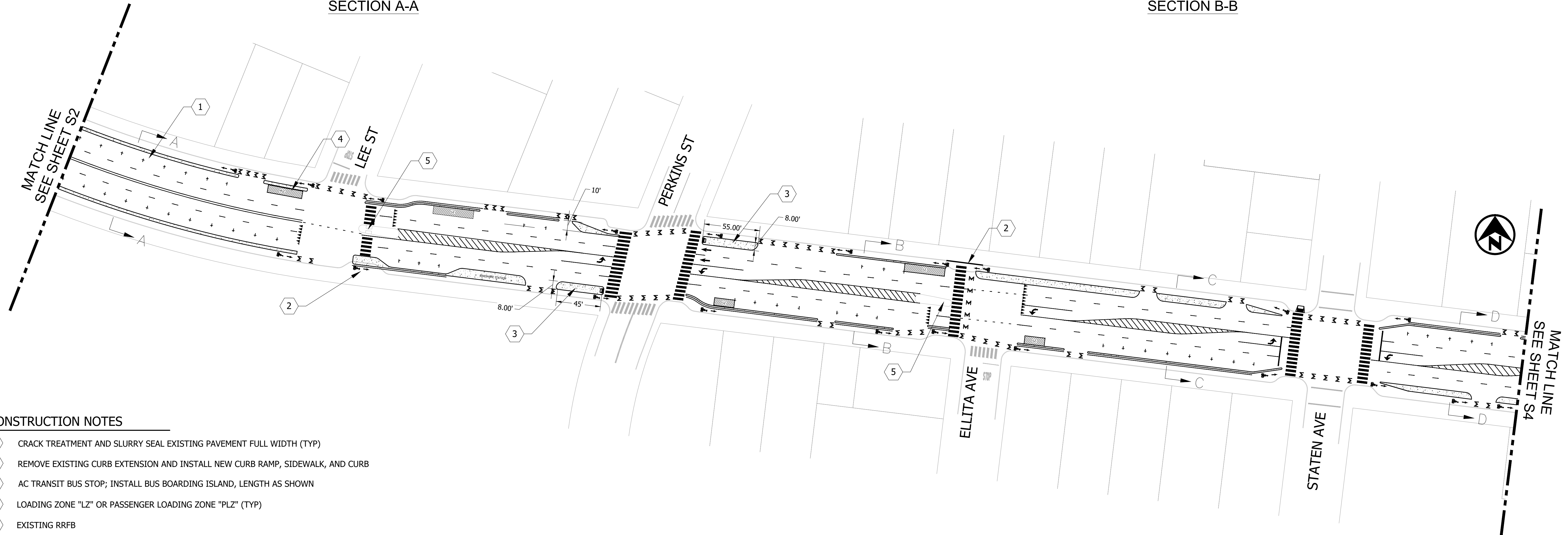

CONSTRUCTION NOTES

- 1 CRACK TREATMENT AND SLURRY SEAL EXISTING PAVEMENT FULL WIDTH (TYP)
- 2 REMOVE EXISTING CURB EXTENSION AND INSTALL NEW CURB RAMP, SIDEWALK, AND CURB
- 3 AC TRANSIT BUS STOP; INSTALL BUS BOARDING ISLAND, LENGTH AS SHOWN
- 4 LOADING ZONE "LZ" OR PASSENGER LOADING ZONE "PLZ" (TYP)
- 5 EXISTING RRFB
- 6 AC TRANSIT BUS BOARDING ISLAND; BY OTHER PROJECTS
- 7 NEW DRAINAGE FACILITY
- 8 ADD PEDESTRIAN SIGNAL HEAD AND STRIPED CROSSWALK
- 9 POTENTIAL RECONSTRUCTION/ RECONFIGURATION OF SLIP LANE FROM MACARTHUR TO EB GRAND
- 10 RAMP UP/DOWN TO SIDEWALK LEVEL; AC TRANSIT BUS STOP

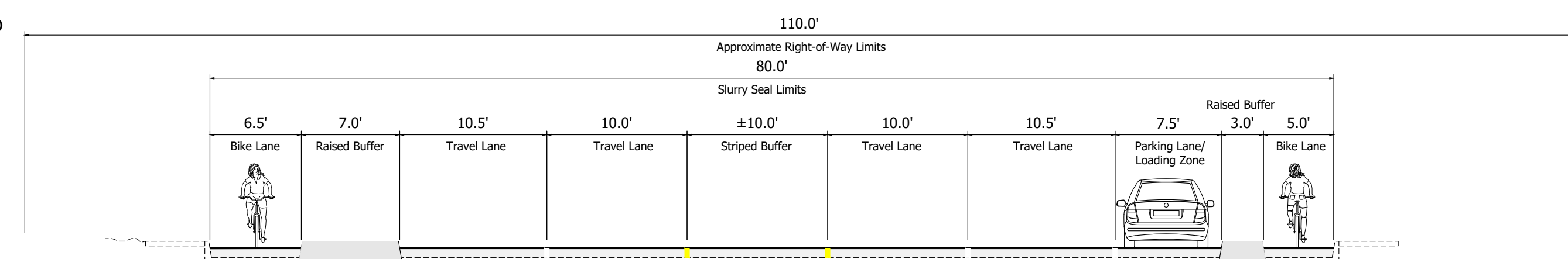

SECTION C-C

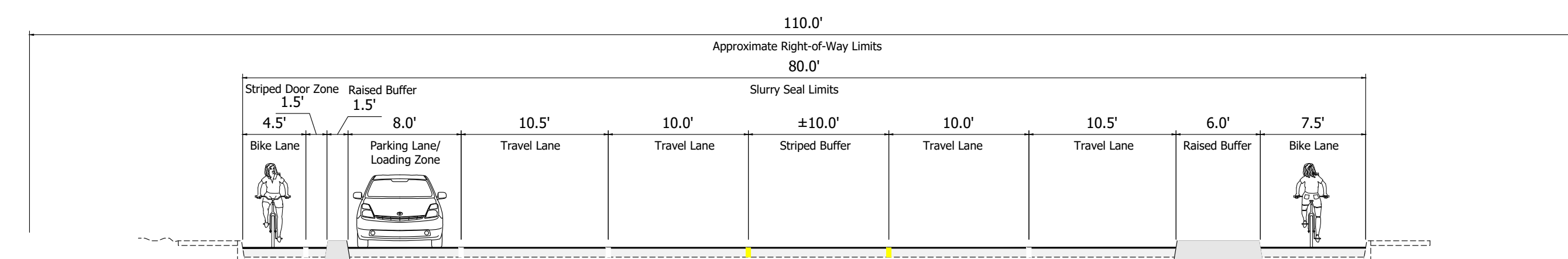

SECTION D-D



	 155 GRAND AVENUE, SUITE 505 OAKLAND, CA 94612 P 510.839.1742 F 510.839.0871	GRAND AVENUE	 CITY OF OAKLAND BUREAU OF ENGINEERING AND CONSTRUCTION SERVICES 250 FRANK OGAWA PLAZA, SUITE 4314 * OAKLAND, CA 94612 (510) 238-3437 * FAX (510) 238-7227 PROJECT NO. _____	CIVIL ENGINEER RCE NO. _____ EXP. _____ CHECKED BY JGA DESIGNED BY MGA DRAWN BY KKD	<table border="1" style="width: 100%; border-collapse: collapse;"> <thead> <tr> <th>No.</th> <th>DATE</th> <th>BY</th> <th>REFERENCE</th> </tr> </thead> <tbody> <tr><td> </td><td> </td><td> </td><td> </td></tr> <tr><td> </td><td> </td><td> </td><td> </td></tr> <tr><td> </td><td> </td><td> </td><td> </td></tr> </tbody> </table>	No.	DATE	BY	REFERENCE													35% CONCEPT PLAN NOT FOR CONSTRUCTION	<div style="font-size: 2em; font-weight: bold;">S3</div>	SCALE: HOR. 1" = 50' VERT. _____ DATE: 10/06/2023 SHEET NO. 4 OF 5
No.	DATE	BY	REFERENCE																					

DRAWING NAME: H:\2022\252521 - Oakland Transportation On-Call 2018\009 - Oak 35% Design\Grand Ave\design_CD\252521_009G_CD_SIGN&STRIP.dwg
 PLOT DATE: 10/05/23
 PLOTTED BY: Kkd

CONSTRUCTION NOTES

- 1 CRACK TREATMENT AND SLURRY SEAL EXISTING PAVEMENT FULL WIDTH (TYP)
- 2 REMOVE EXISTING CURB EXTENSION AND INSTALL NEW CURB RAMP, SIDEWALK, AND CURB
- 3 AC TRANSIT BUS STOP; INSTALL 40' BUS BOARDING ISLAND, LENGTH AS SHOWN
- 4 LOADING ZONE "LZ" OR PASSENGER LOADING ZONE "PLZ" (TYP)
- 5 EXISTING RRFB
- 6 AC TRANSIT BUS BOARDING ISLAND; BY OTHER PROJECTS
- 7 NEW DRAINAGE FACILITY
- 8 ADD PEDESTRIAN SIGNAL HEAD AND STRIPED CROSSWALK
- 9 POTENTIAL RECONSTRUCTION/ RECONFIGURATION OF SLIP LANE FROM MACARTHUR TO EB GRAND
- 10 RAMP UP/DOWN TO SIDEWALK LEVEL; AC TRANSIT BUS STOP

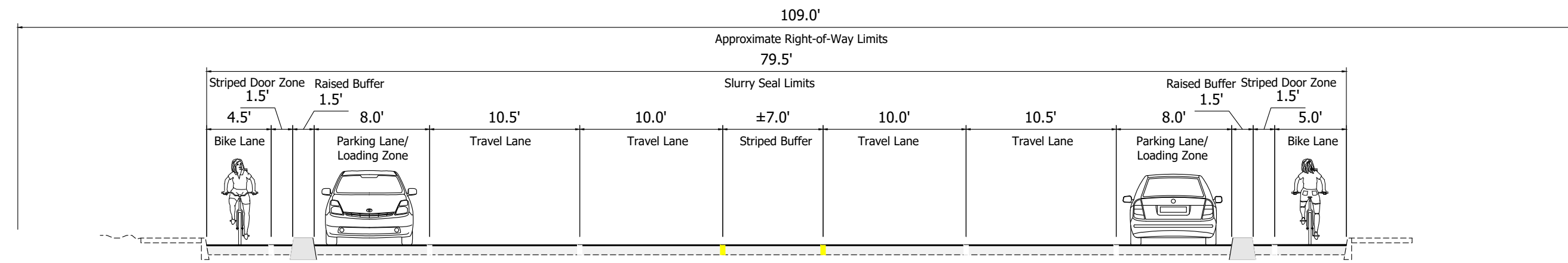

SECTION A-A

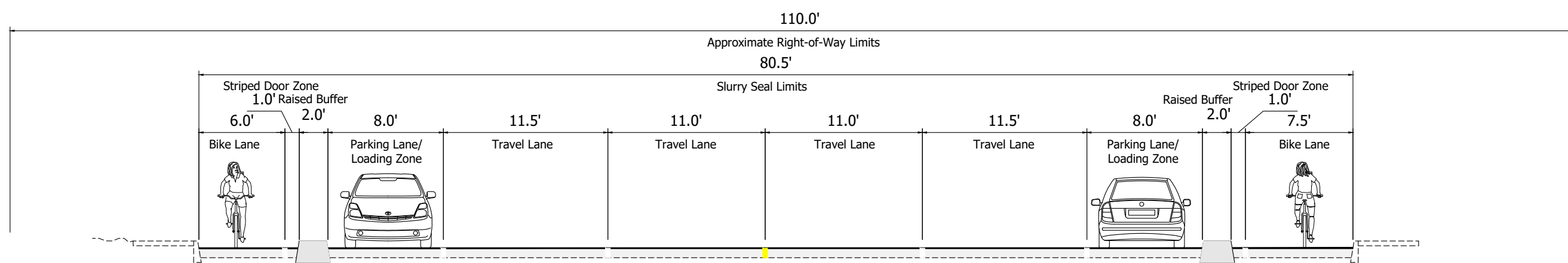

SECTION B-B

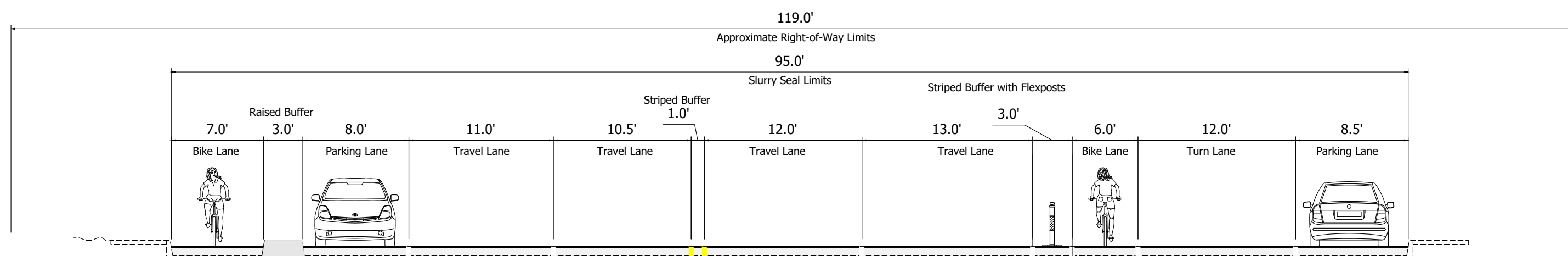

SECTION C-C

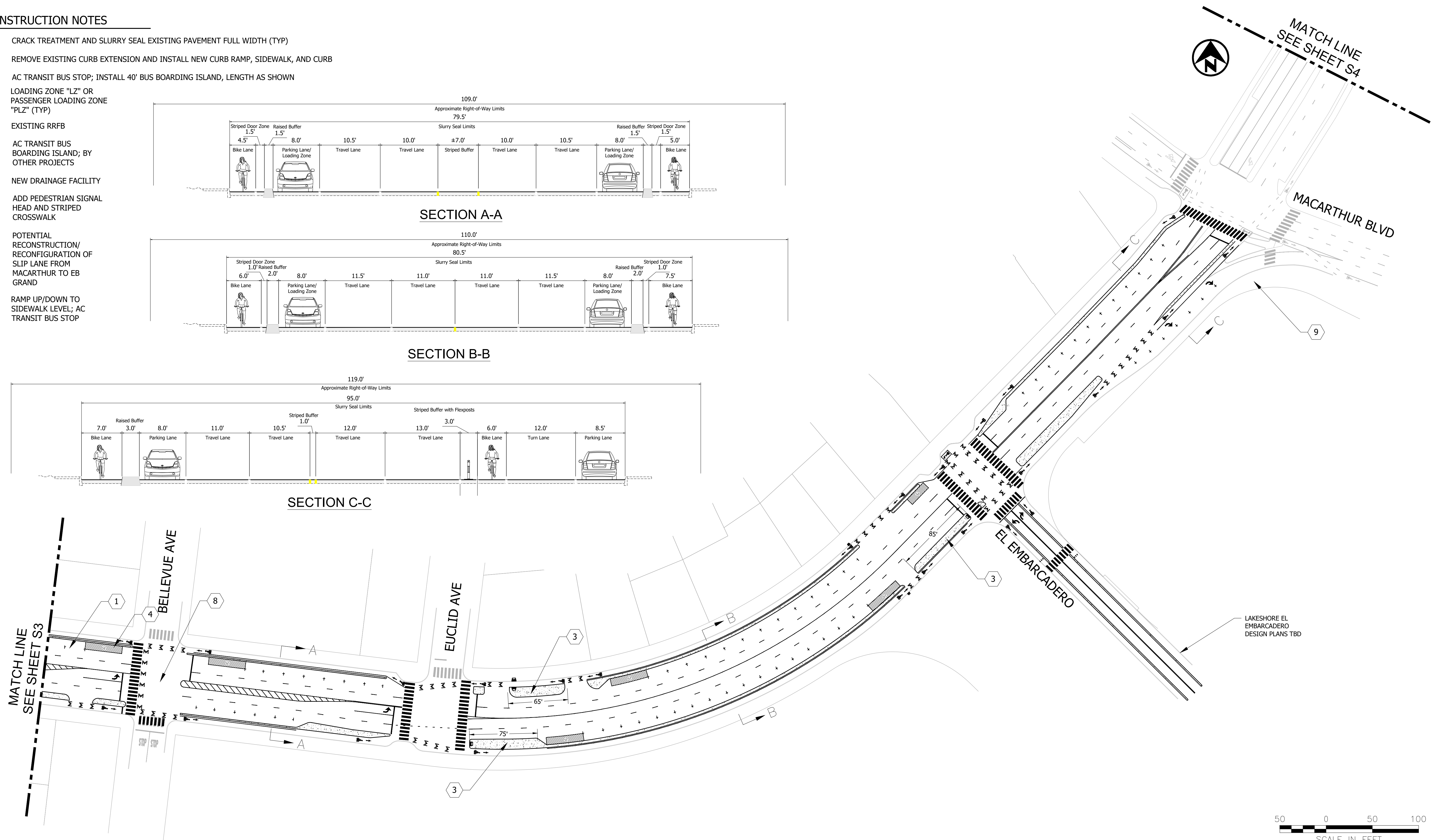

<p>KITTELSON & ASSOCIATES 155 GRAND AVENUE, SUITE 505 OAKLAND, CA 94612 P 510.839.1742 F 510.839.0871</p>	<p>GRAND AVENUE</p>	<p>CITY OF OAKLAND BUREAU OF ENGINEERING AND CONSTRUCTION SERVICES 250 FRANK OGAWA PLAZA, SUITE 4314 * OAKLAND, CA 94612 (510) 238-3437 * FAX (510) 238-7227 PROJECT NO. _____</p>	CIVIL ENGINEER RCE NO. _____ EXP. _____ CHECKED BY JGA DESIGNED BY MGA DRAWN BY KKD	<table border="1" style="width: 100%; border-collapse: collapse;"> <thead> <tr> <th>No.</th> <th>DATE</th> <th>BY</th> <th>REFERENCE</th> </tr> </thead> <tbody> <tr><td> </td><td> </td><td> </td><td> </td></tr> <tr><td> </td><td> </td><td> </td><td> </td></tr> <tr><td> </td><td> </td><td> </td><td> </td></tr> </tbody> </table>	No.	DATE	BY	REFERENCE													<p>35% CONCEPT PLAN NOT FOR CONSTRUCTION</p>	<p>S4</p>	SCALE: HOR. 1" = 50' VERT. _____ DATE: 10/06/2023 SHEET NO. 4 OF 5
			No.	DATE	BY	REFERENCE																	
<p>PRELIMINARY</p>																							

DRAWING NAME: H:\22\22521 - Oakland Transportation On-Call 2018\009 - Oak 35% Design\Grand Ave\design_CD\22521_009G_CD_SIGN&STRIP.dwg
 PLOT DATE: 10/05/23
 PLOTTED BY: Kkd

DEPENDING ON PROJECT PHASING,
EITHER CALTRANS PROJECT OR
GRAND AVE PROJECT TO CLOSE
RIGHT TURN SLIP LANE

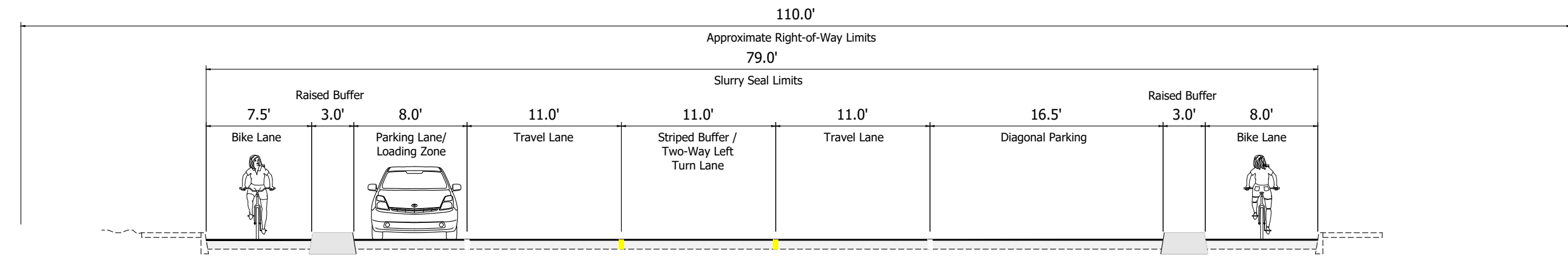

SECTION A-A

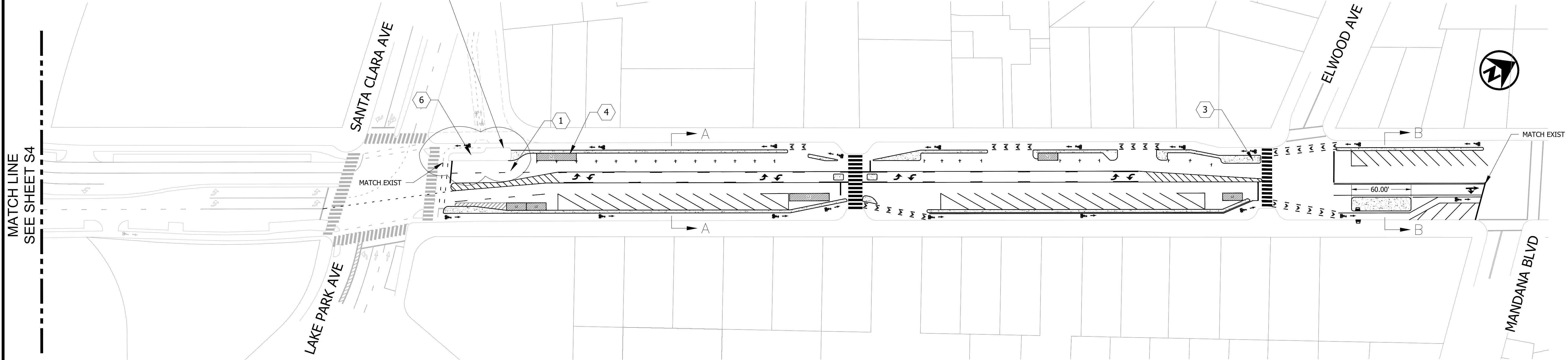

CONSTRUCTION NOTES

- 1 CRACK TREATMENT AND SLURRY SEAL EXISTING PAVEMENT FULL WIDTH (TYP)
- 2 REMOVE EXISTING CURB EXTENSION AND INSTALL NEW CURB RAMP, SIDEWALK, AND CURB
- 3 AC TRANSIT BUS STOP; INSTALL BUS BOARDING ISLAND, LENGTH AS SHOWN
- 4 LOADING ZONE "LZ" OR PASSENGER LOADING ZONE "PLZ" (TYP)
- 5 EXISTING RRFB
- 6 AC TRANSIT BUS BOARDING ISLAND; BY OTHER PROJECTS
- 7 NEW DRAINAGE FACILITY
- 8 ADD PEDESTRIAN SIGNAL HEAD AND STRIPED CROSSWALK
- 9 POTENTIAL RECONSTRUCTION/ RECONFIGURATION OF SLIP LANE FROM MACARTHUR TO EB GRAND
- 10 RAMP UP/DOWN TO SIDEWALK LEVEL; AC TRANSIT BUS STOP

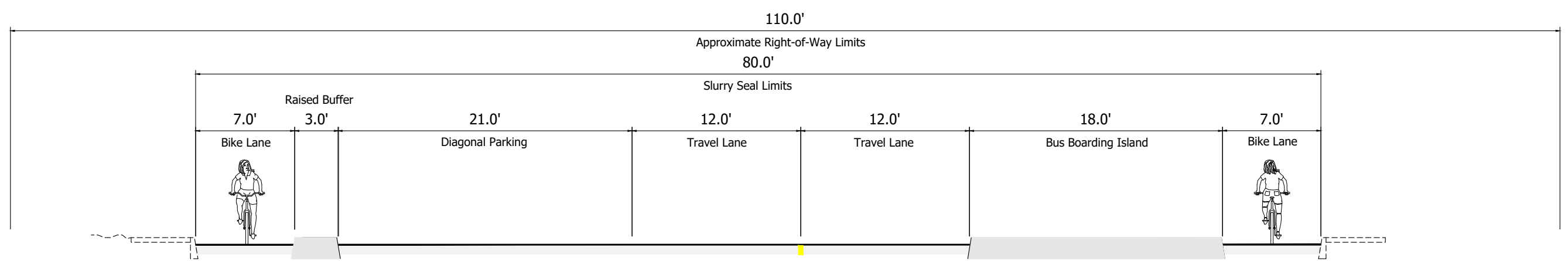

SECTION B-B



	 155 GRAND AVENUE, SUITE 505 OAKLAND, CA 94612 P 510.839.1742 F 510.839.0871	GRAND AVENUE	 CITY OF OAKLAND BUREAU OF ENGINEERING AND CONSTRUCTION SERVICES 250 FRANK OGAWA PLAZA, SUITE 4314 * OAKLAND, CA 94612 (510) 238-3437 * FAX (510) 238-7227 PROJECT NO. _____	CIVIL ENGINEER RCE NO. _____ EXP. _____ CHECKED BY JGA DESIGNED BY MGA DRAWN BY KKD	<table border="1" style="width: 100%; border-collapse: collapse;"> <thead> <tr> <th>No.</th> <th>DATE</th> <th>BY</th> <th>REFERENCE</th> </tr> </thead> <tbody> <tr><td> </td><td> </td><td> </td><td> </td></tr> <tr><td> </td><td> </td><td> </td><td> </td></tr> <tr><td> </td><td> </td><td> </td><td> </td></tr> </tbody> </table>	No.	DATE	BY	REFERENCE													35% CONCEPT PLAN NOT FOR CONSTRUCTION	S5	SCALE: HOR. 1" = 50' VERT. _____ DATE: 10/06/2023 SHEET NO. 5 OF 5
No.	DATE	BY	REFERENCE																					

DRAWING NAME: H:\2022\2521 - Oakland Transportation On-Call 2018\009 - Oak 35% Design\Grand Ave\design_CD\2521_009G-CD-SIGN&STRIP.dwg
 PLOT DATE: 10/05/23
 PLOTTED BY: Kkd