

# 14th Street Safety Project - Block by Block Plans

Investing in 14th Street as a community destination for safe strolling, shopping, and biking



City of  
Oakland

Department of  
Transportation

## BRIEF BACKGROUND:





In 2017 the City of Oakland won a **\$14 million** State grant to provide a once-in-a-generation investment in safety and community-driven aesthetic improvements on 14th Street From Brush Street to Lakeside Drive/Oak Street.

## BLOCK-BY-BLOCK PLANS

This presentation has detailed block-by-block plans for the project, starting from Brush Street to the west and ending at Oak Street/Lakeside Drive to the east. For a presentation with more background on the safety issues, project goals, parking management, and other information, please visit the website below and find the Project Presentation at the bottom center of page.



14th Street is the heart of Downtown Oakland, connecting neighborhoods and civic institutions. How can we use this \$14M grant to **welcome more people** to Downtown, **make them feel safe** and **connect them** to the cultural and commercial resources of our Town?

-  14th Street Safety Project Area
-  Bicycle Lane Network
-  Protected Bike Lane
-  Upcoming OakDOT Projects
-  Slow Streets Network



# 14th Street Safety Project - Block by Block Plans

Investing in 14th Street as a community destination for safe strolling, shopping, and biking



City of  
Oakland

Department of  
Transportation

## CURRENT PROPOSED PROJECT - BRUSH STREET TO CASTRO STREET

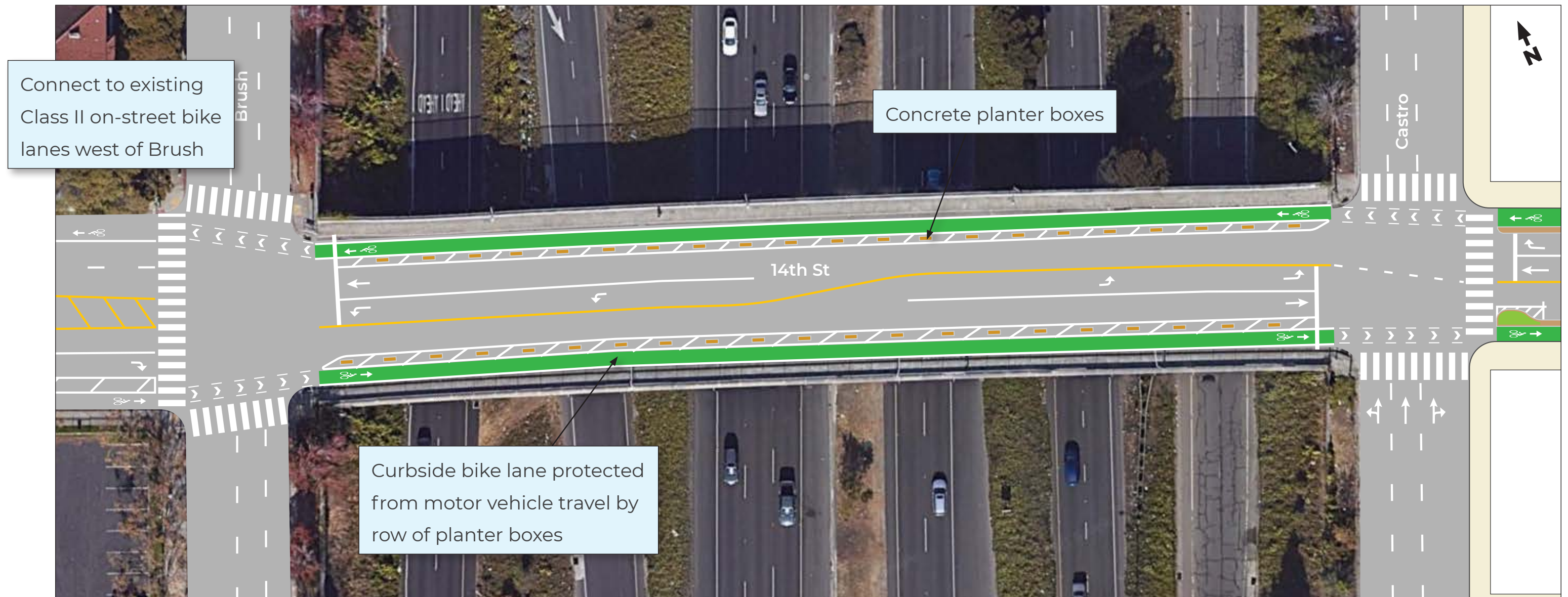

# 14th Street Safety Project - Block by Block Plans

Investing in 14th Street as a community destination for safe strolling, shopping, and biking



City of  
Oakland

Department of  
Transportation

## CURRENT PROPOSED PROJECT - CASTRO STREET TO MLK JR WAY

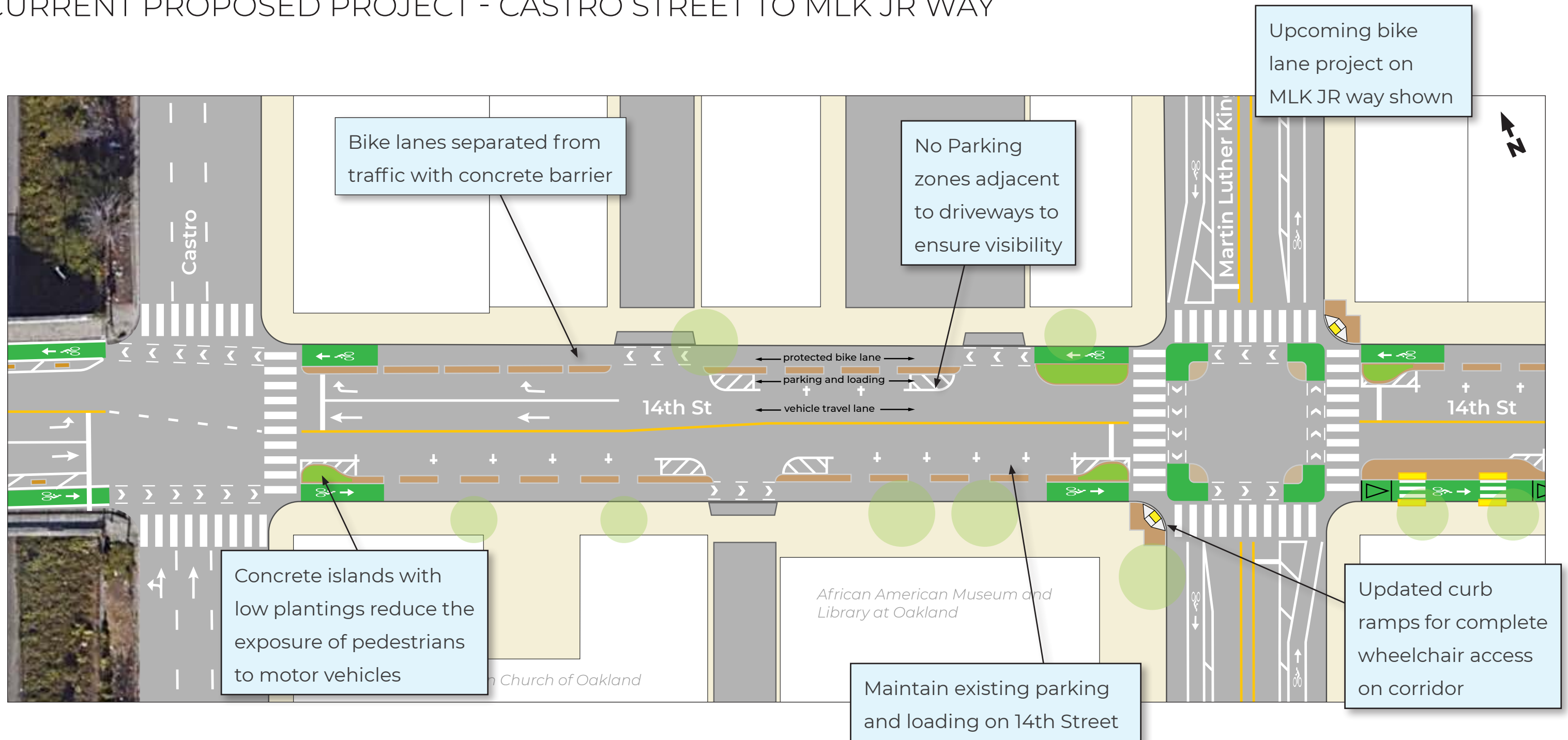

# 14th Street Safety Project - Block by Block Plans

Investing in 14th Street as a community destination for safe strolling, shopping, and biking



City of  
Oakland

Department of  
Transportation

## CURRENT PROPOSED PROJECT - MLK JR WAY TO JEFFERSON STREET

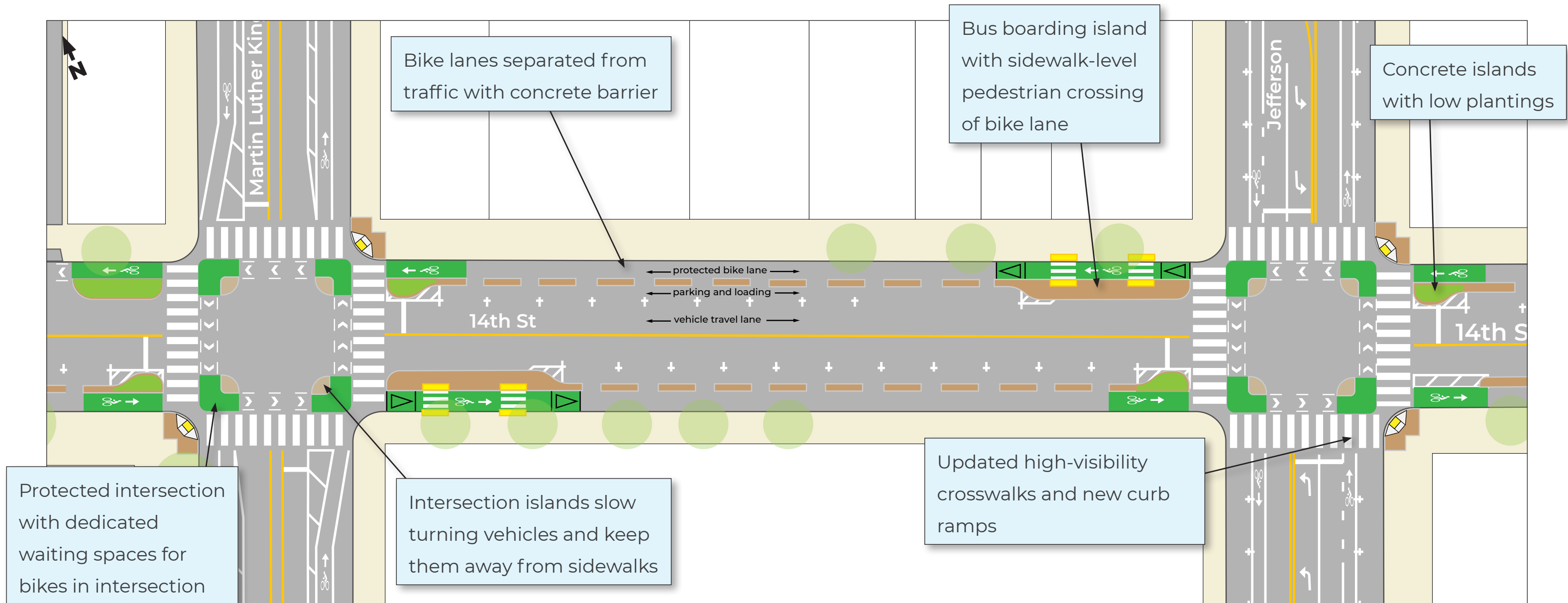



# 14th Street Safety Project - Block by Block Plans

Investing in 14th Street as a community destination for safe strolling, shopping, and biking



City of  
Oakland

Department of  
Transportation

## CURRENT PROPOSED PROJECT - JEFFERSON STREET TO CLAY STREET

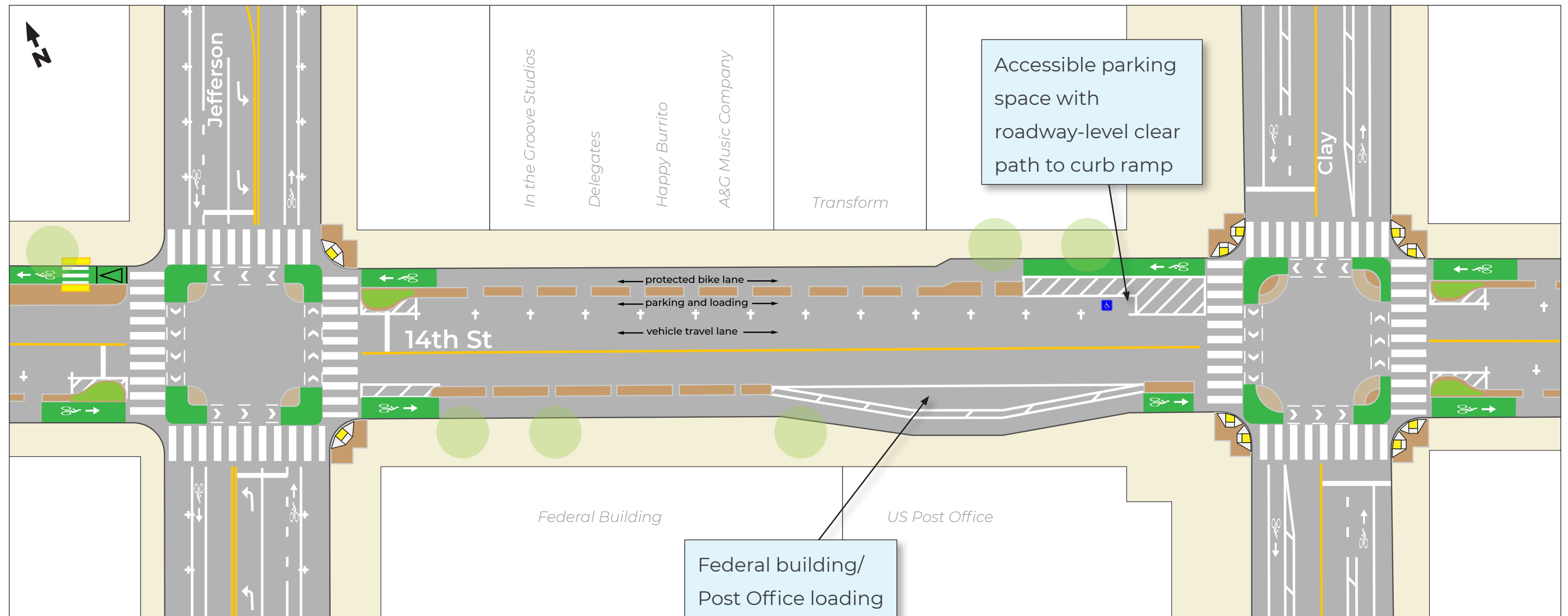

# 14th Street Safety Project - Block by Block Plans

Investing in 14th Street as a community destination for safe strolling, shopping, and biking



City of  
Oakland

Department of  
Transportation

## CURRENT PROPOSED PROJECT - CLAY STREET TO BROADWAY (1 OF 2)

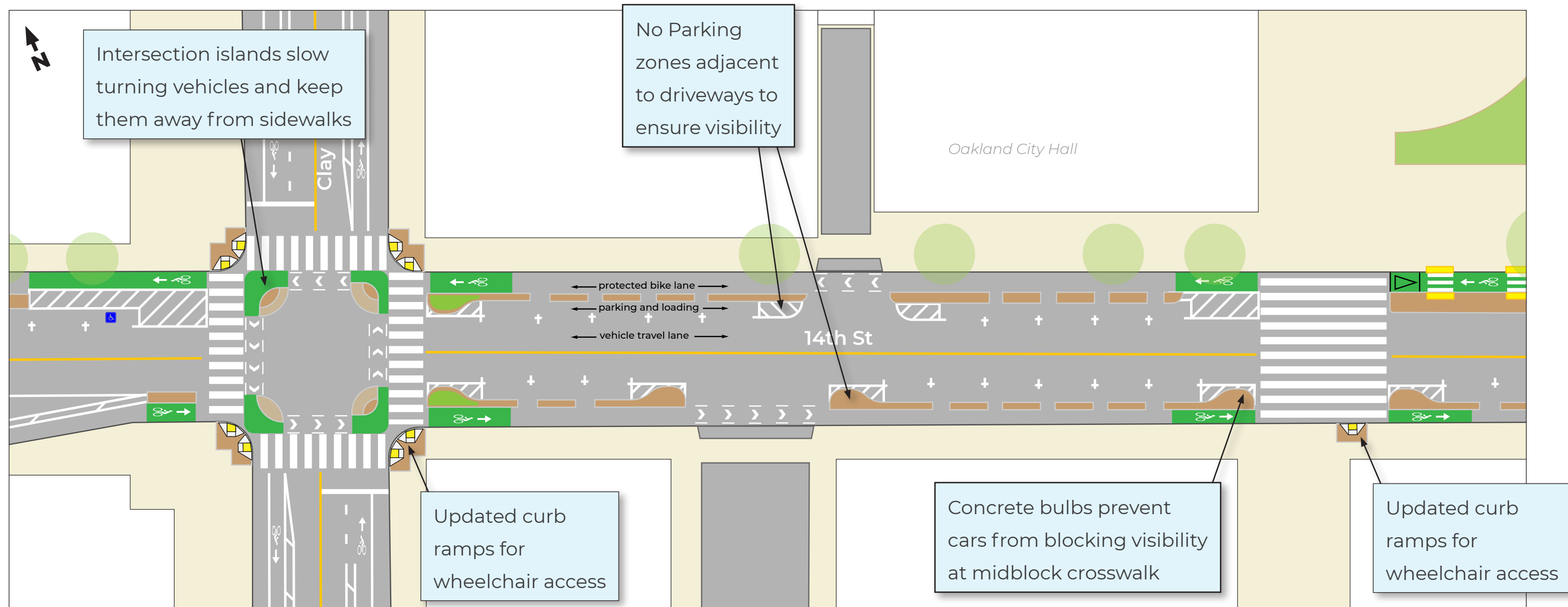

# 14th Street Safety Project - Block by Block Plans

Investing in 14th Street as a community destination for safe strolling, shopping, and biking



City of  
Oakland

Department of  
Transportation

## CURRENT PROPOSED PROJECT - CLAY STREET TO BROADWAY (2 OF 2)

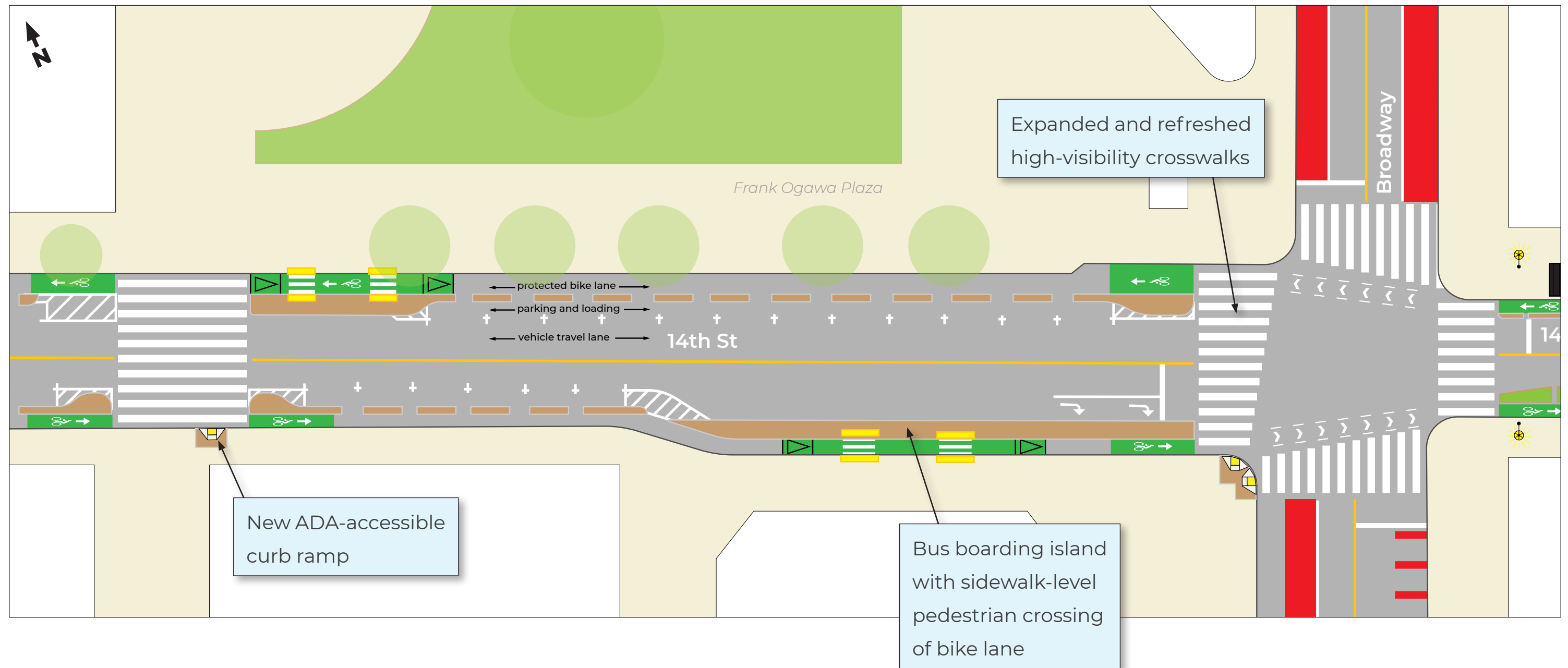

# 14th Street Safety Project - Block by Block Plans

Investing in 14th Street as a community destination for safe strolling, shopping, and biking



City of  
Oakland

Department of  
Transportation

## CURRENT PROPOSED PROJECT - BROADWAY TO FRANKLIN STREET

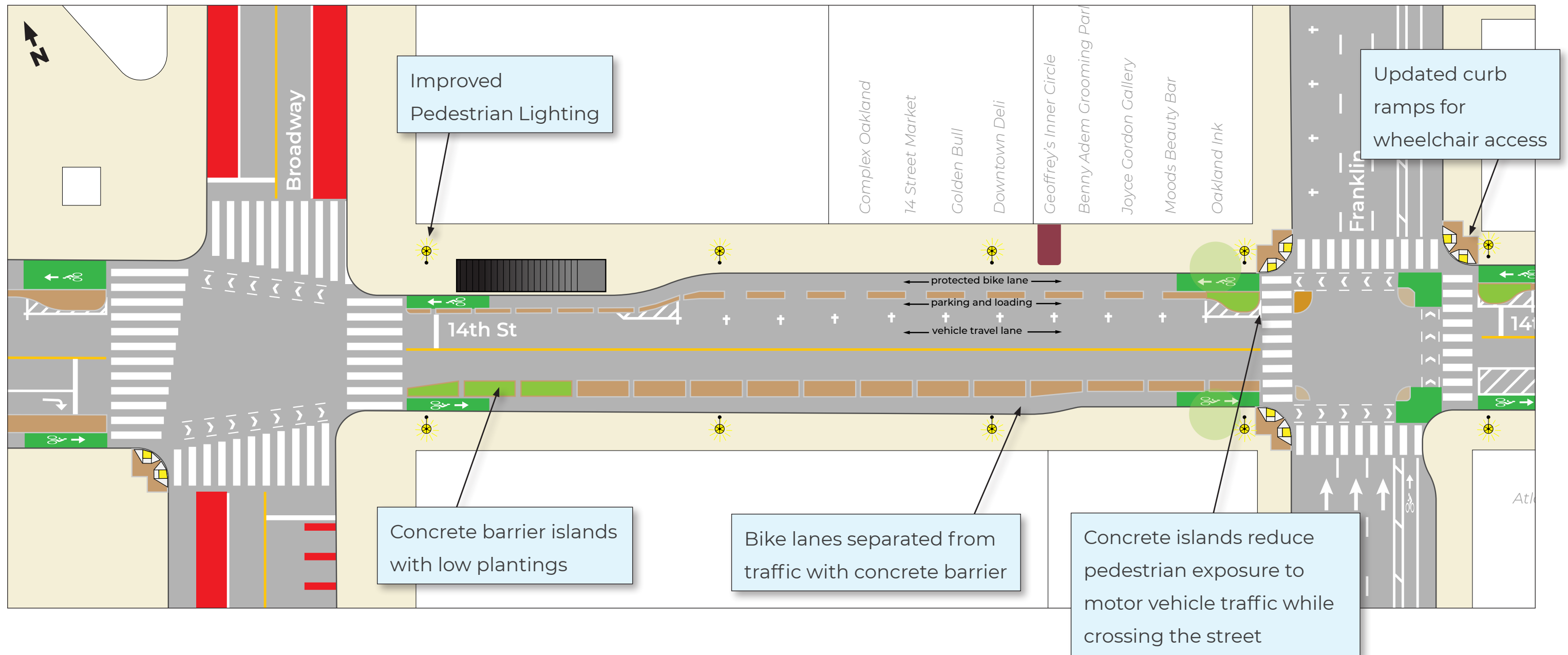



# 14th Street Safety Project - Block by Block Plans

Investing in 14th Street as a community destination for safe strolling, shopping, and biking



City of  
Oakland

Department of  
Transportation

## CURRENT PROPOSED PROJECT - FRANKLIN STREET TO WEBSTER STREET

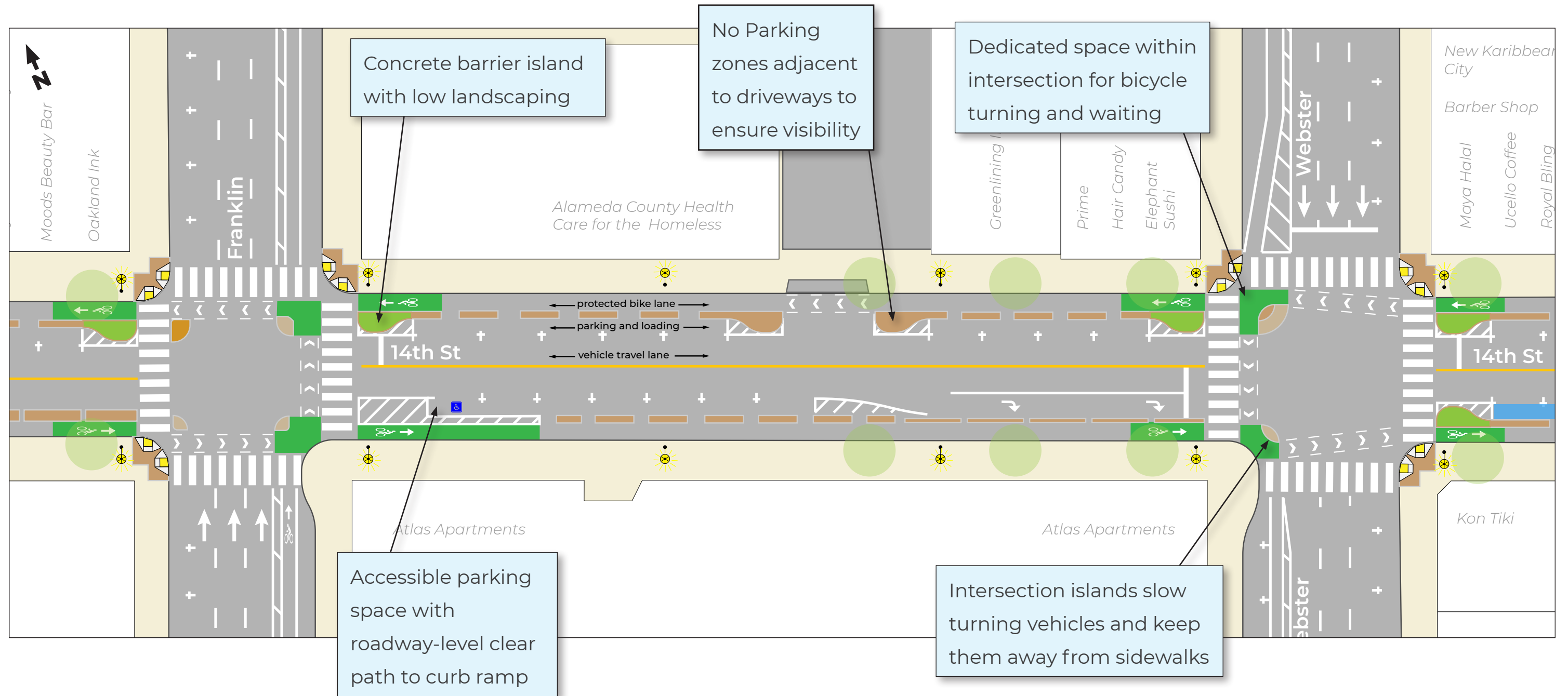

# 14th Street Safety Project - Block by Block Plans

Investing in 14th Street as a community destination for safe strolling, shopping, and biking



City of  
Oakland

Department of  
Transportation

## CURRENT PROPOSED PROJECT - WEBSTER STREET TO HARRISON STREET

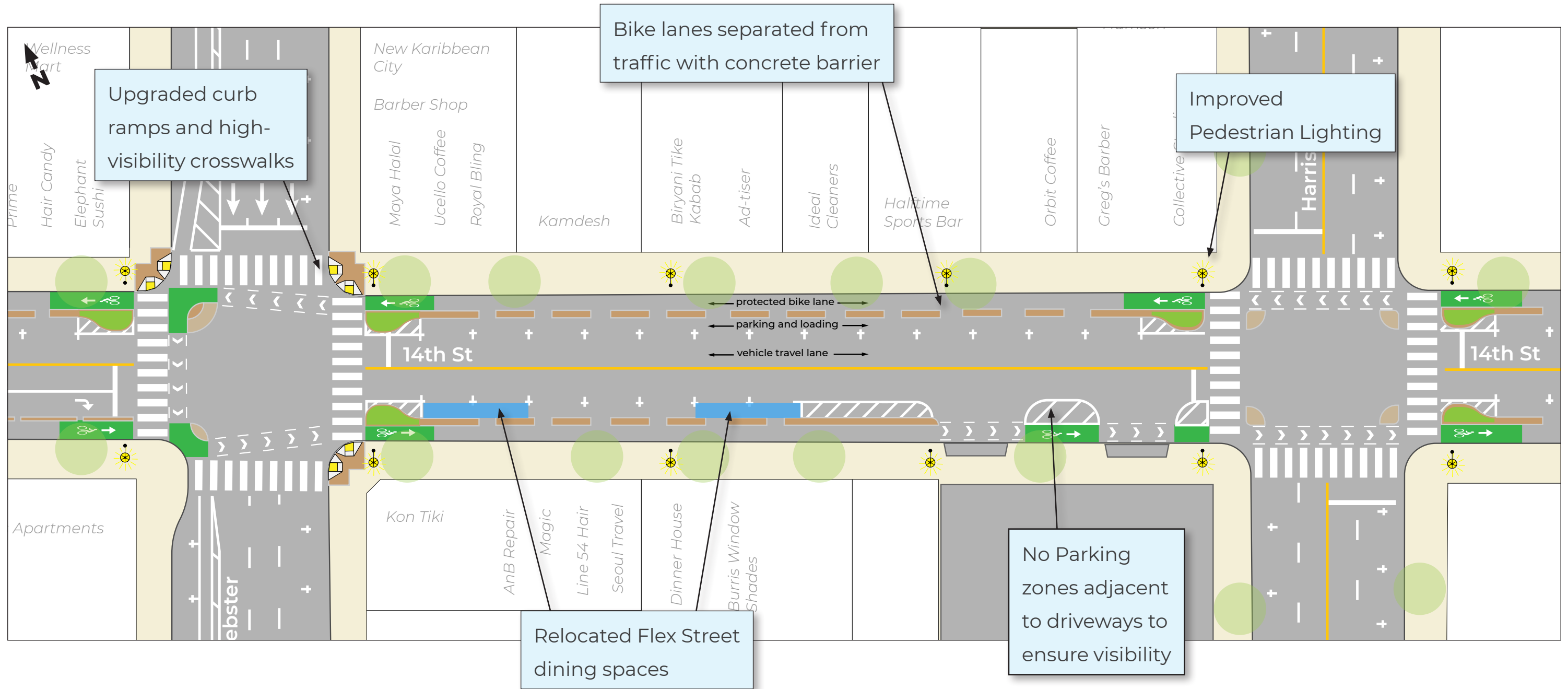

# 14th Street Safety Project - Block by Block Plans

Investing in 14th Street as a community destination for safe strolling, shopping, and biking



City of  
Oakland

Department of  
Transportation

## \*\*POTENTIAL ADDITION TO PROJECT - EXTENDED SIDEWALK FROM WEBSTER ST TO HARRISON ST\*\*

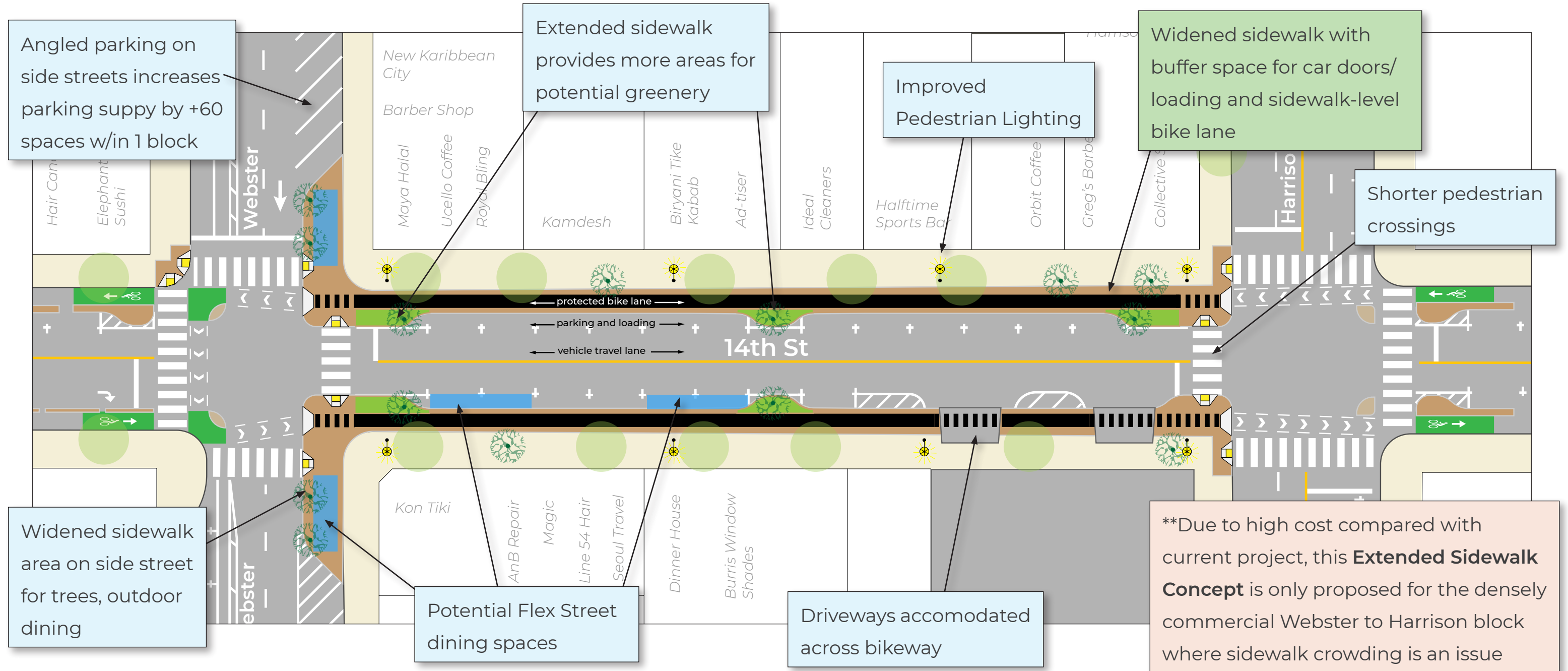



# 14th Street Safety Project - Block by Block Plans

Investing in 14th Street as a community destination for safe strolling, shopping, and biking



City of  
Oakland

Department of  
Transportation

## CURRENT PROPOSED PROJECT - HARRISON STREET TO ALICE STREET

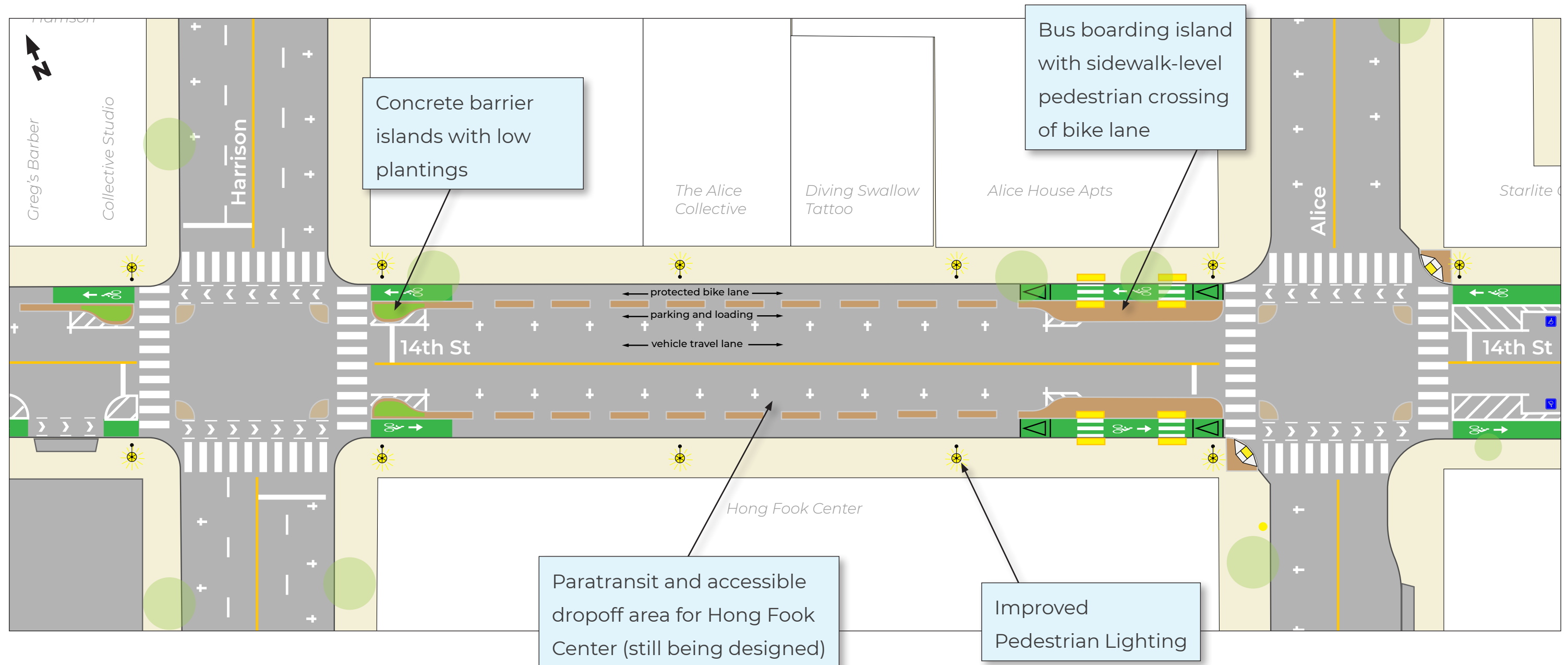

# 14th Street Safety Project - Block by Block Plans

Investing in 14th Street as a community destination for safe strolling, shopping, and biking



City of  
Oakland

Department of  
Transportation

## CURRENT PROPOSED PROJECT - ALICE STREET TO JACKSON STREET

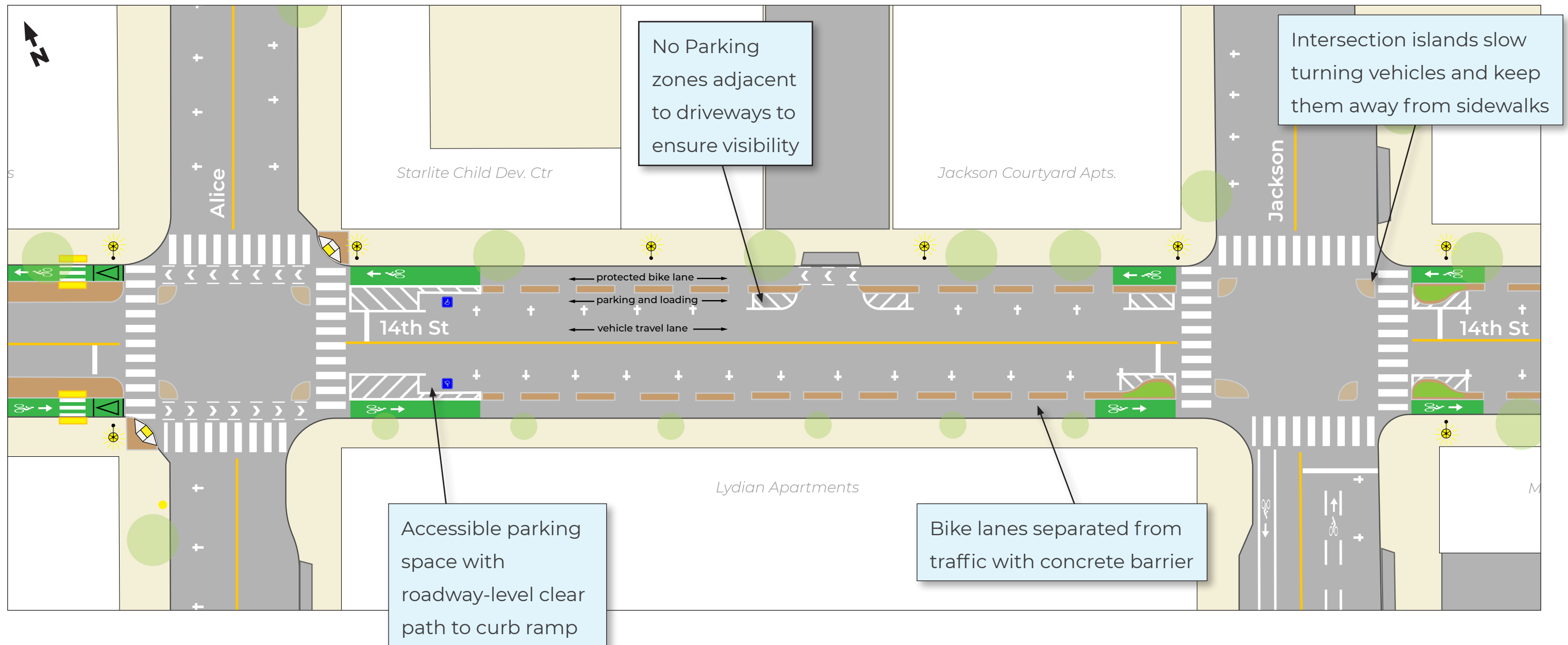

# 14th Street Safety Project - Block by Block Plans

Investing in 14th Street as a community destination for safe strolling, shopping, and biking



City of  
Oakland

Department of  
Transportation

## CURRENT PROPOSED PROJECT - JACKSON STREET TO MADISON STREET

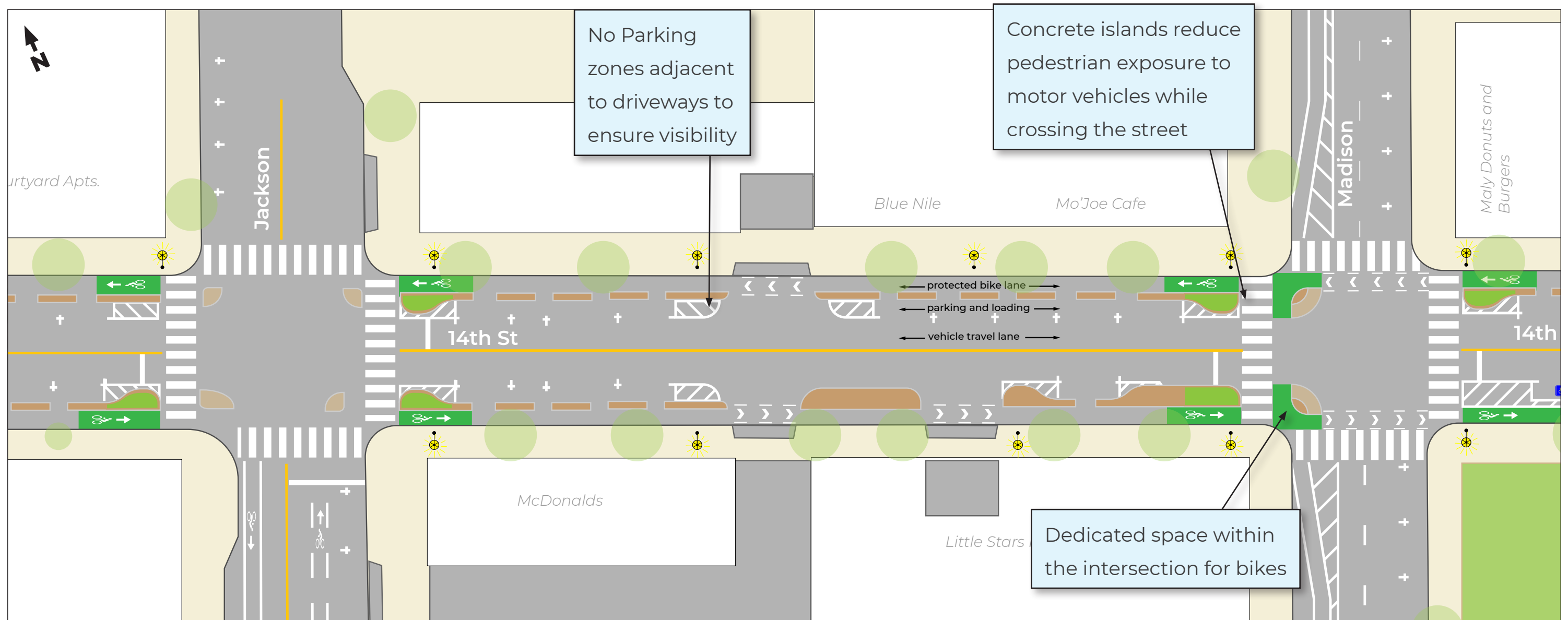



# 14th Street Safety Project - Block by Block Plans

Investing in 14th Street as a community destination for safe strolling, shopping, and biking



City of  
Oakland

Department of  
Transportation

## CURRENT PROPOSED PROJECT - MADISON STREET TO OAK STREET/LAKESIDE DRIVE

