

14th Avenue Streetscape Project

Creating an accessible corridor for people walking, biking, and taking transit on 14th Avenue



City of
Oakland

Department of
Transportation

About the Project

14th Avenue is a major east-west corridor that connects International Boulevard with Highland Hospital and points north of I-580. 14th Avenue is currently a relatively high-speed, 4-lane divided roadway that is a barrier for people walking between residential neighborhoods to the north and south. 14th Ave is also an important, (relatively flat) connection for people biking and is a critical gap in the network between the Foothill Blvd and MacArthur Blvd bike lanes. The City recently completed Phase 1 of this Project, which upgraded sidewalks, pedestrian crossings, and landscaping between International Blvd. and E 19th Street.

The next phase of The 14th Avenue Streetscape project will deliver an important bicycle connection on 14th Avenue from Foothill to 27th Street/Highland Hospital. This project will form the foundation for a complete network connection north to MacArthur Blvd. This project will also make pedestrian crossing improvements and striping upgrades between E8th Street and International Blvd.

Project Goals

- Improve safety and comfort for people walking, especially for people crossing 14th Avenue
- Increase the visibility of people walking and biking
- Slow vehicle speeds
- Provide a dedicated space for people riding bikes on 14th
- Improve access for people with disabilities
- Upgrade bus stops on the corridor with safer pedestrian crossings and bus boarding islands



14th Avenue Streetscape Project

Creating an accessible corridor for people walking, biking, and taking transit on 14th Avenue



City of
Oakland

Department of
Transportation

SITE PHOTOS

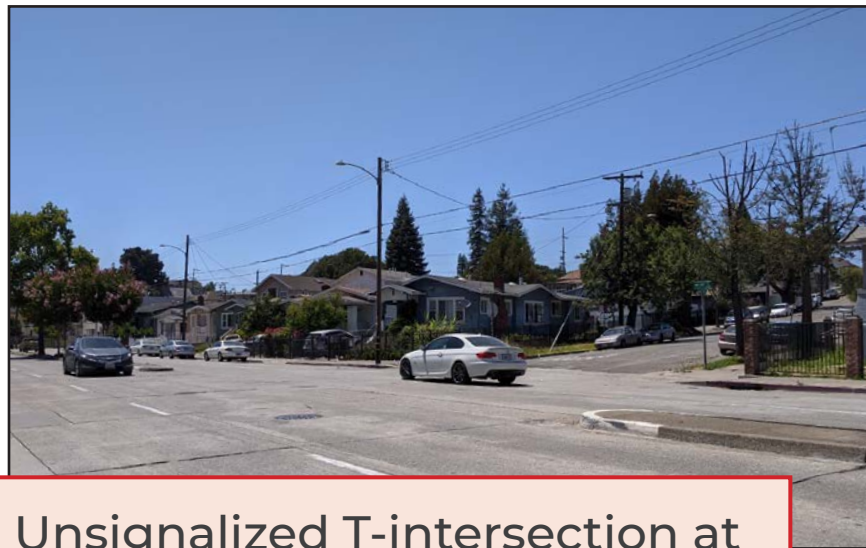

Unsignalized T-intersection at
23rd Street w/ no crossing

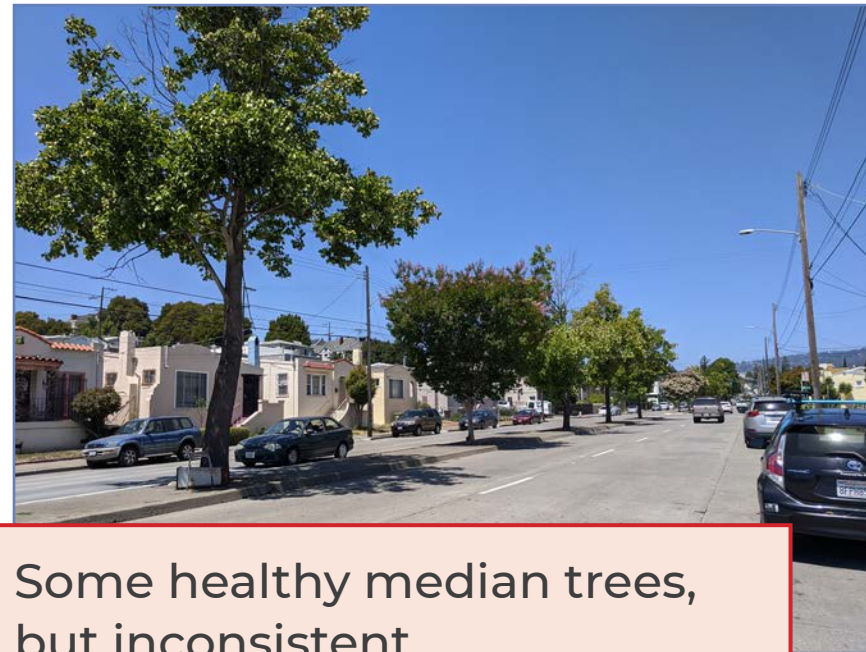

Some healthy median trees,
but inconsistent



Wide pedestrian crossings
with no median refuges

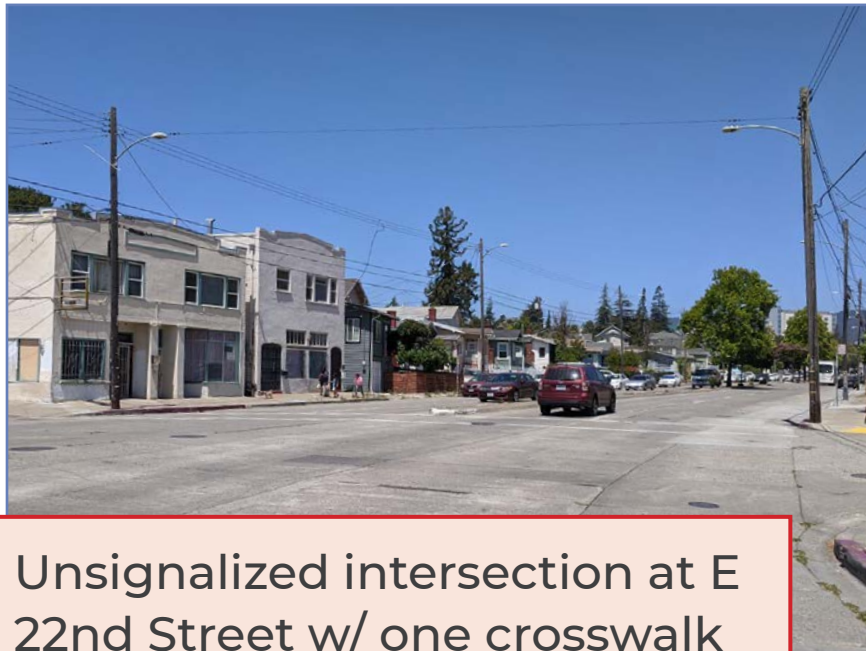

Unsignalized intersection at E
22nd Street w/ one crosswalk

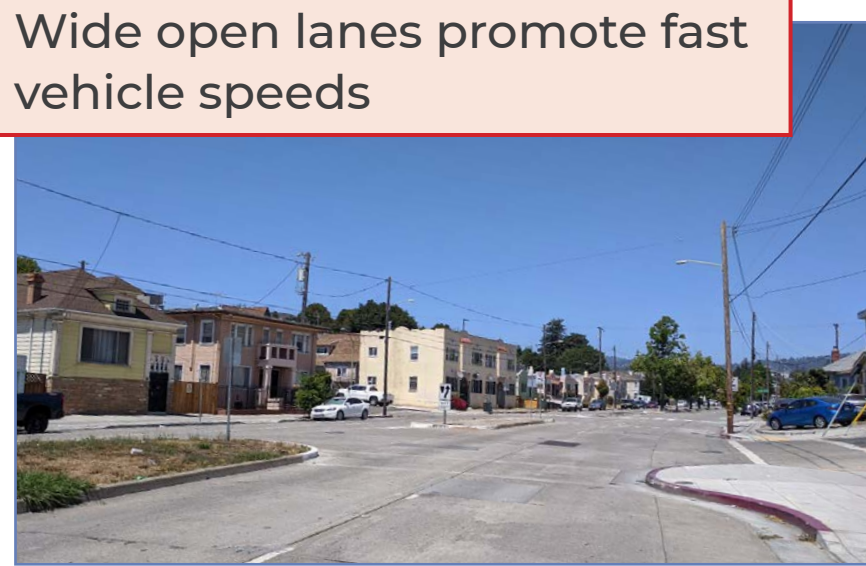

Wide open lanes promote fast
vehicle speeds



Narrow sidewalks and wide
roadway at E 21st Street

14th Avenue Streetscape Project

Creating an accessible corridor for people walking, biking, and taking transit on 14th Avenue



City of
Oakland

Department of
Transportation

FOOTHILL TO E 19TH STREET
EXISTING CONDITIONS



4 Lanes of vehicle traffic
promote fast speeds

No bike lanes to connect
to Foothill bike network

Previous project phase
improved pedestrian
crossings between
E 19th Street and
International Blvd.

14th Avenue Streetscape Project

Creating an accessible corridor for people walking, biking, and taking transit on 14th Avenue



City of
Oakland

Department of
Transportation

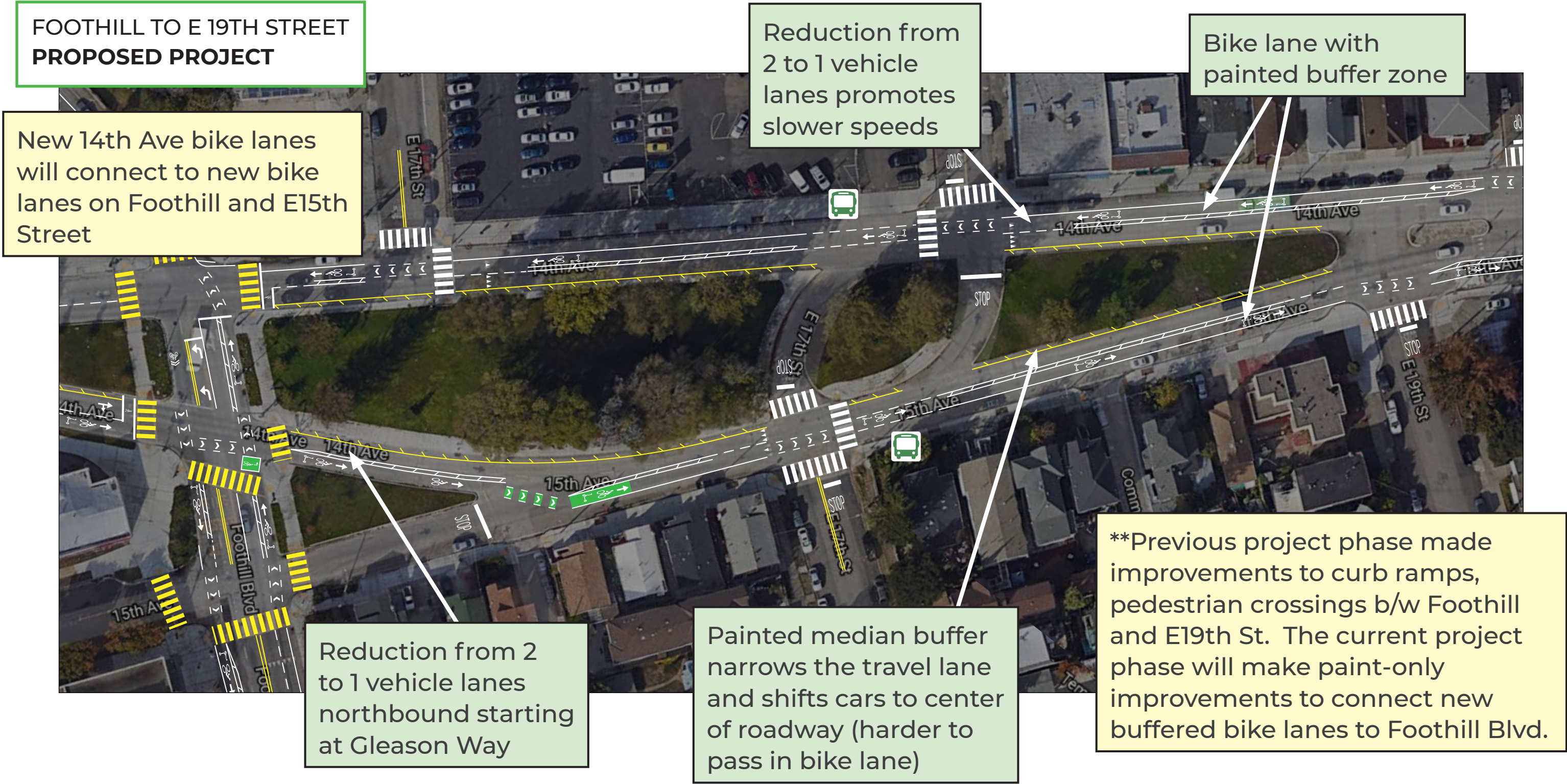

14th Avenue Streetscape Project

Creating an accessible corridor for people walking, biking, and taking transit on 14th Avenue



City of
Oakland

Department of
Transportation

E 19TH STREET TO E 21ST STREET
EXISTING CONDITIONS

4 Lanes of vehicle traffic
promote fast speeds

Unsignalized pedestrian
crossing of 14th Ave.

Pedestrian crossing
distance across 14th
Avenue is ~72 feet

Previous project phase
improved pedestrian
crossings between
E 19th Street and
International Blvd.



14th Avenue Streetscape Project

Creating an accessible corridor for people walking, biking, and taking transit on 14th Avenue



City of
Oakland

Department of
Transportation

E 19TH STREET TO E 21ST STREET
PROPOSED PROJECT

New street trees
where feasible

Bike lane w/ buffer zone
(narrowed to make
passing in a vehicle less
attractive)

New left-turn lanes for
efficient and predictable
vehicle movements

Pedestrian Flashing
Beacon at E19th

Curb bulb-outs, Pedestrian
Flashing Beacon, median
refuge islands and new
crosswalks at E 20th Street

Updated Improvements:
Extended sidewalk to shorten
crossings, provide adequate bus
wheelchair loading area, and
provide more sidewalk space

14th Avenue Streetscape Project

Creating an accessible corridor for people walking, biking, and taking transit on 14th Avenue



City of
Oakland

Department of
Transportation

E 22ND STREET TO E 23RD STREET
EXISTING CONDITIONS

Missing crosswalk

4 wide lanes of vehicle
traffic promote fast
speeds

Uncontrolled crossing
at E 22nd Street forces
pedestrians to find a gap or
wait for cars to yield

No traffic signal or
crosswalks at E 23rd Street
T-intersection (connects
to pedestrian stairway
east of 14th)

14th Avenue Streetscape Project

Creating an accessible corridor for people walking, biking, and taking transit on 14th Avenue



City of
Oakland

Department of
Transportation

E 22ND STREET TO E 23RD STREET
PROPOSED PROJECT

Updated Improvement: “Tree
bulbs” in roadway where sidewalks
are too narrow for street trees.

2 new crosswalks with
Pedestrian Flashing
Beacons and bulb-
outs at E 23rd Street

Curb bulb-outs, Pedestrian
Flashing Beacons, median
refuge islands and 3 new
crosswalk at E 22nd Street

Painted median
buffer to narrow
vehicle travel lanes
and slow speeds

New bike lanes with
painted buffer zone

14th Avenue Streetscape Project

Creating an accessible corridor for people walking, biking, and taking transit on 14th Avenue



City of
Oakland

Department of
Transportation

E 24TH STREET TO E 25TH STREET EXISTING CONDITIONS

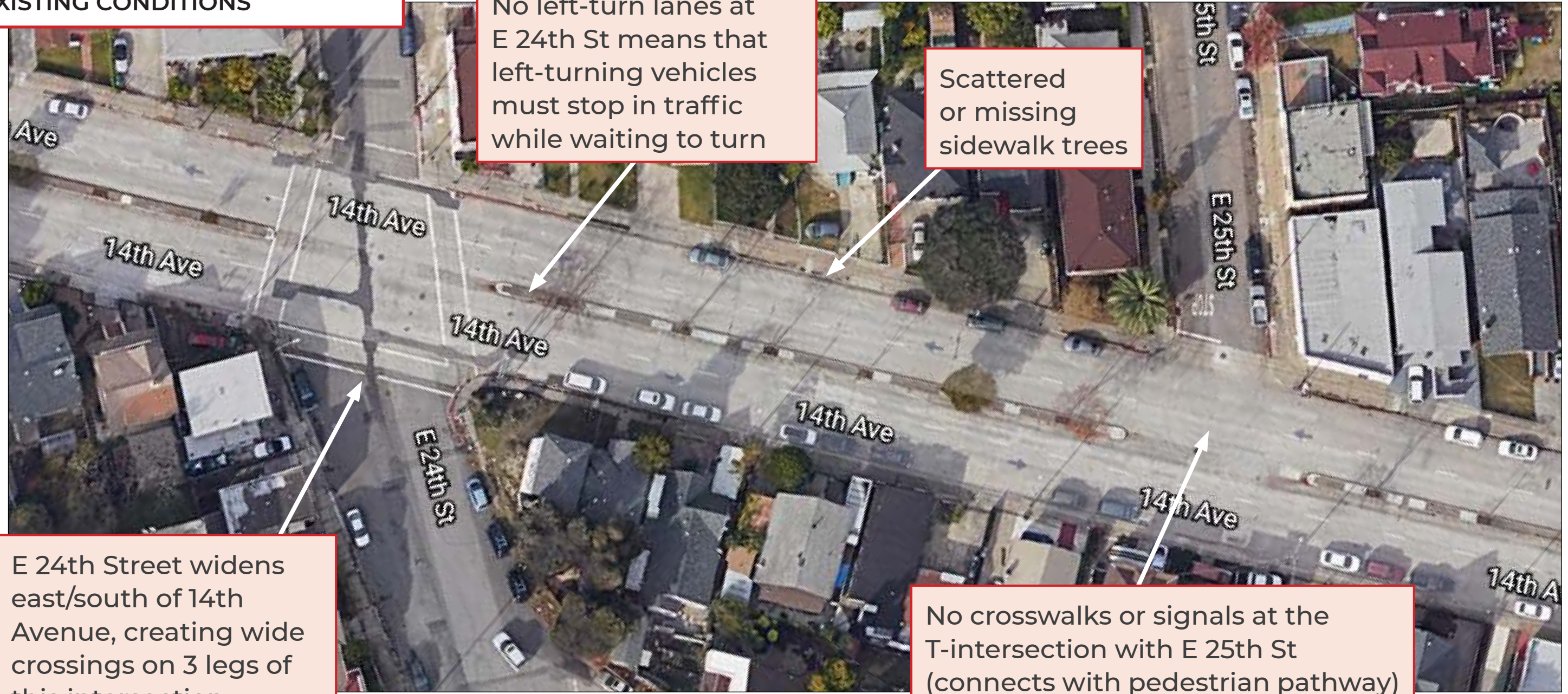

14th Avenue Streetscape Project

Creating an accessible corridor for people walking, biking, and taking transit on 14th Avenue



City of
Oakland

Department of
Transportation

E 24TH STREET TO E 25TH STREET PROPOSED PROJECT

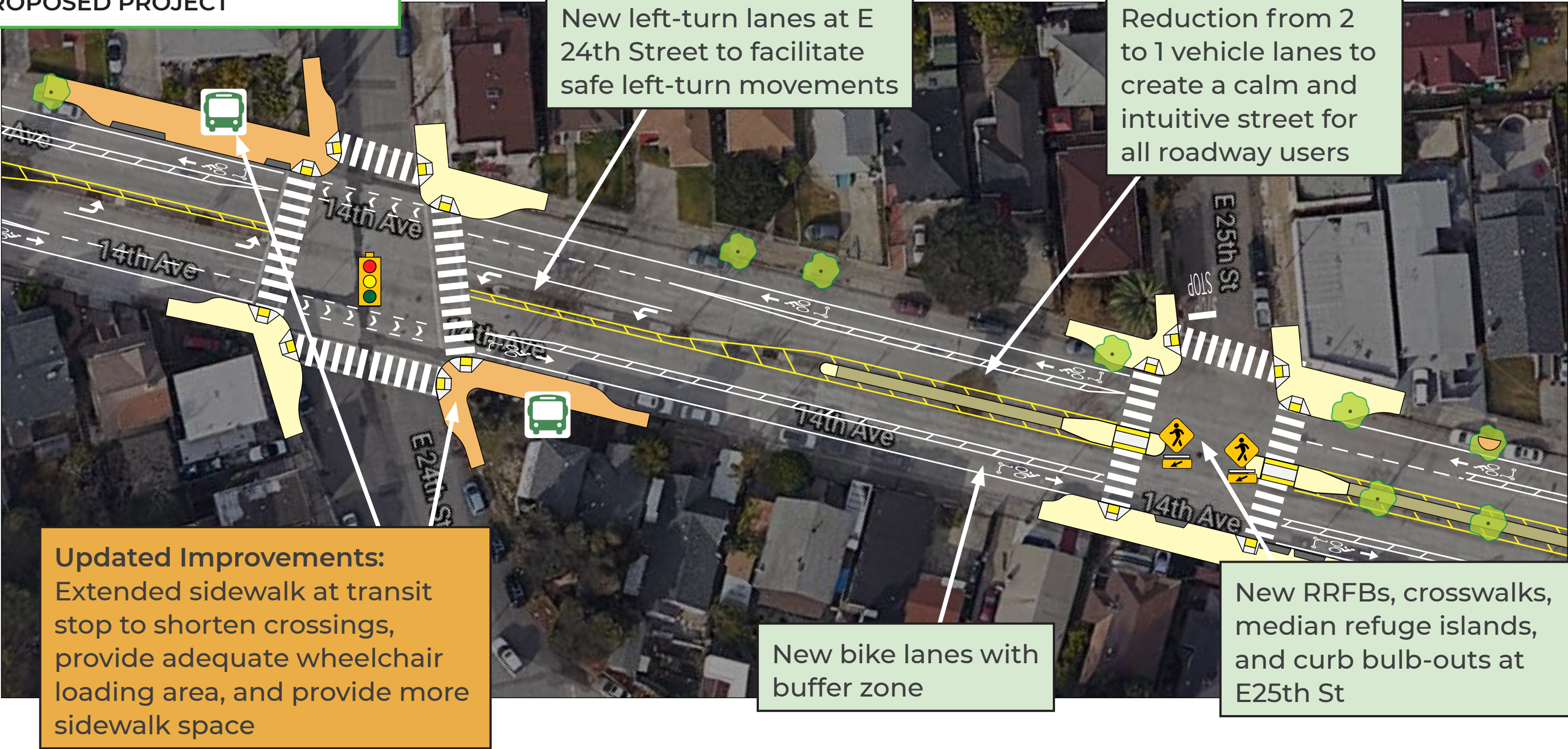

14th Avenue Streetscape Project

Creating an accessible corridor for people walking, biking, and taking transit on 14th Avenue



City of
Oakland

Department of
Transportation

E 26TH STREET TO E 27TH STREET
EXISTING CONDITIONS

Scattered
or missing
sidewalk trees

One uncontrolled,
unsignalized crosswalk
at E 26th St

No signal at 5-way
intersection requires “leap
of faith” for pedestrians,
expecting drivers to yield

14th Avenue Streetscape Project

Creating an accessible corridor for people walking, biking, and taking transit on 14th Avenue



City of
Oakland

Department of
Transportation

E 26TH STREET TO E 27TH STREET
PROPOSED PROJECT

Median buffer striping
narrows the vehicle lane to
encourage slower speeds

Updated Improvements:
Extended sidewalk at transit
stop to shorten crossings,
provide adequate wheelchair
loading area, and provide more
sidewalk space

Expanded sidewalk
bulb-out

Curb bulb-outs,
Pedestrian Flashing
Beacons, median
refuge islands and
2 new crosswalks at
E 26th Street

Reduction from 2
to 1 vehicle lanes to
create a calm and
intuitive street for
all roadway users

Two new Pedestrian Flashing
Beacons at E27th Street

14th Avenue Streetscape Project

Creating an accessible corridor for people walking, biking, and taking transit on 14th Avenue



City of
Oakland

Department of
Transportation

SCHEDULE/NEXT STEPS

- » Fall 2020 - Public noticing, outreach, and online survey
- » Spring 2021 - Incorporate feedback into design (new transit bulbs/sidewalk widening)
- » End of 2021 - Complete design of roadway
- » Spring 2021 - Advertise project for construction
- » End of 2022 - Begin construction (18 month duration)

