

<b>Location:</b>	1425 Leimert Blvd
<b>Assessor's Parcel Number:</b>	029A132701000
<b>Proposal:</b>	Installation of new telecommunications facility, including twelve (12) panel antennas, fifteen (15) Remote Radio Units (RRUs), three (3) FRP screens, and all related equipment
<b>Applicant:</b>	AT&T Mobility/ J5 Melissa Gonzalez
<b>Phone Number:</b>	415-305-8633
<b>Owner:</b>	1425 Leimert LLC
<b>Case File Number:</b>	PLN22199
<b>Planning Permits Required:</b>	Major Conditional Use Permit & Regular Design Review
<b>General Plan:</b>	Neighborhood Center Mixed Use
<b>Zoning:</b>	CN-3, Neighborhood Commercial Zone
<b>Environmental Determination:</b>	Exempt, Section 15301 of the State CEQA Guidelines: Existing Facilities; Exempt, Section 15303: New Construction of Small Structures; Section 15183: Projects Consistent with a Community Plan, General Plan or Zoning
<b>Historic Status:</b>	Non-Historic Properties
<b>City Council district:</b>	CCD4
<b>Status:</b>	Staff recommendation for approval
<b>Staff Recommendation:</b>	Approve with Conditions
<b>Finality of Decision:</b>	Appealable to City Council
<b>For further information:</b>	Contact case planner <b>Sarah Price</b> at (510)238-2955 or by email at <a href="mailto:sprice@oaklandca.gov">sprice@oaklandca.gov</a>

### CITY OF OAKLAND PLANNING COMMISSION

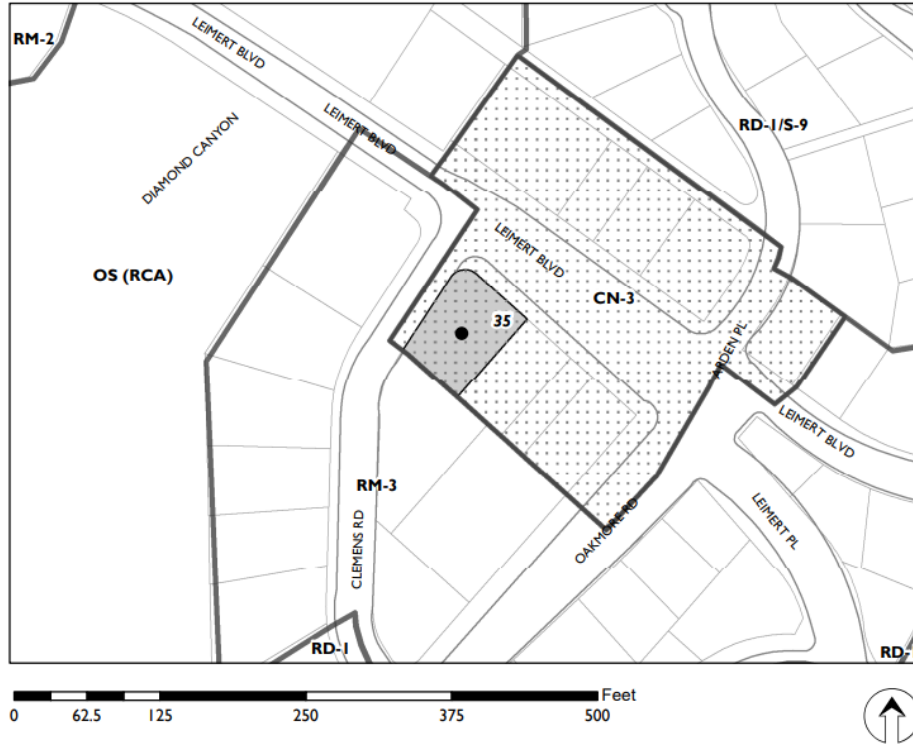

Case File: PLN22199  
Applicant: AT & T/J5 Melissa Gonzalez  
Address: 1425 Leimert  
Zone: CN-3  
Height Area: 35'

## SUMMARY

The applicant requests Planning Commission approval to establish a new telecommunications facility located on the rooftop of an existing non-residential facility in the CN-3 Neighborhood Commercial-3 Zone. The project involves mounting antennas within a fiber reinforced polymer (FRP) screen described in the submitted plans to enhance wireless services in those areas. Regular Design Review and a Major Conditional Use Permits are required for the installation of a new Macro Telecommunications Facility within 100 feet of a Residential Zone on private property. The proposed project, antenna and associated equipment would be similar to other equipment within the same area and around the City. The antenna shroud and associated equipment would be painted and textured to match the existing structure. As a result, the proposed telecommunication facility is an appropriate location and would not significantly increase negative visual impacts to adjacent and neighboring mixed use and residential properties. The project meets all the required findings for approval.

## TELECOMMUNICATIONS BACKGROUND

### **Limitations on Local Government Zoning Authority under the Telecommunications Act of 1996.**

Section 704 of the Telecommunications Act of 1996 (TCA) provides federal standards for the siting of “Personal Wireless Services Facilities.” “Personal Wireless Services” include all commercial mobile services (including personal communications services (PCS), cellular radio mobile services, and paging); unlicensed wireless services; and common carrier wireless exchange access services. Under Section 704, local zoning authority over personal wireless services is preserved such that the FCC is prevented from preempting local land use decisions; however, local government zoning decisions are still restricted by several provisions of federal law. Specifically:

- Under Section 253 of the TCA, no state or local regulation or other legal requirement can prohibit or have the effect of prohibiting the ability of any entity to provide any interstate or intrastate telecommunications service.
- Further, Section 704 of the TCA imposes limitations on what local and state governments can do. Section 704 prohibits any state and local government action which unreasonably discriminates among personal wireless providers. Local governments must ensure that its wireless ordinance does not contain requirements in the form of regulatory terms or fees which may have the “effect” of prohibiting the placement, construction, or modification of personal wireless services.
- Section 704 also preempts any local zoning regulation purporting to regulate the placement, construction and modification of personal wireless service facilities on the basis, either directly or indirectly, on the environmental effects of radio frequency (RF) emissions of such facilities, which otherwise comply with Federal Communications Commission (FCC) standards in this regard. (See 47 U.S.C. Section 332(c)(7)(B)(iv) (1996)). This means that local authorities may not regulate the siting or construction of personal wireless facilities based on RF standards that are more stringent than those promulgated by the FCC.
- Section 704 mandates that local governments act upon personal wireless service facility siting applications to place, construct, or modify a facility within a reasonable time (See 47 U.S.C.332(c)(7)(B)(ii) and FCC Shot Clock ruling setting forth “reasonable time” standards for applications deemed complete).
- Section 704 also mandates that the FCC provide technical support to local governments in order to encourage them to make property, rights-of-way, and easements under their jurisdiction available for the placement of new spectrum-based telecommunications services. This proceeding is currently at the comment stage.

For more information on the FCC’s jurisdiction in this area, consult the following:

Competition & Infrastructure Policy Division (CIPD) of the Wireless Telecommunications Bureau, main division number: (202) 418-1310. <https://www.fcc.gov/general/competition-infrastructure-policy-division-wireless-telecommunications-bureau>

**PROJECT DESCRIPTION**

- Installation of twelve (12) AT&T Panel Antennas, fifteen (15) AT&T Remote Radio Units (RRUs), and associated equipment including three (3) FRP screens on the roof of an existing facility.
- Installation of ground level equipment on a platform at grade level.
- Paint and texture the FRP screens to match the existing structure.

The proposed antennas and RRUs will not be accessible to the public.

**PROPERTY DESCRIPTION**

The site is located at the intersection of Leimert Blvd and Clemens Road on a corner lot occupied by a mix of commercial activities, including administrative, personal improvement, and medical service commercial activities. The parcel is adjacent to commercial use to the south side and multifamily residential to the rear. The surrounding sites include commercial and mixed-use facilities across Leimert street and multi-family residential across Clemens Road.

**GENERAL PLAN & ZONING ANALYSIS**

The site is classified as Neighborhood Center Mixed Use. The General Plan Land Use and Transportation Element (LUTE) defines the intent of this area to “identify, create, maintain and enhance mixed use neighborhood commercial centers”. The desired character includes uses that are pedestrian oriented and serve nearby neighborhoods.

The proposed telecommunications facility would be mounted on an existing facility’s rooftop and screened in an architecturally compatible manner from surrounding uses. The grade-level equipment is sited adjacent to an existing driveway and will not impact the pedestrian environment. The proposed wireless telecommunication facility would not adversely affect the characteristics of the neighborhood.

The parcel is zoned CN-3 Neighborhood Commercial-3 Zone, which intends to “create, improve, and enhance neighborhood commercial centers that have a compact, vibrant pedestrian environment.” Sections 17.33.040 and 17.128.025 of the Oakland Planning Code requires a Major Conditional Use Permit for new telecommunications facilities within 100 feet of Residential Zones. Section 17.136.040 of the Oakland Planning Code requires Regular Design Review with special findings to ensure that the facility is concealed to the greatest extent possible. The required findings for the entitlements are listed and included in staff’s evaluation further in this report.

**ENVIRONMENTAL DETERMINATION**

The California Environmental Quality Act (CEQA) Guidelines list the projects that qualify as categorical exemptions from environmental review. The proposed project is categorically exempt from the environmental review requirements pursuant to Section 15301, minor additions and alterations to an existing facility; Section 15303, new construction or conversion of small structures, and Section 15183, projects consistent with the General Plan or Zoning.

**KEY ISSUES AND IMPACTS**

The proposal to establish a new telecommunications facility is subject to the following Planning Code development standards, which are followed by staff’s analysis in relation to this application:

**17.128.070 Macro Telecommunications Facilities.****A. General Development Standards for Macro Telecommunications Facilities.**

1. **The Macro Facilities shall be located on existing buildings, poles or other existing support structures, or shall be post mounted.**  
The project proposes to construct the telecommunications facility on an existing building.
2. **The equipment shelter or cabinet must be concealed from public view or made compatible with the architecture of the surrounding structures or placed underground. The shelter or cabinet must be regularly maintained.**  
Recommended conditions of approval require painting and texturing the antennas and all components to match the appearance of the existing building and to be regularly maintained.
3. **Macro Facilities may exceed the height limitation specified for all zones but may not exceed fifteen (15) feet above the roof line or parapet. Placement of an antenna on a nonconforming structure shall not be considered to be an expansion of the nonconforming structure.**  
The proposal does not exceed 15 feet above the roofline or parapet (approx. 8 feet above existing roof top is proposed).
4. **Ground post mounted Macro Facilities must not exceed seventeen (17) feet to the top of the antenna**  
This standard is not applicable to this application (does not involve ground post mounting).
5. **The applicant shall submit written documentation demonstrating that the emissions from the proposed project are within the limits set by the Federal Communications Commission**  
This standard is met by the proposals; satisfactory emissions reports have been submitted and are attached to this report (Attachment C).

**17.128.110 Site Location Preferences**

New wireless facilities shall generally be located on the following properties or facilities in order of preference:

- A. Co-located on an existing structure or facility with existing wireless antennas.
- B. City-owned properties or other public or quasi-public facilities.
- C. Existing commercial or industrial structures in Nonresidential Zones (excluding all HBX Zones and the D-CE-3 and D-CE-4 Zones).
- D. Existing commercial or industrial structures in Residential Zones, HBX Zones, or the D-CE-3 or D-CE-4 Zones.
- E. Other Nonresidential uses in Residential Zones, HBX Zones, or the D-CE-3 or D-CE-4 Zones.
- F. Residential uses in Nonresidential Zones (excluding all HBX Zones and the D-CE-3 and D-CE-4 Zones).
- G. Residential uses in Residential Zones, HBX Zones, or the D-CE-3 or D-CE-4 Zones.

Site alternative analysis is not required because the proposal conform to 'C' as an existing commercial structure in a commercial zone.

**17.128.120 Site Design Preferences**

New wireless facilities shall generally be designed in the following order of preference:

- A. Building or structure mounted antennas completely concealed from view.
- B. Building or structure mounted antennas set back from roof edge, not visible from public right-of way.
- C. Building or structure mounted antennas below roof line (facade mount, pole mount) visible from public right-of-way, painted to match existing structure.
- D. Building or structure mounted antennas above roof line visible from public right-of-way.
- E. Monopoles.

**F. Towers.**

Site design alternative analysis is not required because the proposal conforms with ‘A’, the proposal includes screening the antennas and RRUs to conceal them from view and the proposed condition of approval would require the screening to be maintained.

**CONCLUSION**

The project meets all the required findings for approval and would provide an essential telecommunication service to the community and the City of Oakland at large. It would also be available to emergency services such as police, fire department and emergency response teams. Staff believes that the proposal is designed to meet the established zoning and telecommunication regulations and recommends supporting the Regular Design Review and Major Conditional Use Permit application.

**RECOMMENDATIONS:**

- For approvals:
1. Affirm staff’s environmental determination.
  2. Approve the Major Conditional Use Permit and Regular Design Review subject to the attached findings and conditions.

Prepared by:

*S. Price*

---

Sarah Price  
Planner IV

Reviewed by:



---

Robert D. Merkamp  
Zoning Manager  
Bureau of Planning

Approved for forwarding to the Planning Commission:



---

Ed Manasse Deputy Director  
Bureau of Planning

**ATTACHMENTS:**

- A. Findings Approval
- B. Conditions for Approval
- C. PLN22199: Plans/Photo-Simulations/Site Analyses/RF Report/Proof of Posting

**ATTACHMENT A: FINDINGS**

This proposal meets the required findings under Regular Design Review Criteria for Nonresidential Facilities (Oakland Planning Code (OPC) Sec. 17.136.050(B)), Telecommunications Regulations/Design Review and Conditional Use Permit Criteria for Macro Telecommunications Facilities (OPC Sec. 17.128.070(B)(C)), and General Use Permit Criteria (OPC Sec. 17.134.050) as set forth below. Required findings are shown in **bold** type; explanations as to why these findings can be made are in normal type.

**REGULAR DESIGN REVIEW CRITERIA FOR NON-RESIDENTIAL FACILITIES (OPC SEC. 17.136.050(B))**

- 1. That the proposal will help achieve or maintain a group of facilities which are well related to one another and which, when taken together, will result in a well-composed design, with consideration given to site, landscape, bulk, height, arrangement, texture, materials, colors, and appurtenances; the relation of these factors to other facilities in the vicinity; and the relation of the proposal to the total setting as seen from key points in the surrounding area. Only elements of design which have some significant relationship to outside appearance shall be considered, except as otherwise provided in Section 17.136.060;**

The construction of the telecommunications facility will be camouflaged by FRP screens as to not be intrusive to the surrounding neighborhood.

- 2. That the proposed design will be of a quality and character which harmonizes with, and serves to protect the value of, private and public investments in the area;**

The proposals will not create a view obstruction, be directly adjacent to a primary living space such as a living room or bedroom window, or be located on an historic structure. The proposal will increase telecommunication capacity for the City and will strengthen the ability of people to get those needs serviced.

- 3. That the proposed design conforms in all significant respects with the Oakland General Plan and with any applicable design review guidelines or criteria, district plan, or development control map which have been adopted by the Planning Commission or City Council.**

The site is classified as Neighborhood Center Mixed Use. The general plan Land Use and Transportation Element (LUTE) defines the intent of this area to “identify, create, maintain and enhance mixed use neighborhood commercial centers”. The desired character includes uses that are pedestrian oriented and serve nearby neighborhoods. The proposed telecommunications facility would be mounted on an existing facility’s rooftop and screened in an architecturally compatible manner from surrounding uses. The grade-level equipment is sited adjacent to an existing driveway and will not impact the pedestrian environment. The proposed wireless telecommunication facility would not adversely affect the characteristics of the neighborhood.

**TELECOMMUNICATIONS REGULATIONS/DESIGN REVIEW CRITERIA FOR MACRO TELECOMMUNICATIONS FACILITIES (OPC SEC. 17.128.070(B))**

- 1. Antennas should be painted and/or textured to match the existing structure.**

The antennas will be screened and the facility will be painted and textured to match the existing structure.

- 2. Antennas mounted on architecturally significant structures or significant architectural detail of the building should be covered by appropriate casings which are manufactured to match existing architectural features found on the building.**

The proposal includes covering the antennas with FRP material to be painted and textured to match the existing building and are compatible with the existing features of the structure.

- 3. Where feasible, antennas can be placed directly above, below or incorporated with vertical design elements of a building to help in camouflaging.**

The proposal includes screening that camouflages the rooftop equipment and is below the existing high point of the vent.

- 4. Equipment shelters or cabinets shall be screened from the public view by using landscaping, or materials and colors consistent with surrounding backdrop or placed underground or inside existing facilities or behind screening fences.**

The equipment platform is at grade level, behind existing improvements (such as a shed) which screens it from view.

- 5. Equipment shelters or cabinets shall be consistent with the general character of the area.**

The equipment platform is minor and consistent with the general character of the area.

- 6. For antennas attached to the roof, maintain a 1:1 ratio (example: ten (10) feet high antenna requires ten (10) feet setback from facade) for equipment setback; screen the antennas to match existing air conditioning units, stairs, or elevator towers; avoid placing roof mounted antennas in direct line with significant view corridors.**

The antennas are setback from the edge of the roof and are placed behind screening to avoid any views of the antennas.

- 7. That all reasonable means of reducing public access to the antennas and equipment has been made, including, but not limited to, placement in or on buildings or structures, fencing, anti-climbing measures and anti-tampering devices.**

The antennas and associated equipment will not be accessible by the public. The Radio Frequency report includes recommendations for signage which will be required to be installed.

**TELECOMMUNICATIONS REGULATIONS/CONDITIONAL USE PERMIT CRITERIA FOR MACRO TELECOMMUNICATIONS FACILITIES (OPC SEC. 17.128.070(C))**

- 1. The project must meet the special design review criteria listed in Subsection B. of this Section.**

Please see above.

- 2. The proposed project must not disrupt the overall community character.**

The project will be screened from view and will not disrupt the overall community character. The screening will be required to be compatible with the existing structure and to be maintained.

**GENERAL USE PERMIT CRITERIA (OPC SEC. 17.134.050)**

- A. That the location, size, design, and operating characteristics of the proposed development will be compatible with and will not adversely affect the livability or appropriate development of abutting properties and the surrounding neighborhood, with consideration to be given to harmony in scale, bulk, coverage, and density; to the availability of civic facilities and utilities; to harmful effect, if any, upon desirable neighborhood character; to the generation of traffic and the capacity of surrounding streets; and to any other relevant impact of the development;**

The Radio Frequency report shows that the surrounding buildings will be below the FCC MPE limits for the General Population. The proposal will increase the capacity of wireless service for people in the City.

- B. That the location, design, and site planning of the proposed development will provide a convenient and functional living, working, shopping, or civic environment, and will be as attractive as the nature of the use and its location and setting warrant;**

The proposed telecommunications facility will be concealed from view and is designed to not be intrusive.



- C. That the proposed development will enhance the successful operation of the surrounding area in its basic community functions, or will provide an essential service to the community or region;**

The proposal will increase wireless network capacity for the City which is an essential service to the community.

- D. That the proposal conforms to all applicable regular design review criteria set forth in the regular design review procedure at Section 17.136.050;**

Please see above.

- E. That the proposal conforms in all significant respects with the Oakland General Plan and with any other applicable guidelines or criteria, district plan or development control map which has been adopted by the Planning Commission or City Council**

The proposal complies with the General Plan Neighborhood Center Mixed Use area. The telecommunications facility will enhance wireless capabilities for the area.

**ATTACHMENT B: CONDITIONS OF APPROVAL**

**1. Approved Use**

The project shall be constructed and operated in accordance with the authorized use as described in the approved application materials, staff report and the approved plans dated 9/30/2022, as amended by the following conditions of approval and mitigation measures, if applicable (“Conditions of Approval” or “Conditions”).

**2. Effective Date, Expiration, Extensions and Extinguishment**

This Approval shall become effective immediately, unless the Approval is appealable, in which case the Approval shall become effective in ten (10) calendar days unless an appeal is filed. Unless a different termination date is prescribed, this Approval shall expire two calendar years from the Approval date, or from the date of the final decision in the event of an appeal, unless within such period a complete building permit application has been filed with the Bureau of Building and diligently pursued towards completion, or the authorized activities have commenced in the case of a permit not involving construction or alteration. Upon written request and payment of appropriate fees submitted no later than the expiration date of this Approval, the Director of City Planning or designee may grant a one-year extension of this date, with additional extensions subject to approval by the approving body. Expiration of any necessary building permit or other construction-related permit for this project may invalidate this Approval if said Approval has also expired. If litigation is filed challenging this Approval, or its implementation, then the time period stated above for obtaining necessary permits for construction or alteration and/or commencement of authorized activities is automatically extended for the duration of the litigation.

**3. Compliance with Other Requirements**

The project applicant shall comply with all other applicable federal, state, regional, and local laws/codes, requirements, regulations, and guidelines, including but not limited to those imposed by the City’s Bureau of Building, Fire Marshal, Department of Transportation, and Public Works Department. Compliance with other applicable requirements may require changes to the approved use and/or plans. These changes shall be processed in accordance with the procedures contained in Condition #4.

**4. Minor and Major Changes**

- a. Minor changes to the approved project, plans, Conditions, facilities, or use may be approved administratively by the Director of City Planning.
- b. Major changes to the approved project, plans, Conditions, facilities, or use shall be reviewed by the Director of City Planning to determine whether such changes require submittal and approval of a revision to the Approval by the original approving body or a new independent permit/approval. Major revisions shall be reviewed in accordance with the procedures required for the original permit/approval. A new independent permit/approval shall be reviewed in accordance with the procedures required for the new permit/approval.

**5. Compliance with Conditions of Approval**

- a. The project applicant and property owner, including successors, (collectively referred to hereafter as the “project applicant” or “applicant”) shall be responsible for compliance with all the Conditions of Approval and any recommendations contained in any submitted and approved technical report at his/her sole cost and expense, subject to review and approval by the City of Oakland.
- b. The City of Oakland reserves the right at any time during construction to require certification by a licensed professional at the project applicant’s expense that the as-built project conforms to all

applicable requirements, including but not limited to, approved maximum heights and minimum setbacks. Failure to construct the project in accordance with the Approval may result in remedial reconstruction, permit revocation, permit modification, stop work, permit suspension, or other corrective action.

- c. Violation of any term, Condition, or project description relating to the Approval is unlawful, prohibited, and a violation of the Oakland Municipal Code. The City of Oakland reserves the right to initiate civil and/or criminal enforcement and/or abatement proceedings, or after notice and public hearing, to revoke the Approval or alter these Conditions if it is found that there is violation of any of the Conditions or the provisions of the Planning Code or Municipal Code, or the project operates as or causes a public nuisance. This provision is not intended to, nor does it, limit in any manner whatsoever the ability of the City to take appropriate enforcement actions. The project applicant shall be responsible for paying fees in accordance with the City's Master Fee Schedule for inspections conducted by the City or a City-designated third-party to investigate alleged violations of the Approval or Conditions.

**6. Signed Copy of the Approval/Conditions**

A copy of the Approval letter and Conditions shall be signed by the project applicant, attached to each set of permit plans submitted to the appropriate City agency for the project, and made available for review at the project job site at all times.

**7. Blight/Nuisances**

The project site shall be kept in a blight/nuisance-free condition. Any existing blight or nuisance shall be abated within sixty (60) days of approval, unless an earlier date is specified elsewhere.

**8. Indemnification**

- a. To the maximum extent permitted by law, the project applicant shall defend (with counsel acceptable to the City), indemnify, and hold harmless the City of Oakland, the Oakland City Council, the Oakland Redevelopment Successor Agency, the Oakland City Planning Commission, and their respective agents, officers, employees, and volunteers (hereafter collectively called "City") from any liability, damages, claim, judgment, loss (direct or indirect), action, causes of action, or proceeding (including legal costs, attorneys' fees, expert witness or consultant fees, City Attorney or staff time, expenses or costs) (collectively called "Action") against the City to attack, set aside, void or annul this Approval or implementation of this Approval. The City may elect, in its sole discretion, to participate in the defense of said Action and the project applicant shall reimburse the City for its reasonable legal costs and attorneys' fees.
- b. Within ten (10) calendar days of the filing of any Action as specified in subsection (a) above, the project applicant shall execute a Joint Defense Letter of Agreement with the City, acceptable to the Office of the City Attorney, which memorializes the above obligations. These obligations and the Joint Defense Letter of Agreement shall survive termination, extinguishment, or invalidation of the Approval. Failure to timely execute the Letter of Agreement does not relieve the project applicant of any of the obligations contained in this Condition or other requirements or Conditions of Approval that may be imposed by the City.

**9. Severability**

The Approval would not have been granted but for the applicability and validity of each and every one of the specified Conditions, and if one or more of such Conditions is found to be invalid by a court of competent jurisdiction this Approval would not have been granted without requiring other valid Conditions consistent with achieving the same purpose and intent of such Approval.

**10. Special Inspector/Inspections, Independent Technical Review, Project Coordination and Monitoring**

The project applicant may be required to cover the full costs of independent third-party technical review and City monitoring and inspection, including without limitation, special inspector(s)/inspection(s) during times of extensive or specialized plan-check review or construction, and inspections of potential violations of the Conditions of Approval. The project applicant shall establish a deposit with Engineering Services and/or the Bureau of Building, if directed by the Director of Public Works, Building Official, Director of City Planning, Director of Transportation, or designee, prior to the issuance of a construction-related permit and on an ongoing as-needed basis.

**11. Public Improvements**

The project applicant shall obtain all necessary permits/approvals, such as encroachment permits, obstruction permits, curb/gutter/sidewalk permits, and public improvement (“p-job”) permits from the City for work in the public right-of-way, including but not limited to, streets, curbs, gutters, sidewalks, utilities, and fire hydrants. Prior to any work in the public right-of-way, the applicant shall submit plans for review and approval by the Bureau of Planning, the Bureau of Building, Engineering Services, Department of Transportation, and other City departments as required. Public improvements shall be designed and installed to the satisfaction of the City.

**12. Trash and Blight Removal**

Requirement: The project applicant and his/her successors shall maintain the property free of blight, as defined in Chapter 8.24 of the Oakland Municipal Code. For nonresidential and multi-family residential projects, the project applicant shall install and maintain trash receptacles near public entryways as needed to provide sufficient capacity for building users.

When Required: Ongoing

Initial Approval: N/A

Monitoring/Inspection: Bureau of Building

**13. Graffiti Control**

Requirement:

- a. During construction and operation of the project, the project applicant shall incorporate best management practices reasonably related to the control of graffiti and/or the mitigation of the impacts of graffiti. Such best management practices may include, without limitation:
  - i. Installation and maintenance of landscaping to discourage defacement of and/or protect likely graffiti-attracting surfaces.
  - ii. Installation and maintenance of lighting to protect likely graffiti-attracting surfaces.
  - iii. Use of paint with anti-graffiti coating.
  - iv. Incorporation of architectural or design elements or features to discourage graffiti defacement in accordance with the principles of Crime Prevention Through Environmental Design (CPTED).
  - v. Other practices approved by the City to deter, protect, or reduce the potential for graffiti defacement.
- b. The project applicant shall remove graffiti by appropriate means within seventy-two (72) hours. Appropriate means include the following:
  - i. Removal through scrubbing, washing, sanding, and/or scraping (or similar method) without damaging the surface and without discharging wash water or cleaning detergents into the City storm drain system.

- ii. Covering with new paint to match the color of the surrounding surface.
- iii. Replacing with new surfacing (with City permits if required).

When Required: Ongoing

Initial Approval: N/A

Monitoring/Inspection: Bureau of Building

**14. Dust Controls – Construction Related**

Requirement: The project applicant shall implement all of the following applicable dust control measures during construction of the project:

- a) Water all exposed surfaces of active construction areas at least twice daily. Watering should be sufficient to prevent airborne dust from leaving the site. Increased watering frequency may be necessary whenever wind speeds exceed 15 miles per hour. Reclaimed water should be used whenever feasible.
- b) Cover all trucks hauling soil, sand, and other loose materials or require all trucks to maintain at least two feet of freeboard (i.e., the minimum required space between the top of the load and the top of the trailer).
- c) All visible mud or dirt track-out onto adjacent public roads shall be removed using wet power vacuum street sweepers at least once per day. The use of dry power sweeping is prohibited.
- d) Limit vehicle speeds on unpaved roads to 15 miles per hour.
- e) All demolition activities (if any) shall be suspended when average wind speeds exceed 20 mph.
- f) All trucks and equipment, including tires, shall be washed off prior to leaving the site.
- g) Site accesses to a distance of 100 feet from the paved road shall be treated with a 6 to 12 inch compacted layer of wood chips, mulch, or gravel.

When Required: During construction

Initial Approval: N/A

Monitoring/Inspection: Bureau of Building

**15. Criteria Air Pollutant Controls - Construction Related**

Requirement: The project applicant shall implement all of the following applicable basic control measures for criteria air pollutants during construction of the project as applicable:

- a) Idling times on all diesel-fueled commercial vehicles over 10,000 lbs. shall be minimized either by shutting equipment off when not in use or reducing the maximum idling time to two minutes (as required by the California airborne toxics control measure Title 13, Section 2485, of the California Code of Regulations). Clear signage to this effect shall be provided for construction workers at all access points.
- b) Idling times on all diesel-fueled off-road vehicles over 25 horsepower shall be minimized either by shutting equipment off when not in use or reducing the maximum idling time to two minutes and fleet operators must develop a written policy as required by Title 23, Section 2449, of the California Code of Regulations (“California Air Resources Board Off-Road Diesel Regulations”).
- c) All construction equipment shall be maintained and properly tuned in accordance with the manufacturer’s specifications. All equipment shall be checked by a certified mechanic and determined to be running in proper condition prior to operation. Equipment check documentation should be kept at the construction site and be available for review by the City and the Bay Area Air Quality District as needed.
- d) Portable equipment shall be powered by grid electricity if available. If electricity is not available, propane or natural gas generators shall be used if feasible. Diesel engines shall only

be used if grid electricity is not available and propane or natural gas generators cannot meet the electrical demand.

- e) Low VOC (i.e., ROG) coatings shall be used that comply with BAAQMD Regulation 8, Rule 3: Architectural Coatings.
- f) All equipment to be used on the construction site shall comply with the requirements of Title 13, Section 2449, of the California Code of Regulations (“California Air Resources Board Off-Road Diesel Regulations”) and upon request by the City (and the Air District if specifically requested), the project applicant shall provide written documentation that fleet requirements have been met.

When Required: During construction

Initial Approval: N/A

Monitoring/Inspection: Bureau of Building

**16. Archaeological and Paleontological Resources – Discovery During Construction**

Requirement: Pursuant to CEQA Guidelines section 15064.5(f), in the event that any historic or prehistoric subsurface cultural resources are discovered during ground disturbing activities, all work within 50 feet of the resources shall be halted and the project applicant shall notify the City and consult with a qualified archaeologist or paleontologist, as applicable, to assess the significance of the find. In the case of discovery of paleontological resources, the assessment shall be done in accordance with the Society of Vertebrate Paleontology standards. If any find is determined to be significant, appropriate avoidance measures recommended by the consultant and approved by the City must be followed unless avoidance is determined unnecessary or infeasible by the City. Feasibility of avoidance shall be determined with consideration of factors such as the nature of the find, project design, costs, and other considerations. If avoidance is unnecessary or infeasible, other appropriate measures (e.g., data recovery, excavation) shall be instituted. Work may proceed on other parts of the project site while measures for the cultural resources are implemented.

In the event of data recovery of archaeological resources, the project applicant shall submit an Archaeological Research Design and Treatment Plan (ARDTP) prepared by a qualified archaeologist for review and approval by the City. The ARDTP is required to identify how the proposed data recovery program would preserve the significant information the archaeological resource is expected to contain. The ARDTP shall identify the scientific/historic research questions applicable to the expected resource, the data classes the resource is expected to possess, and how the expected data classes would address the applicable research questions. The ARDTP shall include the analysis and specify the curation and storage methods. Data recovery, in general, shall be limited to the portions of the archaeological resource that could be impacted by the proposed project. Destructive data recovery methods shall not be applied to portions of the archaeological resources if nondestructive methods are practicable. Because the intent of the ARDTP is to save as much of the archaeological resource as possible, including moving the resource, if feasible, preparation and implementation of the ARDTP would reduce the potential adverse impact to less than significant. The project applicant shall implement the ARDTP at his/her expense.

In the event of excavation of paleontological resources, the project applicant shall submit an excavation plan prepared by a qualified paleontologist to the City for review and approval. All significant cultural materials recovered shall be subject to scientific analysis, professional museum curation, and/or a report prepared by a qualified paleontologist, as appropriate, according to current professional standards and at the expense of the project applicant.

When Required: During construction

Initial Approval: N/A

Monitoring/Inspection: Bureau of Building

**17. Human Remains – Discovery During Construction**

**Requirement:** Pursuant to CEQA Guidelines section 15064.5(e)(1), in the event that human skeletal remains are uncovered at the project site during construction activities, all work shall immediately halt and the project applicant shall notify the City and the Alameda County Coroner. If the County Coroner determines that an investigation of the cause of death is required or that the remains are Native American, all work shall cease within 50 feet of the remains until appropriate arrangements are made. In the event that the remains are Native American, the City shall contact the California Native American Heritage Commission (NAHC), pursuant to subdivision (c) of section 7050.5 of the California Health and Safety Code. If the agencies determine that avoidance is not feasible, then an alternative plan shall be prepared with specific steps and timeframe required to resume construction activities. Monitoring, data recovery, determination of significance, and avoidance measures (if applicable) shall be completed expeditiously and at the expense of the project applicant.

**When Required:** During construction

**Initial Approval:** N/A

**Monitoring/Inspection:** Bureau of Building

**18. Construction-Related Permit(s)**

**Requirement:** The project applicant shall obtain all required construction-related permits/approvals from the City. The project shall comply with all standards, requirements and conditions contained in construction-related codes, including but not limited to the Oakland Building Code and the Oakland Grading Regulations, to ensure structural integrity and safe construction.

**When Required:** Prior to approval of construction-related permit

**Initial Approval:** Bureau of Building

**Monitoring/Inspection:** Bureau of Building

**19. Hazardous Materials Related to Construction**

**Requirement:** The project applicant shall ensure that Best Management Practices (BMPs) are implemented by the contractor during construction to minimize potential negative effects on groundwater, soils, and human health. These shall include, at a minimum, the following:

- a. Follow manufacture's recommendations for use, storage, and disposal of chemical products used in construction;
- b. Avoid overtopping construction equipment fuel gas tanks;
- c. During routine maintenance of construction equipment, properly contain and remove grease and oils;
- d. Properly dispose of discarded containers of fuels and other chemicals;
- e. Implement lead-safe work practices and comply with all local, regional, state, and federal requirements concerning lead (for more information refer to the Alameda County Lead Poisoning Prevention Program); and
- f. If soil, groundwater, or other environmental medium with suspected contamination is encountered unexpectedly during construction activities (e.g., identified by odor or visual staining, or if any underground storage tanks, abandoned drums or other hazardous materials or wastes are encountered), the project applicant shall cease work in the vicinity of the suspect material, the area shall be secured as necessary, and the applicant shall take all appropriate measures to protect human health and the environment. Appropriate measures shall include notifying the City and applicable regulatory agency(ies) and implementation of the actions described in the City's Standard Conditions of Approval, as necessary, to identify the nature and extent of contamination. Work shall not resume in the area(s) affected until the measures have been implemented under the oversight of the City or regulatory agency, as appropriate.

When Required: During construction

Initial Approval: N/A

Monitoring/Inspection: Bureau of Building

## **20. Construction Days/Hours**

Requirement: The project applicant shall comply with the following restrictions concerning construction days and hours:

- a. Construction activities are limited to between 7:00 a.m. and 7:00 p.m. Monday through Friday, except that pier drilling and/or other extreme noise generating activities greater than 90 dBA shall be limited to between 8:00 a.m. and 4:00 p.m.
- b. Construction activities are limited to between 9:00 a.m. and 5:00 p.m. on Saturday. In residential zones and within 300 feet of a residential zone, construction activities are allowed from 9:00 a.m. to 5:00 p.m. only within the interior of the building with the doors and windows closed. No pier drilling or other extreme noise generating activities greater than 90 dBA are allowed on Saturday.
- c. No construction is allowed on Sunday or federal holidays.

Construction activities include, but are not limited to, truck idling, moving equipment (including trucks, elevators, etc.) or materials, deliveries, and construction meetings held on-site in a non-enclosed area.

Any construction activity proposed outside of the above days and hours for special activities (such as concrete pouring which may require more continuous amounts of time) shall be evaluated on a case-by-case basis by the City, with criteria including the urgency/emergency nature of the work, the proximity of residential or other sensitive uses, and a consideration of nearby residents'/occupants' preferences. The project applicant shall notify property owners and occupants located within 300 feet at least 14 calendar days prior to construction activity proposed outside of the above days/hours. When submitting a request to the City to allow construction activity outside of the above days/hours, the project applicant shall submit information concerning the type and duration of proposed construction activity and the draft public notice for City review and approval prior to distribution of the public notice.

When Required: During construction

Initial Approval: N/A

Monitoring/Inspection: Bureau of Building

## **21. Construction Noise**

Requirement: The project applicant shall implement noise reduction measures to reduce noise impacts due to construction. Noise reduction measures include, but are not limited to, the following:

- a. Equipment and trucks used for project construction shall utilize the best available noise control techniques (e.g., improved mufflers, equipment redesign, use of intake silencers, ducts, engine enclosures and acoustically-attenuating shields or shrouds) wherever feasible.
- b. Except as provided herein, impact tools (e.g., jack hammers, pavement breakers, and rock drills) used for project construction shall be hydraulically or electrically powered to avoid noise associated with compressed air exhaust from pneumatically powered tools. However, where use of pneumatic tools is unavoidable, an exhaust muffler on the compressed air exhaust shall be used; this muffler can lower noise levels from the exhaust by up to about 10 dBA. External jackets on the tools themselves shall be used, if such jackets are commercially available, and this could achieve a reduction of 5 dBA. Quieter procedures shall be used, such as drills rather than impact equipment, whenever such procedures are available and consistent with construction procedures.
- c. Applicant shall use temporary power poles instead of generators where feasible.



- d. Stationary noise sources shall be located as far from adjacent properties as possible, and they shall be muffled and enclosed within temporary sheds, incorporate insulation barriers, or use other measures as determined by the City to provide equivalent noise reduction.
- e. The noisiest phases of construction shall be limited to less than 10 days at a time. Exceptions may be allowed if the City determines an extension is necessary and all available noise reduction controls are implemented.

When Required: During construction

Initial Approval: N/A

Monitoring/Inspection: Bureau of Building

## 22. Extreme Construction Noise

### a. *Construction Noise Management Plan Required*

Requirement: Prior to any extreme noise generating construction activities (e.g., pier drilling, pile driving and other activities generating greater than 90dBA), the project applicant shall submit a Construction Noise Management Plan prepared by a qualified acoustical consultant for City review and approval that contains a set of site-specific noise attenuation measures to further reduce construction impacts associated with extreme noise generating activities. The project applicant shall implement the approved Plan during construction. Potential attenuation measures include, but are not limited to, the following:

- i. Erect temporary plywood noise barriers around the construction site, particularly along on sites adjacent to residential buildings;
- ii. Implement “quiet” pile driving technology (such as pre-drilling of piles, the use of more than one pile driver to shorten the total pile driving duration), where feasible, in consideration of geotechnical and structural requirements and conditions;
- iii. Utilize noise control blankets on the building structure as the building is erected to reduce noise emission from the site;
- iv. Evaluate the feasibility of noise control at the receivers by temporarily improving the noise reduction capability of adjacent buildings by the use of sound blankets for example and implement such measure if such measures are feasible and would noticeably reduce noise impacts; and
- v. Monitor the effectiveness of noise attenuation measures by taking noise measurements.

When Required: Prior to approval of construction-related permit

Initial Approval: Bureau of Building

Monitoring/Inspection: Bureau of Building

### b. *Public Notification Required*

Requirement: The project applicant shall notify property owners and occupants located within 300 feet of the construction activities at least 14 calendar days prior to commencing extreme noise generating activities. Prior to providing the notice, the project applicant shall submit to the City for review and approval the proposed type and duration of extreme noise generating activities and the proposed public notice. The public notice shall provide the estimated start and end dates of the extreme noise generating activities and describe noise attenuation measures to be implemented.

When Required: During construction

Initial Approval: Bureau of Building

Monitoring/Inspection: Bureau of Building

**23. Operational Noise**

Requirement: Noise levels from the project site after completion of the project (i.e., during project operation) shall comply with the performance standards of Chapter 17.120 of the Oakland Planning Code and Chapter 8.18 of the Oakland Municipal Code. If noise levels exceed these standards, the activity causing the noise shall be abated until appropriate noise reduction measures have been installed and compliance verified by the City.

When Required: Ongoing

Initial Approval: N/A

Monitoring/Inspection: Bureau of Building

**24. Construction and Demolition Waste Reduction and Recycling**

Requirement: The project applicant shall comply with the City of Oakland Construction and Demolition Waste Reduction and Recycling Ordinance (chapter 15.34 of the Oakland Municipal Code) by submitting a Construction and Demolition Waste Reduction and Recycling Plan (WRRP) for City review and approval, and shall implement the approved WRRP. Projects subject to these requirements include all new construction, renovations/alterations/modifications with construction values of \$50,000 or more (except R-3 type construction), and all demolition (including soft demolition) except demolition of type R-3 construction. The WRRP must specify the methods by which the project will divert construction and demolition debris waste from landfill disposal in accordance with current City requirements. The WRRP may be submitted electronically at [www.greenhalosystems.com](http://www.greenhalosystems.com) or manually at the City’s Green Building Resource Center. Current standards, FAQs, and forms are available on the City’s website and in the Green Building Resource Center.

When Required: Prior to approval of construction-related permit

Initial Approval: Public Works Department, Environmental Services Division

Monitoring/Inspection: Public Works Department, Environmental Services Division

**25. Underground Utilities**

Requirement: The project applicant shall place underground all new utilities serving the project and under the control of the project applicant and the City, including all new gas, electric, cable, and telephone facilities, fire alarm conduits, street light wiring, and other wiring, conduits, and similar facilities. The new facilities shall be placed underground along the project’s street frontage and from the project structures to the point of service. Utilities under the control of other agencies, such as PG&E, shall be placed underground if feasible. All utilities shall be installed in accordance with standard specifications of the serving utilities.

When Required: During construction

Initial Approval: N/A

Monitoring/Inspection: Bureau of Building

**PROJECT SPECIFIC CONDITIONS**

**26. Emissions Report**

Requirement: A RF emissions report shall be submitted to the Building Bureau indicating that the site is actually operating within the acceptable thresholds as established by the Federal government or any such agency who may be subsequently authorized to establish such standards.

Requirement: Prior to a final inspection

When Required: Prior to final building permit inspection sign-off

Initial Approval: N/A

Monitoring/Inspection: N/A

**27. Camouflage**

Requirement: The antenna, screens and related equipment shall be painted, texturized, and maintained to match the existing structure.

When Required: Prior to a final inspection

Initial Approval: N/A

Monitoring/Inspection: Bureau of Building